

U-26

RIDGE ROAD 60' R/W

N 00°00'00" W  
69.95'

The Place of Beginning

LOT #5

S 89°49'51" E 360.03'

SURVEYED FOR  
TRANSFER  
PART OF LOT #6  
25195 SQ. FT.

N 89°49'24" W 360.08'

PART OF LOT #6

S 00°02'44" E  
70.00'

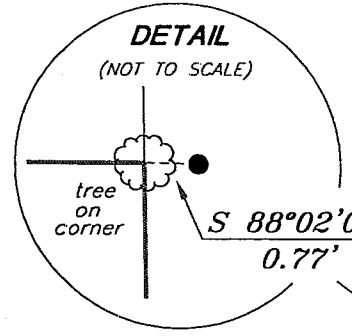

NORTH

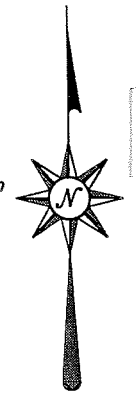

Bearings are based on an assumed meridian

Ohio-American  
Water Company  
ORV 769, P. 874

LEGEND

● IRON PIN FOUND



NEW SURVEY  
OF EXISTING PARCEL  
RICHLAND COUNTY  
TAX MAP OFFICE  
MLB 10-15-04  
INITIAL DATE

*Douglas C. Seiler*

SURVEYED BY: DOUGLAS C. SEILER PS #6869  
for SEILER & CRAIG SURVEYING INC.  
52-1/2 NORTH MAIN STREET  
MANSFIELD, OHIO 44902  
(419) 525-3644  
FAX (419) 525-3696

0' 40' 80' 120'



SCALE: 1"=40'

SURVEY PLAT FOR	
GERHART	
PART OF LOT NUMBER 6 PLEASANT VIEW RIDGE ALLOT., MADISON TWP RICHLAND COUNTY, OHIO	
DATE: OCTOBER 7, 2004	SCALE: 1"=40
150RIDGE.DWG/ASC	DRAWN BY: NBR

**SEILER & CRAIG SURVEYING, INC.**

Douglas C. Seiler, PS & Chad F. Craig, PS  
52 1/2 North Main Street  
Mansfield, Ohio 44902  
419-525-3644 Fax 419-525-3696  
www.seilerandcraig.com

**SURVEY DESCRIPTION**

PART OF LOT #6  
PLEASANT VIEW RIDGE ALLOTMENT  
MADISON TOWNSHIP, RICHLAND COUNTY, OHIO

Situated in the Township of Madison, County of Richland, State of Ohio and being known as a part of Lot #6 of the consecutively numbered lots in Pleasant View Ridge Allotment (plat reference: Volume 13, page 15), and being more particularly described as follows:

Beginning for the same at an iron pin found and accepted as marking the northwest corner of said lot; Thence, South 89 degrees 49 minutes 51 seconds East with the north line of said lot, a distance of 360.03 feet to the northeast corner thereof, as referenced by an iron pin found on a bearing of South 88 degrees 02 minutes 09 seconds East and at a distance of 0.77 feet from said corner;

Thence, South 00 degrees 02 minutes 44 seconds East with the east line of said lot, a distance of 70.00 feet to an iron pin found;

Thence, North 89 degrees 49 minutes 24 seconds West a distance of 360.08 feet to an iron pin found on the west line of said lot;

Thence, North 00 degrees 00 minutes 00 seconds West with said west line, a distance of 69.95 feet to the place of beginning, containing 25195 square feet, according to survey by Douglas C. Seiler, Professional Surveyor #6869 on October 6, 2004, for Seiler & Craig Surveying, Inc.

Bearings are based on an assumed meridian and are intended to be used for angular determination only.

NEW SURVEY  
OF EXISTING PARCEL  
RICHLAND COUNTY  
TAX MAP OFFICE

MS 10-15-04  
INITIAL DATE

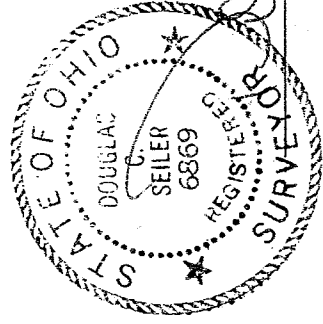

Douglas C. Seiler PS #6869  
for Seiler & Craig Surveying, Inc.

U-26