

# PLAT OF SURVEY FOR RICHARD DICKERSON

LEGEND:

- ▲ - P.K. NAIL FOUND
- △ - P.K. NAIL SET
- - RAILROAD SPIKE FOUND
- - RAILROAD SPIKE SET
- - FENCE POST FOUND
- - IRON PIN FOUND
- - IRON PIN SET - CAPPED
- - BLUNK 6320 "

SECTION 5 LOT #         
 TOWNSHIP Z3 CITY / VILLAGE         
 RANGE 17 MIFFLIN TOWNSHIP  
 QUARTER NW RICHLAND COUNTY, OHIO

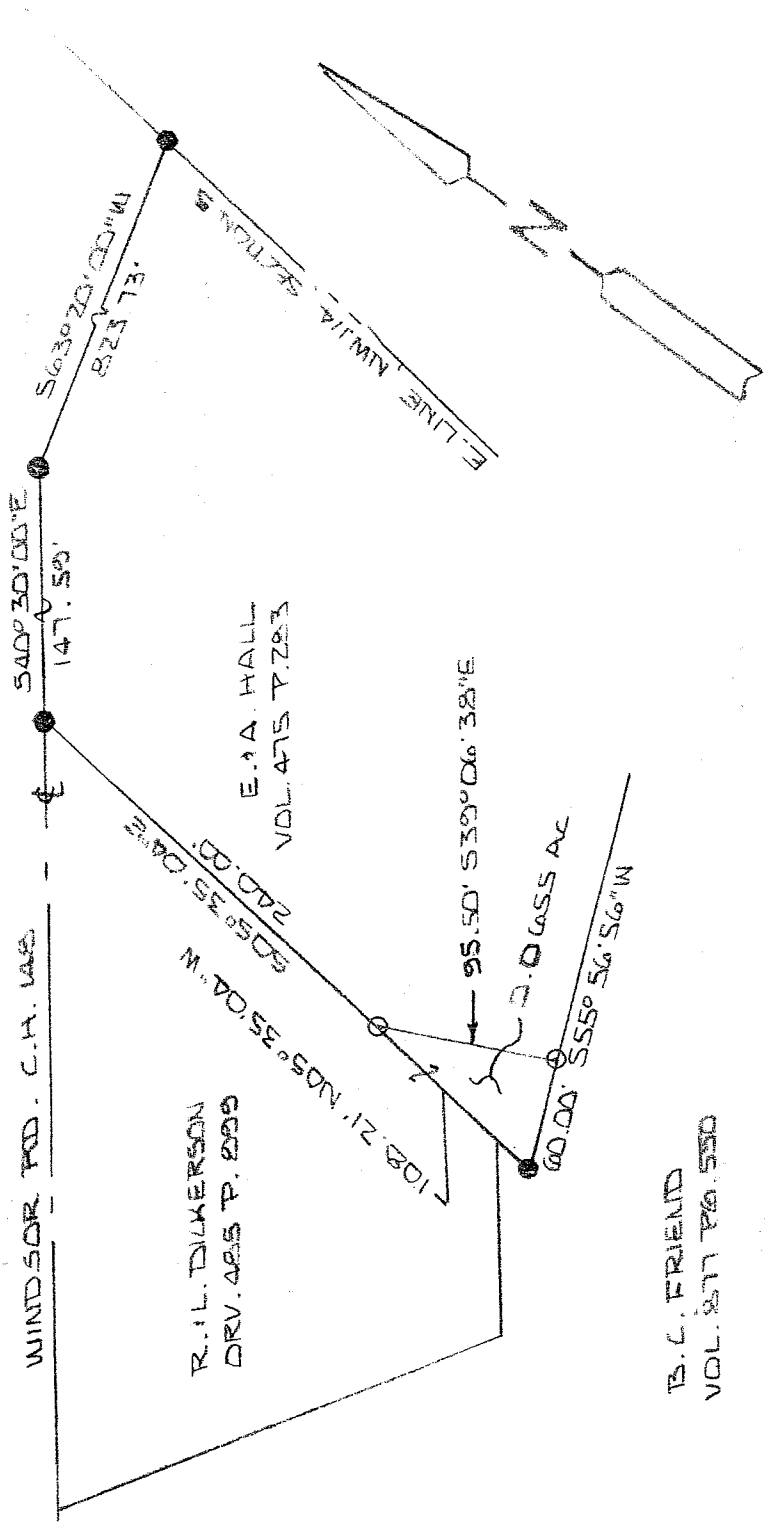

NEW SPILT  
 RICHLAND COUNTY  
 TAX MAP OFFICE  
 MUB 10-11-04  
 INITIAL DATE

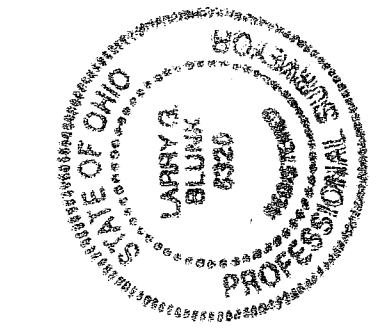

100' SCALE 1" = 100' 100'

BASIS OF BEARINGS: SURVED BY R.L. DICKERSON 1-97

I HEREBY CERTIFY THAT THE ABOVE PLAT AND THE FIELD SURVEY IT REPRESENTS ARE TRUE TO THE BEST OF MY KNOWLEDGE

*Larry G. Blunk*

LARRY G. BLUNK  
 PROFESSIONAL SURVEYOR # 6320  
 T-113

DATE

JUNE 14 2004

T-113

T-113

**DESCRIPTION  
FOR  
RICHARD DICKERSON**

Located in the Township of Mifflin, County of Richland, State of Ohio and being a part of the Northwest Quarter of Section 5, Township 23, Range 17 and more particularly described as follows:

Beginning at a railroad spike found on the east line of the Northwest Quarter of Section 5 with its intersection with the centerline of Windsor Rd. C.H. 148.

Thence S 63 degrees 20' 00" W along the centerline of Windsor Rd. C.H. 148 a distance of 823.73 feet to an iron pin found.

Thence S 40 degrees 30' 00" E along the centerline of Windsor Rd. C.H. 148 a distance of 147.59 feet to a railroad spike found.

Thence S 05 degrees 35' 04" E a distance of 240.00 feet to an iron pin set and the True Place of Beginning.

Thence S 39 degrees 06' 38" E a distance of 95.50 feet to an iron pin set.

Thence S 55 degrees 56' 56" W a distance of 60.00 feet to an iron pin found.

Thence N 05 degrees 35' 04" W a distance of 108.21 feet to the True Place of Beginning and containing 0.0655 acres more or less but subject to all legal highways also all easements of record.

Grantees, their heirs and assigns do hereby covenant and agree that the parcel of land described in this instrument will not be conveyed by said grantee, heirs and assigns unless said parcel fronts on a public highway or dedicated street or is sold together with land fronting on a public highway or dedicated street.

Basis of Bearings: Survey by R.L. Stevens, 1-97.

*Larry G. Blunk*  
Larry G. Blunk, P.S. 6320  
June 6, 2004

NEW SPLIT  
RICHLAND COUNTY  
TAX MAP OFFICE  
MB 6-11-04  
INITIAL DATE

