

T-57

SURVEY FOR SALEM CHURCH

G. & V. BASSLER
O.R.V.-1046 P.-183

McCUEN ROAD (T.H. 384)(40')
S 89°40'00" E

N. LINE SW. 1/4 SEC. 35

TRUSTEES OF SALEM EVANGELICAL
UNITED BRETHREN CHURCH
D.V.-491 P.-584
(0.317 ACRES)

EVANGELICAL
ASSOCIATION
D.V.-49 P.-167
(0.14 ACRES)

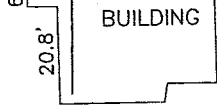

0.970 ACRES

JOHN E. ,JR. & DEBRA S. HECHT, JR.
D.V.-889 P.-175

234.93'
N 89°45'27" W

S 01°31'42" E

115'

227.42'

10.87'

20.02'

182.72'

S 02°01'23" E

NE CORNER SW. 1/4 SEC. 35

E. LINE SW. 1/4 SEC. 35

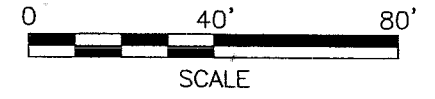
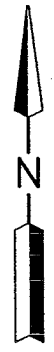

LEGEND

- IRON PIN FOUND
- IRON PIN SET, 5/8" DIA. ROD WITH PLASTIC CAP STAMPED "STEVENS 7052"

JOSEPH F. & SHERRY K. BELCHER
O.R.V.-240 P.-845

NEW SPLIT
RICHLAND COUNTY
TAX MAP OFFICE
EAK 5-17-04
INITIAL DATE

PART OF THE SW. 1/4 OF
SEC. 35, T-21, R-17,
WORTHINGTON TWP.,
RICHLAND CO., OHIO.

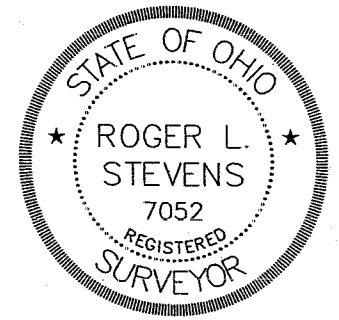

Roger L. Stevens

Roger L. Stevens, P.S. #7052 Date 4-29-04 SM-1736

Distances shown hereon are expressed in feet and decimal parts thereof, bearings are to an assumed meridian and are used to express angles only.

CERTIFICATION: I hereby certify that the foregoing survey was prepared from actual field measurements, in accordance with Chapter 4733-37, Ohio Administration Code.

T-57

**SURVEYOR'S DESCRIPTION FOR
SALEM CHURCH**

0.970 Acres

Situated in the Township of Worthington, County of Richland, State of Ohio and being part of the Southwest Quarter of Section 35, Township 21, Range 17 and being more particularly described as follows:

Commencing at a point being the northeast corner of said Southwest Quarter, said point being in the centerline of McCuen Road (T.H. 384) and being referenced by an iron pin found N 01° 31' 42" W, 22.08 feet from said point;

Thence N 89° 40' 00" W, 10.87 feet along the north line of said Southwest Quarter also being along said centerline of McCuen Road to a point being the **true place of beginning**;

Thence S 02° 01' 23" E, 182.72 feet to an iron pin set and passing through an iron pin set at 20.02 feet;

Thence N 89° 45' 27" W, 234.93 feet to an iron pin set;

Thence N 00° 20' 00" E, 182.93 feet to a point being in the north line of said Southwest Quarter also being in said centerline of McCuen Road and passing through an iron pin set at 162.93 feet;

Thence S 89° 40' 00" E, 227.42 feet along the north line of said Southwest Quarter also being along said centerline of McCuen Road to the **true place of beginning**, and containing **0.970 acre**, more or less, and subject to all legal highways and easements of record.

Bearings are to an assumed meridian and are used to express angles only.

All iron pins are 5/8" diameter reinforcing rod with plastic cap stamped "STEVENS 7052".

According to a survey made in April 2004 by Roger L. Stevens, Ohio Registered Surveyor No. 7052.



Roger L. Stevens
Roger L. Stevens
Registered Surveyor No. 7052
SM-1736C7

NEW SPLIT
RICHLAND COUNTY
TAX MAP OFFICE
INITIAL DATA
PAK 5/7/04

T-57