

E. LINE N.E. 1/4, SEC. 3  
 W. LINE N.W. 1/4, SEC. 2  
 P.O.C. - N.W. CORNER S.W. QUARTER SECTION 2 WATER PIPE FD.

MANSFIELD RACEWAY LLC  
 O.R.V. 2352 P.218

MANSFIELD RACEWAY LLC  
 O.R.V. 2352 P.218  
 (47.984 AC.)  
 42,984 AC.

1177.49'  
 N 88°45'32" E 1203.07' FD.  
 1205.00' D.

HOOVER ROAD (T.H. 288)

S. LINE N.W. 1/4 SEC. 2  
 N. LINE S.W. 1/4 SEC. 2  
 1493.27' D. USED  
 2596.35'

N.E. CORNER S.W. SECTION 2 RR SPIKE FD.

CURVE C1  
 L=187.06'  
 R=750.00'  
 A=147°25'  
 C=186.58'  
 C.B.=S 05°24'12" E



BEARINGS ARE BASED ON THE OHIO STATE PLANE COORDINATE SYSTEM, NAD83(2011), NORTH ZONE, ORIGINATING ON THE ODOT CORRS VRS NETWORK.

**LEGEND**

- SURVEY MARKER SET - 5/8" DIA. x 30" REBAR SET WITH PLASTIC CAP STAMPED "RICHLAND ENG. RLS 7375".
- ◆ 2" MAG NAIL SET
- IRON PIN/PIPE FOUND
- ⊙ RAILROAD SPIKE FOUND
- ⊕ SURVEY MARKER FOUND - 5/8" DIA. x 30" REBAR WITH PLASTIC CAP STAMPED "RICHLAND ENG. RLS 7209".
- D. DEED
- FD. FOUND
- CORPORATION LINE

**VERBAL APPROVAL BY WAYNE LIGGETT MADISON ZONING INSPECTOR 2-11-22**  
**00-37**

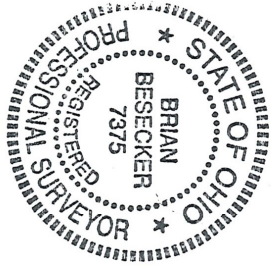

*Brian Besecker*  
 BRIAN BESECKER  
 PROFESSIONAL LAND SURVEYOR NO. 7375  
 DATE 2-11-22

5,000 ACRE SURVEY FOR  
**MANSFIELD MOTORSPORTS SPEEDWAY, LLC**

SITUATED IN THE TOWNSHIP OF MADISON, COUNTY OF RICHLAND, STATE OF OHIO, BEING A PART OF THE SOUTHWEST QUARTER OF SECTION 2, TOWNSHIP 21, RANGE 18.

**PEL RICHLAND ENGINEERING LIMITED**  
 A WALLACEPANCHER GROUP COMPANY  
 29 NORTH PARK STREET MANSFIELD, OHIO

**Description**  
**5.000 Acre Parcel**

Situated in the Township of Madison, County of Richland, State of Ohio and being a part of the Southwest Quarter of Section 2, Township 21, Range 18 and being further described as follows:

Commencing at a 1" water pipe found at the northwest corner of the Southwest Quarter of Section 2;

Thence North 88 Degrees 45 Minutes 32 Seconds East along the north line of the Southwest Quarter of Section 2, passing thru a survey marker found at a distance of 1177.49 feet, a total distance of 1203.07 feet to a 2 inch MAG nail set;

Thence South 12 Degrees 32 Minutes 55 Seconds East along the centerline of State Route 545, a distance of 408.89 feet to a 2 inch MAG nail set at the **Point of Beginning** of the parcel herein described;

1. Thence continuing along the centerline of State Route 545, along a curve to the right with an arc **length of 187.06 feet, a radius of 750.00 feet, a delta angle of 14 Degrees 17 Minutes 25 Seconds, a chord bearing South 05 Degrees 24 Minutes 12 Seconds East, with a chord length of 186.58 feet**, to a 2 inch MAG nail set;
2. Thence **South 01 Degrees 44 Minutes 30 Seconds West** a distance of **493.15 feet** to a 2 inch MAG nail set;
3. Thence **North 88 Degrees 15 Minutes 38 Seconds West**, passing thru a survey marker set at a distance of **25.00 feet**, a total distance of **323.18 feet** to a survey marker set;
4. Thence **North 01 Degrees 44 Minutes 22 Seconds East** a distance of **678.28 feet** to a survey marker set;
5. Thence **South 88 Degrees 15 Minutes 38 Seconds East** passing thru a survey marker set at a distance of **274.20 feet**, a total distance of **300.00 feet** to the 2 inch MAG nail set at the **Point of Beginning**, containing **5.000 acres** of land, more or less, subject to all highways, easements and use restrictions of record.

This description is based upon an actual field survey. Bearings are based on the Ohio State Plane Coordinate System, NAD 83(2011), North Zone.

Survey marker set indicates a 5/8" x 30" rebar with plastic cap set stamped "Richland Eng. RLS 7375".

Survey marker found indicates a 5/8" x 30" rebar with plastic cap set stamped "Richland Eng. RLS 7209".

Deed Reference: Official Record Volume 2352, Page 218.



*Brian Besecker* 9 Feb. 2022

Brian Besecker                      Date  
Professional Land Surveyor No. 7375

NEW SPLIT  
RICHLAND COUNTY  
TAX MAP OFFICE  
EAK    2-11-22  
INITIAL                      DATE  
**00-37**