

0-190

NORTH

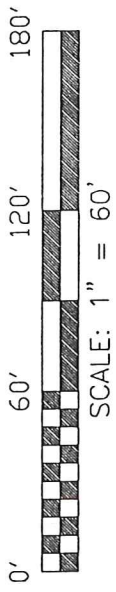

REPLACED BY
F-3-60

W. & M. KINSEL
O.R.V. 589, PAGE 337

THE EAST LINE OF
THE NE QTR. SEC. 29

W. & M. KINSEL
O.R.V. 956, PAGE 458

N 89°25'44" W 189.65'

S 00°00'00" W 114.85'

0.50 ACRE

N 00°00'00" E 114.85'

W. & M. KINSEL
O.R.V. 956, PAGE 458

S 89°25'44" E 189.65'

THE PLACE OF
BEGINNING

K. E. DYER
O.R.V. 126, PAGE 5

K. E. DYER
O.R.V. 126, PAGE 5

THE SE CORNER OF
THE NE QTR. SEC. 29

BEARINGS ARE BASED ON
AN ASSUMED MERIDIAN

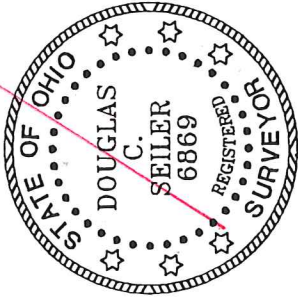

- ⊙ IRON PIPE FOUND
- IRON PIN FOUND
- ⊗ IRON PIN SET WITH CAP STAMPED "SEILER 6869"

NEW SPLIT
RICHLAND COUNTY
TAX MAP OFFICE
DATE 10-31-01
INITIAL

Douglas C. Seiler 10/27/01

SURVEYED BY:
DOUGLAS C. SEILER
PROFESSIONAL SURVEYOR #6869
52-1/2 NORTH MAIN STREET
MANSFIELD, OHIO 44902
(419) 525-3644
FAX (419) 525-3696

SURVEY PLAT FOR

KINSEL

PART NE QTR. SEC. 29, T-23, R-18
BLOOMINGGROVE TOWNSHIP
RICHLAND COUNTY, OHIO

DATE: OCTOBER 26, 2001 SCALE: 1"=60'

0-190

Douglas C. Seiler

Professional Land Surveyor

52½ North Main • Mansfield, Ohio 44902
(419) 525-3644 • FAX (419) 525-3696

SURVEY DESCRIPTION

PART NE QUARTER SECTION 29
BLOOMINGGROVE TOWNSHIP
RICHLAND COUNTY, OHIO

Situated in the Township of Bloominggrove, County of Richland, State of Ohio and being a part of the Northeast Quarter of Section 29, Township 23 North, Range 18 West, more particularly described as follows:

Commencing at an iron pipe found and accepted as marking the southeast corner of said quarter; Thence, North 00 degrees 00 minutes 00 seconds East with the east line of said quarter, a distance of 181.50 feet to an iron pin set marking the northeast corner of a parcel currently owned by K. E. Dyer (deed reference: ORV 126, page 5), said iron pin being the place of beginning of the parcel herein described;

Thence, continuing North 00 degrees 00 minutes 00 seconds East with said east line, a distance of 114.85 feet to an iron pin found;

Thence, North 89 degrees 25 minute 44 seconds West, a distance of 189.65 feet to an iron pin set;

Thence, South 00 degrees 00 minutes 00 seconds West a distance of 114.85 feet to an iron pin set on the north line of said Dyer parcel;

Thence, South 89 degrees 25 minutes 44 seconds East with said north line, a distance of 189.65 feet to the place of beginning, containing 0.50 of an acre, according to survey by Douglas C. Seiler, Professional Surveyor #6869 on October 26, 2001.

The grantee, his heirs and assigns do hereby covenant and agree that the parcel of land described by this instrument will not be transferred by said grantee, heirs, or assigns independently from a contiguous parcel of land without the approval of the Richland County Regional Planning Commission.

Iron pins set are 5/8" rods with caps stamped "SEILER 6869".

Bearings are based on an assumed meridian and are intended to be used for angular determination only.

REPLACED BY
F-3-60

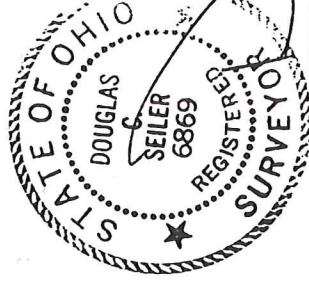

Douglas C. Seiler
Professional Surveyor #6869

NEW SPLIT
RICHLAND COUNTY
TAX/MAP OFFICE

INITIAL JS DATE 10-31-01

0-190

0-190