

RESURVEY OF EXISTING PARCEL

NOTE - ALL PINS MARKED SET ARE 3/4" REBAR X 30"

25.20' S 86° 12' 57" E 250.00'

S 45° 09' 11" W 39.97'



KL & C.T. OCHEL TREE ORV-685, PG-281

Total Area 2.5733 Ac.

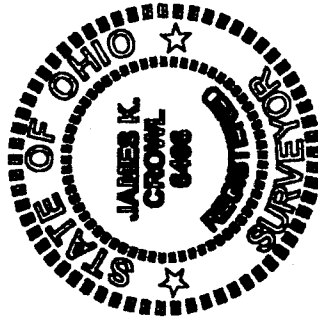

James K. Crowl
James K. Crowl
P.S. #6496

NEW SURVEY OF EXISTING PARCEL OF RICHLAND COUNTY, OHIO TAX MAP OFFICE

DATE 10-15-01

N 03° 28' 42" W 452.00'

D. SAUDER V-835/ PG-95

N 86° 12' 57" W 250.00'

SEE DETAIL 1

S 03° 28' 42" E 452.00' HARLAN RD. (CH-293) EAST LINE NE 1/4, SEC-22, MIFFLIN TWP.

E.C. LESS THAN 1:10,000

NOTE - ALL BEATINGS ARE ASSUMED FOR PURPOSES OF THIS SURVEY.

- LEGEND**
- - IRON PIN FOUND
 - - IRON PIN SET W/ PLASTIC CAP "J CROWL 6496"
 - △ - RAILROAD SPIKE SET
 - ⊗ - PK NAIL SET

James K. Crowl, P.E., P.S.
P.O. Box 8601
747 South Home Road
Mansfield, Ohio 44906
(419) 529-9747

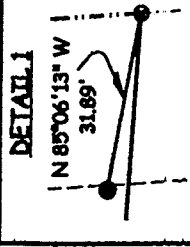

Plat of Survey for J. Hofer

Part of NE 1/4, Sec-21, Twp-21, Rng-17, Mifflin Twp., Richland County, Oh.

Sheet 1/1 October 11, 2001

0-160

0-160

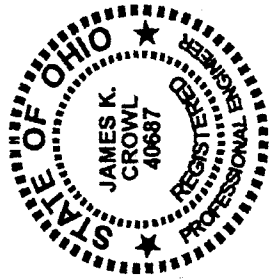

James K. Crowl, P.E., P.S.
P.O. Box 8601
747 South Home Road
Mansfield, Ohio 44906
(Voice) 419-529-9747
(FAX) 419-529-9747

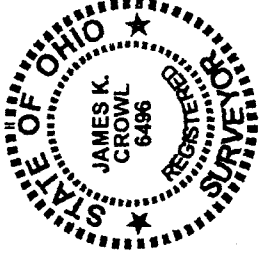

Description

Being a part of the NE $\frac{1}{4}$, Section 21, Twp-21, Rng-17, Mifflin Township, Richland County, Ohio and more particularly described as follows;

Beginning at a railroad spike set at the intersection of the centerline of SR-430 and the east line of the Section and Quarter referenced above, said point also being on the centerline of Harlan Road (CH-293), said point referenced by an iron pin set S 45° 09' 11" W at a distance of 39.97 feet;

Thence S 03° 28' 42" E a distance of 452.00 feet along and with the east line of the Quarter and Section referenced above and the centerline of Harlan Road (CH-293) to a PK nail set, said point referenced by an iron pin found N 85° 06' 13" W at a distance of 31.89 feet;

Thence N 86° 12' 57" W a distance of 250.00 feet to an iron pin found;

Thence N 03° 28' 42" W a distance of 452.00 feet to a PK nail set on the centerline of SR-430, said point referenced by an iron pin set S 03° 28' 42" E at a distance of 25.20 feet;

Thence S 86° 12' 57" E along and with the centerline of SR-430 a distance of 250.00 feet to the Place of Beginning and containing 2.5733 acres, more or less, but subject to all highways and easements of record.

This description was prepared from a field survey performed by James K. Crowl, P.S. 6496, on October 11, 2001, The bearings referred to herein are based on an assumed meridian and are for purposes of angular measurement only. The iron pins set are 3/4" diameter rebar with identification caps stamped "JKC 6496".

NEW SURVEY
OF EXISTING PARCEL
RICHLAND COUNTY
TAX MAP OFFICE
INITIALS DATE
JKC 10/15/01

0-160