

0-158

0-158

### SURVEY FOR GEORGE F., JR. & JANE C. FLEINER

THE CRESTLINE WALTON LAKE CLUB  
D.V.-498 P.-42

S 85°03'44" E 880.00'  
N. LINE NW. 1/4 SEC. 19

SHED  
(NO FOUNDATION)

S 85°03'44" E  
186.61'M.  
190'D.

N 05°35'52" E  
5.49'  
IP. FD. (MOVED  
FROM ORIGINAL  
LOCATION)

JONNA L. & CHARLES A. JENNINGS  
O.R.V.-365 P.-332

GEORGE F., JR. & JANE C. FLEINER  
D.V.-797 P.-793

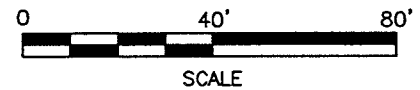

L=106.81'  
R=716.20'  
Δ=08°32'41"  
C LEN=106.71'  
BRG=S 80°03'52" E

**0.689 ACRES**  
0.704 ACRES D.

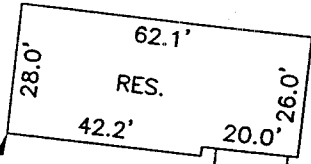

TIMOTHY A. SCOTT  
O.R.V.-488 P.-358

NEW SURVEY  
OF EXISTING PARCEL  
RICHLAND COUNTY  
TAX MAP OFFICE

EAK 10-12-01  
INITIAL DATE

#### LEGEND

- M. MEASURED
- D. DEED
- O IRON PIN FOUND
- CONCRETE R/W MONUMENT FOUND
- IRON PIN SET, 5/8" DIA. ROD WITH PLASTIC CAP STAMPED "STEVENS 7052"

L=80.69'  
R=716.20'  
Δ=06°27'19"  
C LEN=80.65'  
BRG=N 72°33'52" W



*Roger L. Stevens*  
Roger L. Stevens, P.S. #7052 Date 10-9-01 SM-1205

J. & E. BILLHEIMER  
D.V.-847 P.-785

STATE OF OHIO  
O.R.V.-840 P.-134

Distances shown hereon are expressed in feet and decimal parts thereof, bearings are to an assumed meridian and are used to express angles only.

CERTIFICATION: I hereby certify that the foregoing survey was prepared from actual field measurements, in accordance with Chapter 4733-37, Ohio Administration Code.

PART OF THE NW. 1/4 OF  
SEC. 19, T-21, R-19,  
SPRINGFIELD TWP.,  
RICHLAND CO., OHIO.

Roger L. Stevens

October 9, 2001

**SURVEYOR'S DESCRIPTION FOR  
GEOEGE F., JR. & JANE C. FLEINER**

**0.689 Acres**

Situated in the Township of Springfield, County of Richland, State of Ohio and being part of the Northwest Quarter of Section 19, Township 21, Range 19 and being more particularly described as follows:

Commencing at an iron pin found in the northwest corner of said Northwest Quarter, said iron pin also being in the northwest corner of a parcel of land conveyed to Jonna L. and Charles A. Jennings by official records volume 365, page 332;

Thence S 85° 03' 44" E, 880.00 feet along the north line of said Northwest Quarter also being along the north line of said land of Jonna L. and Charles A. Jennings to an iron pin set in the northeast corner of said land, said iron pin also being the true place of beginning;

Thence S 85° 03' 44" E, 186.61 feet and continuing along said north line of said Northwest Quarter to an iron pin set in the northwest corner of a parcel of land conveyed to Timothy A. Scott by official records volume 488, page 358;

Thence S 04° 14' 27" W, 186.78 feet along the west line of said land of Timothy A. Scott to a point being in the southwest corner of said land, said point also being in the centerline of S.R. 181 and passing through an iron pin found at 154.59 feet;

Thence N 69° 20' 13" W, 111.74 feet along said centerline of S.R. 181 to a point of curve, said point being referenced by a concrete monument found S 20° 10' 40" W, 29.90 feet;

Thence northerly and continuing along said centerline of S.R. 181 on a curve to the left having a radius of 716.20 feet, an arc length of 80.69 feet, a chord length of 80.65 feet and a chord bearing of N 72° 33' 52" W to a point being the southeast corner of said land of Jonna L. and Charles A. Jennings;

Thence N 03° 52' 12" E, 139.05 feet along the east line of said land of Jonna L. and Charles A. Jennings to the true place of beginning, passing through an iron pin set at 30.47 feet and containing 0.689 acres, more or less, and subject to all legal highways and easements of record.

Bearings are to an assumed meridian and are used to express angles only.

All iron pins set are 5/8" diameter reinforcing rod with plastic cap stamped "STEVENS 7052".

According to a survey made in October 2001 by Roger L. Stevens, Ohio Registered Surveyor No. 7052.



*Roger L. Stevens*  
Roger L. Stevens  
Registered Surveyor No. 7052  
SM-1205B

NEW SURVEY  
OF EXISTING PARCEL  
RICHLAND COUNTY  
TAX MAP OFFICE  
EAL INITIAL 10-12-01  
DATE

0-158