



SCALE: 1" = 50'

BEARINGS ARE BASED ON SURVEY D-324 ON FILE AT THE RICHLAND COUNTY TAX MAP OFFICE AND ARE INTENDED TO BE USED FOR ANGULAR DETERMINATION ONLY

PARK AVENUE WEST 60' R/W

NORTH



P.O.B.

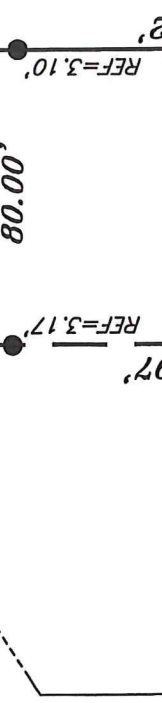

N 00°13'34" W 189.97' REF=3.17'

S 00°19'03" E 190.02' REF=3.10'

PART LOT #346
15,225 SQ. FT.

PART LOT #346



PART LOT #345



PART LOT #346

97.70'

CRESTON ROAD 60' R/W

NEW SURVEY
OF EXISTING PARCEL
RICHLAND COUNTY
TAX MAP OFFICE

EAJ 11-24-20
INITIAL DATE
MM-372



PART LOT #346

100.72'

LEGEND

- IRON PIN FOUND
- ⊕ 2" MAG NAIL SPIKE SET
- ⊗ 3" SURVEY MARKER SET
- △ RAILROAD SPIKE SET
- ▲ RAILROAD SPIKE FOUND
- ⊗ 5/8" IRON PIN SET WITH CAP STAMPED "CRAIG 8195"

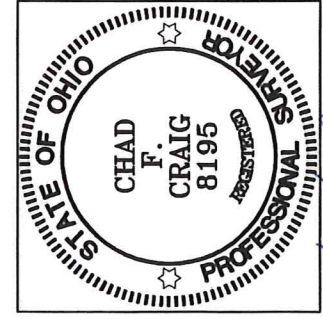

Chad F. Craig

SURVEY BY:
CHAD F. CRAIG P.S. #8195
for SEILER & CRAIG SURVEYING INC.
270 PARK AVENUE WEST
MANSFIELD, OHIO 44902
(419) 525-3644
EMAIL:SEILERANDCRAIG@SEILERANDCRAIG.COM

SURVEY PLAT FOR
PROPERTY TRANSFER
PART LOT #346 CITY OF ONTARIO RICHLAND COUNTY, OHIO
DATE: NOVEMBER 12, 2020 SCALE: 1"=50'
PAW_2051

SURVEY DESCRIPTION

PART LOT #346
CITY OF ONTARIO
RICHLAND COUNTY, OHIO

Situated in the City of Ontario, County of Richland, State of Ohio and being known as part Lot #346 of the consecutively numbered lots in said city, and being more particularly described as follows:

Beginning for the same at a point marking the northeast corner of Lot #346 and being referenced by an iron pin found on a bearing of South 00 degrees 19 minutes 03 seconds East and at a distance of 3.10 feet, Thence, South 00 degrees 19 minutes 03 seconds East with the east line of said lot and passing through said iron pin found, a total distance of 190.02 feet to an iron pin found;

Thence, North 89 degrees 06 minutes 25 seconds West a distance of 80.30 feet to a point referenced by an iron pin found on a bearing of North 00 degrees 13 minutes 34 seconds West and at a distance of 3.34 feet;

Thence, North 00 degrees 13 minutes 34 seconds West passing through said iron pin found and passing through an iron pin found at a distance of 186.80 feet, a total distance of 189.97 feet to a point on the north line of said lot;

Thence, South 89 degrees 08 minutes 17 seconds East with said north line 80.00 feet to the place of beginning, containing 15,225 square feet according to survey by Chad F. Craig P.S. 8195 on November 12, 2020 but subject to all legal highways and easements of record.

Bearings are based on Survey D-324 on file at the Richland County Tax Map Office and are intended to be used for angular determination only.

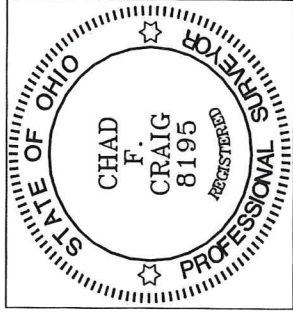

NEW SURVEY
OF EXISTING PARCEL
RICHLAND COUNTY
TAX MAP OFFICE

EAK 11-24-20
INITIAL DATE
MM-372

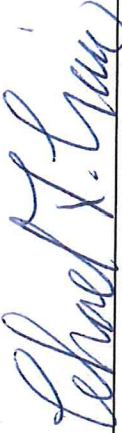
Chad F. Craig P.S. #8195
Seiler and Craig Surveying, Inc.