

SURVEY FOR: LUKE & BRITNEY WITTMER

DATE: 10-14-20

JOB NUMBER: EM-1309Z

LOCATION: LOT 292 & PART OF LOT 281,
VILLAGE OF BELLVILLE,
TOWNSHIP OF JEFFERSON,
RICHLAND CO., STATE OF OHIO.

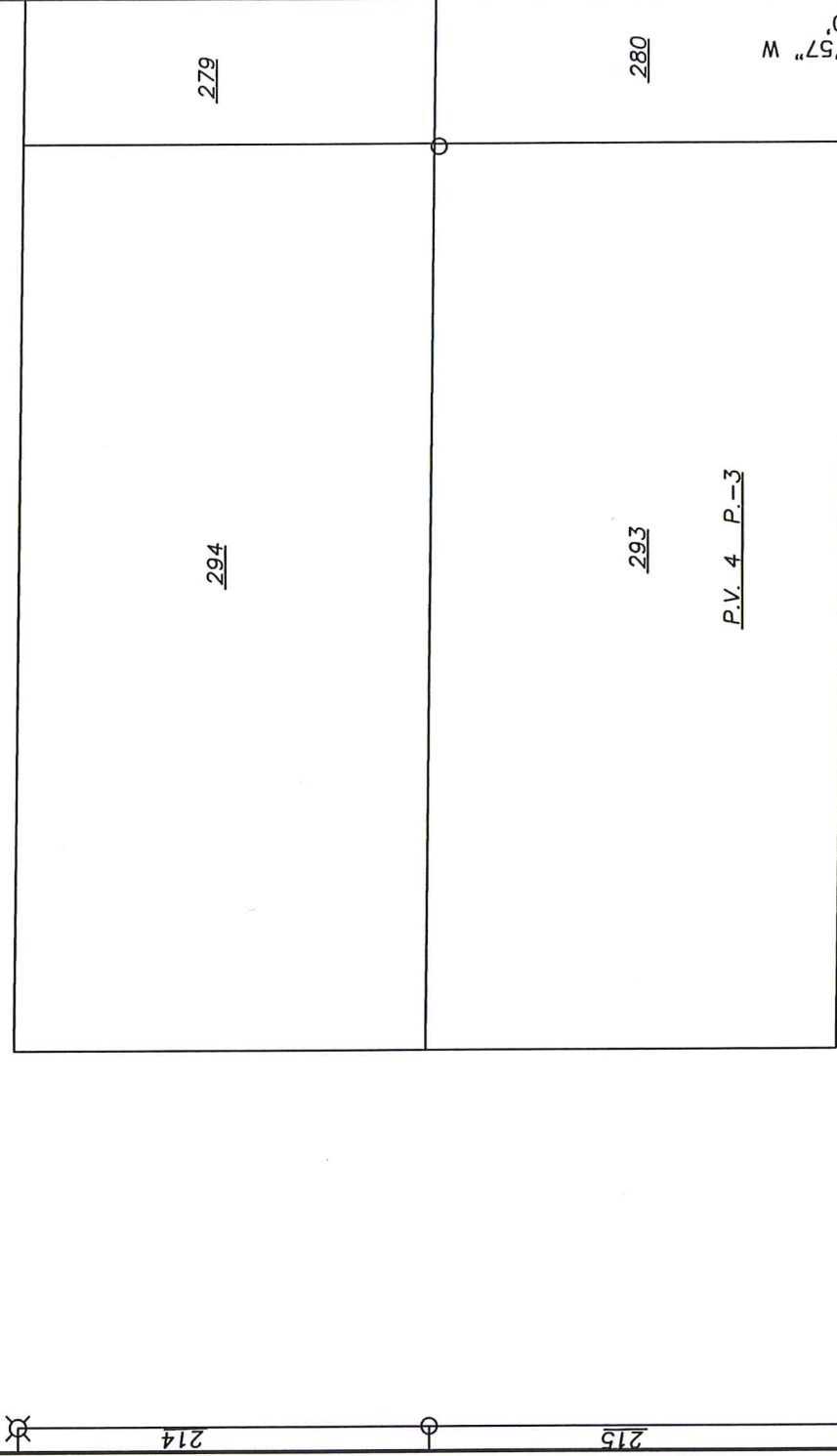

MARKERY STREET (60')

16.5' ALLEY

S 87°11'03" E 154.18'

145.13'

9692 Sq. Feet

LUKE C. & BRITNEY L. WITTMER
O.R.V.-2618 P.-727

292

(9507 Sq. Feet)

N 87°11'03" W
145.13'

291

N 87°11'03" W
9.00'

PT. 281

9.00'

(185 Sq. Feet)

S 02°10'57" W
45.00'

145.13'

N 87°11'03" W

282

PT. 281

S 02°10'57" W

45.00'

TERRI S. SCHAEFFER
O.R.V.-2354 P.-752



SCALE 1"=30'

NEW SURVEY
OF EXISTING PARCEL
RICHLAND COUNTY
TAX MAP OFFICE

EAK 10-20-20
INITIAL DATE
MM-328

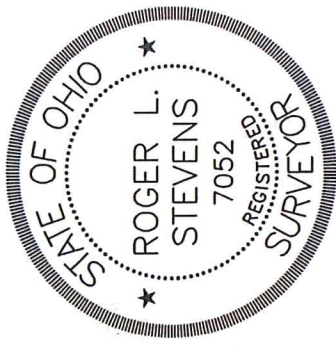

LEGEND

- IRON PIN FOUND
- ⊗ DRILL HOLE FOUND IN CONCRETE
- IRON PIN SET, 5/8" DIA, ROD WITH PLASTIC CAP STAMPED "STEVENS 7052"

Roger L. Stevens
Roger L. Stevens, P.S. #7052

Distances shown hereon are expressed in feet and decimal parts thereof, bearings are to an assumed meridian and are used to express angles only.

CERTIFICATION: I hereby certify that the foregoing survey was prepared from actual field measurements, in accordance with Chapter 4733-37, Ohio Administrative Code and is correct to the best of my knowledge.

**SURVEYOR'S DESCRIPTION FOR
LUKE & BRITTNEY WITTMER**

Situated in the Village of Bellville, County of Richland, State of Ohio, being all of Lot 292 and part of Lot 281 of the consecutively numbered Lots in said Village as shown on plat volume 4, page 3 and being more particularly described as follows:

Beginning at an iron pin set in the southwest corner of said Lot 292, said iron pin also being in the east right of way line of Markey Street (60');

Thence with the following **SIX** courses:

- 1) **N 02° 08' 13" E, 65.50 feet** along the west line of said Lot 292 also being along said east right of way line of Markey Street (60') to an iron pin set in the northwest corner of said Lot, said iron pin also being in the south right of way line of an Alley (16.5');
- 2) **S 87° 11' 03" E, 154.18 feet** along the north line of said Lot 292 and along the north line of said Lot 281 also being along said south right of way line of said Alley (16.5') to an iron pin set in a northwest corner of a parcel of land conveyed to Teri S. Schaefer by official records volume 2354, page 752;
- 3) **S 02° 10' 57" W, 20.50 feet** along a west line of said land of Teri S. Schaefer to an iron pin set in an interior corner of said land;
- 4) **N 87° 11' 03" W, 9.00 feet** along a north line of said land of Teri S. Schaefer to a point being a northwest corner of said land, said point being in the east line of said Lot 292 and being referenced by an iron pin set S 87° 11' 03" E, 9.00 feet from said point;
- 5) **S 02° 10' 57" W, 45.00 feet** along said east line of said Lot 292 to an iron pin set in the southeast corner of said Lot;
- 6) **N 87° 11' 03" W, 145.13 feet** along the south line of said Lot 292 to the **place of beginning** and containing **9,692 square feet**, more or less, of which 9507 square feet are in Lot 292 and 185 square feet are in part of Lot 281 and subject to all legal highways and easements of record.

Bearings are to an assumed meridian and are used to express angles only.

All iron pins set are 5/8" reinforcing bar with plastic cap stamped "Stevens 7052".

According to a survey made in October 2020 by Roger L. Stevens, Ohio Registered Surveyor No. 7052.



Roger L. Stevens

Roger L. Stevens
Registered Surveyor No. 7052
EM-1309U

NEW SURVEY
OF EXISTING PARCEL
RICHLAND COUNTY
TAX MAP OFFICE

EAK INITIAL **10-20-20** DATE
MM-328