

BASIS OF BEARINGS:
SURVEY INDEX "F-3-376

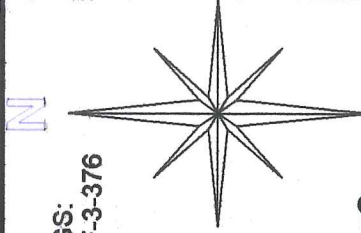

S 83°50'9" E 1328.39' N. LINE S. E. 1/4 SEC. 35

J. & B. FINNEGAN LLC
ORV 1921 PG. 207
2.31 AC.
S 7°27'49" W 245.96'

26.699 ACRES

P.O.B. N. W. COR. S. E. 1/4 SEC. 35

S 83°50'9" E 1328.39'

N 59°55'13" W 143.99'

2.68 AC.

S 28°23'42" W 772.02'

N 63°04'11" W 156.34'
S 31°37'21" W 148.22'
N 81°48'25" W 572.24'

S 49°28'23" W 59.42'

JOE & JANEEN KELLER LLC
74.221 AC.
ORV 2254 PG. 328

WEST LINE S. E. 1/4 SEC. 35
N 7°30'14" E 1998.78'
S 7°30'14" W 997.07'

DALE & LINDA SCHROEDER FARMS, LLC 29.92 AC. ORV 2192 PG. 203

B. H. KNOWLTON & A. M. MOYER
4.00 AC.
ORV 2722 PG. 649

N 82°38'3" W 1.94 AC.
ORV 2732 PG. 186

C. S. X. TRANSPORTATION, INC.

NEW SPLIT
RICHLAND COUNTY
TAX MAP OFFICE
EAK 6-23-20
INITIAL DATE
MM-17L

SOUTHEAST QUARTER
SECTION 35 T-21 R-20
SHARON TOWNSHIP
RICHLAND COUNTY, OHIO

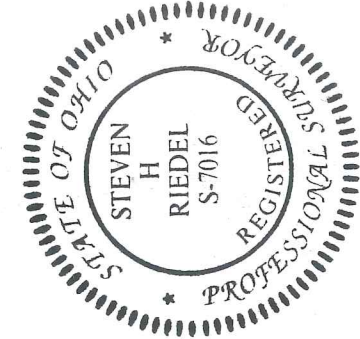

LEGEND:
○- 5/8 INCH REBAR W/CAP STAMPED "PS 7016" SET
●- EXISTING IRON PIN
▲- EXISTING RAILROAD SPIKE

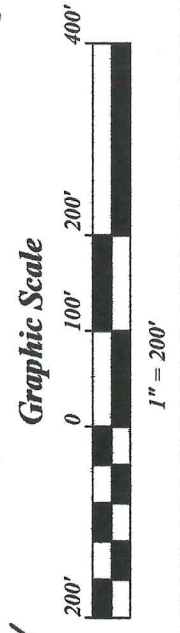
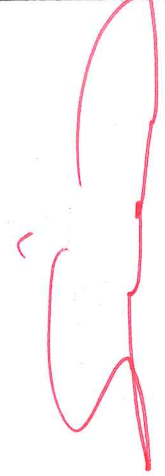

STEVEN H. RIEDEL
OHIO SURVEYOR 7016
JUNE 08, 2020
RSH35SEC

C/L C. H. 52 HOOK ROAD
SOUTH LINE SEC. 35

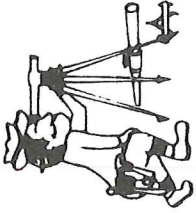

Riedel Land Surveying Company

712 N. Henry St.
Crestline, Ohio 44827

Phone (419) 683-1951

June 12, 2020

Keller Property
26.699 acres
Rsh35sed

Situated in the Township of Sharon, County of Richland, State of Ohio and being part of the Southeast quarter of Section 35, Township 21, Range 20 and being more fully described as follows:

BEGINNING at the Northwest corner of the Southeast quarter of Section 35 (a 5/8 inch rebar set North 07 deg. 30 min. 14 sec. East and 3.39 feet from this point);

Thence running South 83 deg. 50 min. 09 sec. East along the North line of the Southeast quarter of Section 35 for 1328.39 feet to an existing iron pin;

Thence turning and running South 07 deg. 27 min. 49 sec. West for 245.96 feet to an existing iron pin;

Thence turning and running North 59 deg. 55 min. 13 sec. West for 143.99 feet to a 5/8 inch rebar set;

Thence turning and running South 28 deg. 23 min. 42 sec. West for 772.02 feet to a 5/8 inch rebar set;

Thence turning and running South 49 deg. 28 min. 23 sec. West for 59.42 feet to a 5/8 inch rebar set;

Thence turning and running North 81 deg. 48 min. 25 sec. West for 572.24 feet to a 5/8 inch rebar set;

Thence turning and running South 31 deg. 37 min. 21 sec. West for 148.22 feet to a 5/8 inch rebar set;

Thence turning and running North 63 deg. 04 min. 11 sec. West for 156.34 feet to a 5/8 inch rebar set;

Thence turning and running South 07 deg. 30 min. 14 sec. West for 997.07 feet to a 5/8 inch rebar set;

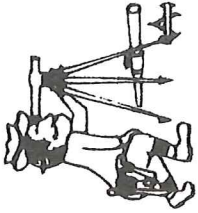

Riedel Land Surveying Company

712 N. Henry St.
Crestline, Ohio 44827

Page 02

Phone (419) 683-1951

Keller Property continued

26.699 acres

Rsh35sed

Thence turning and running North 82 deg. 38 min. 03 sec. West for 100.00 feet to the West line of the Southeast quarter of Section 35 (an existing iron pin being North 82 deg. 38 min. 03 sec. West and 1.32 feet from this point);

Thence turning and running North 07 deg. 30 min. 14 sec. East along said West line for 1998.78 feet to the place of beginning.

The above described parcel has a calculated area of 26.699 acres of land according to a survey made on June 08, 2020 by Steven H. Riedel, Ohio surveyor 7016.

The grantees, their heirs and assigns do hereby covenant and agree that the parcel of land described in this instrument or any portion thereof does not constitute a principal building site under applicable zoning and will not be conveyed by said grantee, heirs and assigns, independent from any adjoining or contiguous parcel.

All 5/8 inch rebars set have a plastic cap stamped "PS 7016".

Prior Deed: OR V 2254 page 328

Basis of bearings: Survey Index: "F-3-376"

NEW SPLIT
RICHLAND COUNTY
TAX MAP OFFICE

EAK Le-2320
INITIAL DATE
MM-176