

PLAT OF BOUNDARY SURVEY
CHARLIE & VICKI SCHROEDER
 PART OF THE NORTHEAST QUARTER, SECTION THIRTY-ONE (31)
 TOWNSHIP TWENTY-TWO (22), RANGE NINETEEN (19)
 SHARON TOWNSHIP, RICHLAND COUNTY, OHIO

HUMMEL ROAD
 (T.H. 171)

2686.62' (MEAS)
STEIN ROAD (T.H. 169)

POINT OF COMMENCEMENT

POINT OF BEGINNING

N. LINE, NE 1/4, SEC. 31

N89°20'50"W
 322.84'

S89°20'50"E
 363.11'

REFERENCE MATERIALS

- DEEDS AS SHOWN
- TAX MAPS
- THE FOLLOWING RICHLAND COUNTY SURVEYS FOUND AT THE RICHLAND COUNTY TAX MAP OFFICE:
 HH-299
 P-163

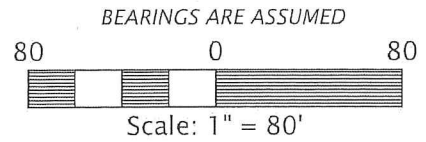

REF. 25.50'

REF. 36.08'

N00°30'18"E
 295.92'

S00°00'09"E
 168.63'

11.1'

11.8'

N14°42'30"E
 191.38'

81.18'

N33°11'12"W
 81.94'

N54°23'58"W
 164.22'

N84°27'24"W

349.83'
 S11°15'10"W

CENTERLINE OF DITCH

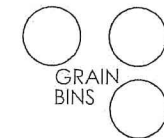
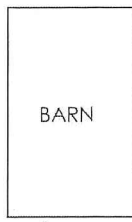
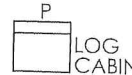
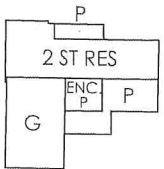

A.O. DUNN
 ORV 1997/243
3.753 ACRES

A.O. DUNN
 ORV 1997/243

NEW SPLIT
 RICHLAND COUNTY
 TAX MAP OFFICE
EAK 5-11-17
 INITIAL DATE
JJ-147



PREPARED BY
F.E. KROCKA & ASSOCIATES, INC.
 44 EAST MAIN STREET
 SHELBY, OHIO 44875
 (419) 342-4556

I CERTIFY THIS SURVEY WAS PREPARED FROM ACTUAL FIELD MEASUREMENTS IN ACCORDANCE WITH CHAPTER 4733-37 OF THE OHIO ADMINISTRATIVE CODE AND THAT ALL MONUMENTS WERE FOUND OR SET AS INDICATED.

Nathan W. Sautter
 NATHAN W. SAUTTER
 OHIO REGISTERED SURVEYOR NO. 8252
 DATE: APRIL 28, 2017

LEGEND

- RAILROAD SPIKE FOUND
- RAILROAD SPIKE SET
- 3/4" DIAMETER, 30" LONG IRON PIN SET WITH CAP STAMPED "KROCKA & ASSOC."

APPROVED

Steve Trischer
 SHARON TOWNSHIP ZONING

W. LINE, NE 1/4, SEC. 31

E. LINE, NE 1/4, SEC. 31

NW COR.
 NE 1/4
 SEC. 31

NE COR.
 NE 1/4
 SEC. 31

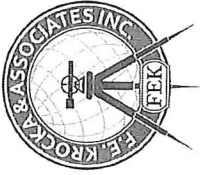

F.E. Krocka & Associates, Inc.
Engineering and Surveying
44 East Main Street
Shelby, Ohio 44875
Phone: (419) 342-4556
Fax: (419) 347-8885

DESCRIPTION
CHARLIE & VICKI SCHROEDER
PART OF THE NORTHEAST QUARTER OF SECTION THIRTY-ONE (31)
TOWNSHIP TWENTY-TWO (22), RANGE NINETEEN (19)
SHARON TOWNSHIP, RICHLAND COUNTY, OHIO

DESCRIPTION: Being part of the Northeast Quarter of Section Thirty-One (31), Township Twenty-Two (22), Range Nineteen (19), Sharon Township, Richland County, Ohio, and being more particularly described as follows:

Commencing for the same at a railroad spike found at the northeast corner of the Northeast Quarter of Section 31, said point also being on the centerline of Stein Road (T.H. 169); Thence N89°20'50"W, along the north line of the Northeast Quarter of Section 31 and the centerline of Stein Road, a distance of 322.84 feet to a railroad spike set at the real point of beginning for the parcel herein described;

- 1) thence S00°00'09"E, passing for reference an iron pin set at 36.08 feet, a total distance of 168.63 feet to an iron pin set;
- 2) thence S11°15'10"W, a distance of 349.83 feet to an iron pin set;
- 3) thence N84°27'24"W, a distance of 164.22 feet to an iron pin set;
- 4) thence N54°23'58"W, a distance of 81.94 feet to an iron pin set;
- 5) thence N33°11'12"W, a distance of 81.18 feet to an iron pin set;
- 6) thence N14°32'06"W, a distance of 91.38 feet to an iron pin set;
- 7) thence N00°30'18"E, passing for reference an iron pin set at 270.42 feet, a total distance of 295.92 feet to a railroad spike set on the north line of the Northeast Quarter of Section 31 and the centerline of Stein Road;
- 8) thence S89°20'50"E, along the north line of the Northeast Quarter of Section 31 and the centerline of Stein Road, a distance of 363.11 feet to the real point of beginning.

and containing 3.753 acres, more or less, but subject to all legal easements and public rights-of-way now on record. All iron pins set are 3/4" diameter, 30" long with caps stamped "KROCKA & ASSOC." Bearings are assumed.

CERTIFICATION: I certify this survey was prepared from actual field measurements in accordance with Chapter 4733-37 of the Ohio Administrative Code and that all monuments were found or set as indicated.

F. E. KROCKA & ASSOCIATES, INC.

Nathan W. Sautter
Ohio Registered Surveyor No. 8252
Date: April 28, 2017

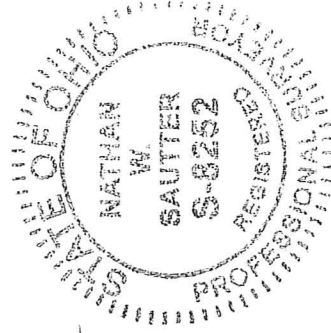

NEW SPLIT
RICHLAND COUNTY
TAX MAP OFFICE
F.E.K. INITIAL
5-11-17 DATE
JJ-147