

BOUNDARY SURVEY
STATE OF OHIO, COUNTY OF RICHLAND, TOWNSHIP OF WORTHINGTON
SW QTR., SEC. 5, TWP. 21, RANGE 17
CONGRESS LAND NORTH OF SEVEN RANGES

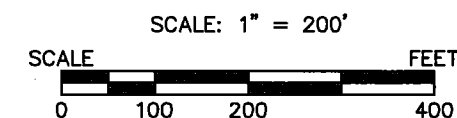

THE BEARINGS ARE BASED ON THE EASTERLY LINE OF AN 18.32 ACRE TRACT IN THE NAME OF JOHN F. LUERS JR., TRUSTEE, OR SUCCESSORS IN TRUST AS DESCRIBED IN O.R. VOL. 2283, PG. 716 BEING NORTH 07° 30' EAST

PROPERTY OWNER:
 LYNN T. MAROTTA TRUST
 (AS RECORDED IN O.R. VOLUME 0632, PAGE 188)
 2.26 AC. (REC)
 2.375 AC. (SURVEY)

POB
 2.375 AC. TRACT

NORTHERLY EXTENSION OF AN EXISTING FENCE LINE

PROPERTY OWNER:
 JOHN F. LUERS JR., TRUSTEE,
 OR SUCCESSORS IN TRUST
 (AS RECORDED IN O.R. VOL. 2283, PAGE 716)

PROPERTY OWNER:
 LYNN T. MAROTTA TRUST
 (AS RECORDED IN O.R. VOL. 0632, PAGE 188)
 PROPERTY ADDRESS:
 5384 POSSUM RUN RD.
 19.4 AC. (REC.)
 19.211 AC. (SURVEY)

PROPERTY OWNER:
 DELOS ERNSBERGER & CONNIE ERNSBERGER
 (AS RECORDED IN VOL. 2081, PAGE 416)

POB
 19.211 AC. TRACT

I HEREBY CERTIFY THIS DESCRIPTION WAS PREPARED BY USING MEASUREMENTS OBTAINED BY AN ACTUAL FIELD SURVEY CONDUCTED UNDER MY DIRECT SUPERVISION IN SEPTEMBER 2015.

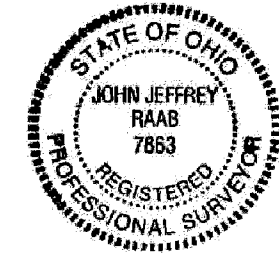

John J. Raab
 JOHN J. RAAB, PS 7863

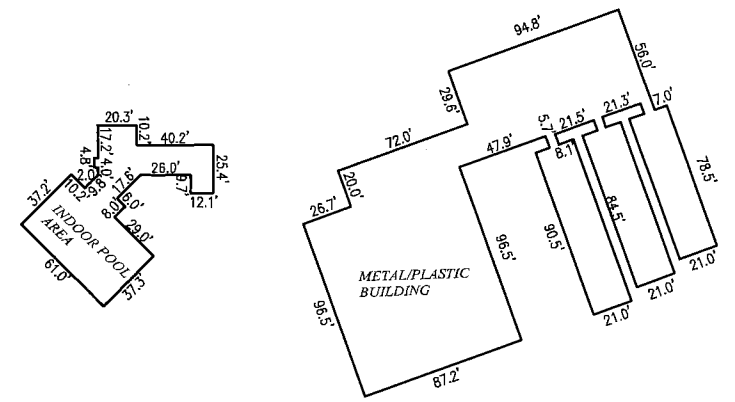
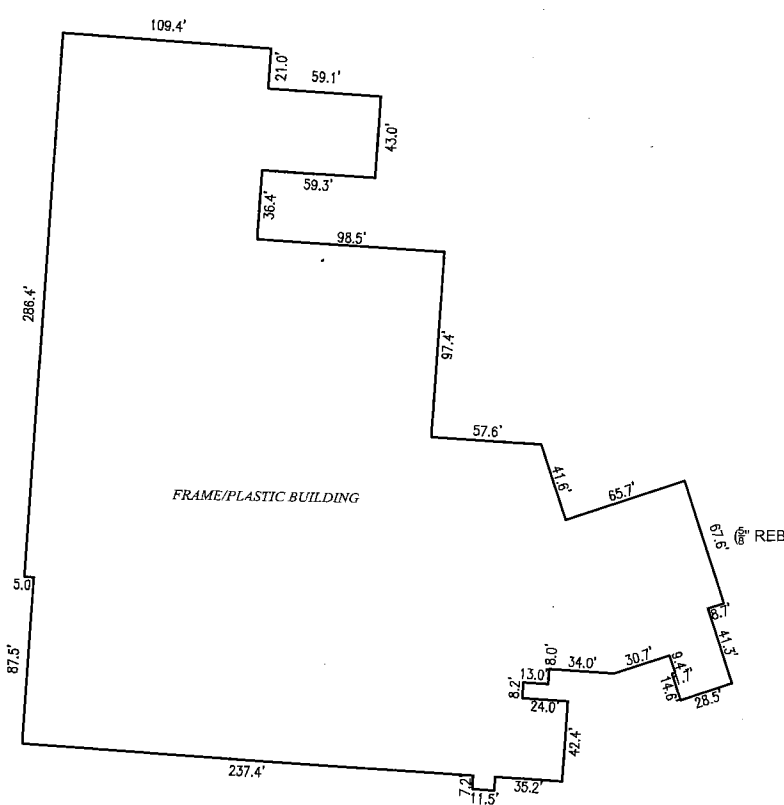

BUILDING DETAIL: NO SCALE

NEW SURVEY
 OF EXISTING PARCEL
 RICHLAND COUNTY
 TAX MAP OFFICE
 EAK 10-6-15
 INITIAL DATE
 HH-256

LEGEND

- IRON PIN FOUND
 - ▲ RAIL ROAD SPIKE FOUND
 - △ RAIL ROAD SPIKE SET
 - IRON PIN SET
 - IRON PIN INSIDE MONUMENT BOX ASSEMBLY
- *IRON PINS SET ARE 3/4" INSIDE DIAMETER IRON PIPE 30" LONG WITH A YELLOW CAP INSCRIBED "OHM"
 *RAIL ROAD SPIKE MATERIAL G SIZE

BOUNDARY SURVEY

STATE OF OHIO, COUNTY OF RICHLAND, TOWNSHIP OF WORTHINGTON SW 1/4 SECTION 5, TWP 21, RANGE 17 CONGRESS LAND NORTH OF SEVEN RANGES	SCALE HOR. 1"=200'	INCH 1
DRAWING NO. JOB_NO. 1086-15-0011	SHEET NO. 1 OF 1	





OHM

Advancing Communities®

ARCHITECTS. ENGINEERS. PLANNERS.

Situated in the State of Ohio, County of Richland, Township of Worthington, and being part of the southwest quarter of Section 5, Township 21, Range 17, Congress Land North of Seven Ranges, and also being a resurvey of a 2.26 acre tract in the name of Lynn T. Marotta, Trustee of the Lynn T. Marotta Trust, as described in OR Volume 632, Page 188 and being more particularly described as follows:

Beginning for reference at a 5/8" Iron pin found at the northwest corner of the southwest quarter of Section 5,

Thence South 01°23'01" West with the west line of said Quarter Section a distance of 1951.50 feet to an ¾" inside diameter pinch top iron pipe found at the southwesterly corner of a 18.32 acre tract in the name of John F. Luers Jr., trustee, or successors in trust, under The Luers Irrevocable Heritage Trust, as described in OR Volume 2283, Page 716;

Thence North 88°46'49" East parallel with the north line of said Quarter Section a distance of 525.43 feet to an iron pipe set at the southeasterly corner of said 18.32 acre tract;

Thence North 07°30'00" East, a distance of 1032.43 feet with the easterly line of said 18.32 acre tract and partially along the remnants of an old fence line and its northeasterly extension to iron pipe set at the southwesterly corner of said 2.26 acre tract and being the **True Place of Beginning** for the tract herein being described

Thence North 07°30'00" East, a distance of 359.60 feet continuing with said easterly line, passing an iron pipe set at 329.40 feet to a point in the centerline of Possum Run Road (C.H. 320)(60' R/W)

Thence with the centerline of said road the following (3) three courses:

1. South 75°59'04" East, a distance of 66.31 feet to a railroad spike set at a point of curvature;
2. Thence 258.21 feet with a curve to the right having a radius of 532.18 feet, through a central angle of 27°47'58", of which a chord bears South 62°05'05" East, a distance of 255.68 feet to a railroad spike set
3. South 48°11'06" East, a distance of 155.72 feet to a railroad spike set at a northerly corner of a 19.4 acre tract in the name of Lynn T. Marotta, Trustee of the Lynn T. Marotta Trust, as described in Official Records Volume 632, Page 188;

Thence South 62°15'00" West, a distance of 251.15 feet, passing iron pipes set at 32.01 feet and 231.15 feet with said northerly line with the northerly line to a point;

Thence South 90°00'00" West, a distance of 231.00 feet continuing with said northerly line to the **True Place of Beginning**, containing 2.375 acres more or less, subject to all legal highways, easements, leases, restrictions of record and of records in the respective utility offices;

Iron pipes set are 3/4" inside diameter iron pipes, 30" long with a yellow cap inscribed "OHM".

The bearings are based on the easterly line of said 18.32 acre tract as being North 07°30" East as stated in Official Records Volume 2283, Page 716.

I hereby certify this description was prepared by using measurements obtained by an actual field survey conducted under my direct supervision in September 2015.

John J. Raab, Ohio Registered Surveyor No. 7863

Encl: 1086150011_5384_Possum_Run_Road_Boundary_2.375_Ac
cc: Elaine A. Kiefer, Tax Map Supervisor

**NEW SURVEY
OF EXISTING PARCEL
RICHLAND COUNTY
TAX MAP OFFICE**

EAV **JD-6-15**
INITIAL DATE
HH-256

OHM Advisors
101 MILL STREET, STE. 200
GAHANNA, OHIO 43250

T 614.418.0600
F 614.418.0614

OHM-Advisors.com

580 NORTH FOURTH STREET, SUITE 630
COLUMBUS, OH 43215

T 614.418.9921
F 614.418.0614



OHM

Advancing Communities®

ARCHITECTS. ENGINEERS. PLANNERS.

Situated in the State of Ohio, County of Richland, Township of Worthington, and being part of the southwest quarter of Section 5, Township 21, Range 17, Congress Land North of Seven Ranges, and also being a resurvey of a 19.4 acre tract in the name of Lynn T. Marotta, Trustee of the Lynn T. Marotta Trust, as described in Official Records Volume 632, Page 188 and being more particularly described as follows:

Beginning for reference a 5/8" iron pin found at the northwest corner of the southwest quarter of Section 5, Thence South 01°23'01" West with the west line of said Quarter Section a distance of 1951.50 feet to an ¾" inside diameter pinch top iron pipe found at the southwesterly corner of a 18.32 acre tract in the name of John F. Luers Jr., trustee, or successors in trust, under The Luers Irrevocable Heritage Trust, as described in OR Volume 2283, Page 716;

Thence North 88°46'49" East with the north line of said Quarter Section a distance of 525.43 feet to an iron pin set at the southeasterly corner of said 18.32 acre tract and being the **True Place of Beginning** for the tract herein being described;

Thence North 07°30'00" East, a distance of 1032.43 feet with the easterly line of said 18.32 acre tract and partially along the remnants of an old fence line and its northeasterly extension to iron pipe set at the southwesterly corner of a 2.26 acre tract in the name of Lynn T. Marotta, Trustee of the Lynn T. Marotta Trust, as described in Official Records Volume 632, Page 188;

Thence North 90°00'00" East, a distance of 231.00 feet along the southerly line of said 2.26 acre tract to a point;

Thence North 62°15'00" East, a distance of 251.15 feet, passing iron pipes set at 20.00 feet and 219.14 feet, to a railroad spike set in the centerline of Possum Run Road (C.H. 320)(60' R/W);

Thence with the centerline of said road the following (3) three courses:

1. South 48°11'06" East, a distance of 224.27 feet to a railroad spike set;
2. South 51°08'37" East, a distance of 385.87 feet, passing a 1" iron pin found in a monument box assembly at 302.66 feet being a point of curvature new centerline of relocated Possum Run Road as described in Right of Way RIC-CR320-2.43 plans of record at the Richland County Engineers Office, to a railroad spike set at a point of curvature with old centerline Possum Run Road;
3. Thence with the old centerline of Possum Run Road a distance of 152.61 feet with a curve to the left having a radius of 401.15 feet, through a central angle of 21°47'48", of which a chord bears South 62°02'31" East, a distance of 151.69 feet to a railroad spike set at the centerline intersection with Hagerman Road (T.H. 387) (60' R/W);

Thence with the centerline of said Hagerman Road the following (3) courses:

1. South 53°10'17" West, a distance of 335.96 feet to a railroad spike set;
2. South 37°36'54" West, a distance of 466.85 feet, passing a railroad spike found at 215.14 feet, to a 5/8" Iron Rebar found:
3. South 11°52'15" West, a distance of 95.55 feet to a railroad spike found at the northeasterly corner of a 16.20 acre tract in the name of Delos Ernsberger and Connie Ernsberger as described in OR Volume 2081, Page 416;

Thence South 88°46'49" West, a distance of 616.27 feet with the northerly line of said 16.20 acre tract to the **True Place of Beginning**, containing 19.211 acres more or less, subject to all legal highways, easements, leases, restrictions of record and of records in the respective utility offices;

Iron pipes set are 3/4" inside diameter iron pipes, 30" long with a yellow cap inscribed "OHM".

The bearings are based on the easterly line of said 18.32 acre tract as being North 07°30" East as stated in OR Volume 2283, Page 716.



I hereby certify this description was prepared by using measurements obtained by an actual field survey conducted under my direct supervision in September 2015.

John J. Raab, Ohio Registered Surveyor No. 7863

NEW SURVEY
OF EXISTING PARCEL
RICHLAND COUNTY
TAX MAP OFFICE

~~FAK~~ INITIAL 10-6-15
DATE
HH-ZSLG

Encl: 1086150011_5384_Possum_Run_Road_Boundary_19.211_Ac
cc: Elaine A. Kiefer, Tax Map Supervisor