

BASIS OF BEARING:  
THE BEARINGS AS SHOWN HEREON  
ARE RELATIVE TO SURVEY W-192.

"CRAIG" BAR  
& CAP FD.  
@ 30.00'

"CRAIG" BAR  
& CAP FD.  
@ 30.00'

1" IRON  
BAR FD.

(SURVEY W-192)  
FD. @  
20.00'

"BLUNK" BAR  
& CAP FD.  
@ 29.92'

"BLUNK" BAR  
& CAP FD.

EARL K. ESTEP  
O.R. V-1057, P-425

EARL K. ESTEP  
O.R. V-1252, P-593

GENE L. &  
LEANNE S. GOMPFF  
O.R. V-1889, P-159

R. KEITH & LINDA L. BENDER  
O.R. V-409, P-936

S.R. 430

PARK AVENUE EAST

N 46°26'42" E  
341.00'

N 00°14'29" E 383.65'

N 01°05'46" E 306.52'

S 00°13'59" W 922.83'

S 89°29'11" W  
250.86' TOTAL

EAST LINE OF SE QTR. SEC. 23

N 00°13'59" E 934.81'

STEWART ROAD T.R. 267

SOUTH LINE OF SE QTR. SEC. 23

23 24

26 25

# MAP OF SURVEY OF A 4.574 ACRE PARCEL

SE QUARTER OF SECTION 23  
T-21-N; R-18-W  
MADISON TOWNSHIP  
RICHLAND COUNTY, OHIO

- ✕ MAG NAIL FOUND
- CAPPED PIN FOUND WITH I.D. CAP MARKED "SEILER & CRAIG" (UNLESS NOTED)
- ⊗ 2" MAG NAIL SET

NEW SURVEY  
OF EXISTING PARCEL  
RICHLAND COUNTY  
TAX MAP OFFICE

INITIALS  
DATE  
HH-136

Distances shown hereon are expressed in feet and decimal parts thereof, bearings are used to express angles only, iron pins or monuments were found or set as indicated hereon. All of which I believe to be correct to the best of my knowledge.



By:  JASON J. LINGENFELTER, P.S. #8499  
DATE  
6-12-15

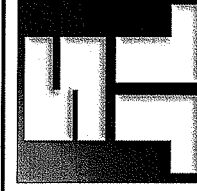

SHAFFER, JOHNSTON, LICHTENWALTER  
& ASSOCIATES, INC.  
Consulting Engineers & Surveyors  
909 South Main Street  
Mansfield, Ohio 44907  
TEL (419) 756-7302 FAX (419) 756-0867 EMAIL sjl@sjl-inc.com

DWG NO:	SM-2183	JOB NO:	SM-2083	SHEET	1 OF 1
CHECKED		SCALE	1" = 100'	DATE	JUNE 12, 2015

**SHAFFER, JOHNSTON, LICHTENWALTER  
& ASSOCIATES, INC.  
ENGINEERS & SURVEYORS**

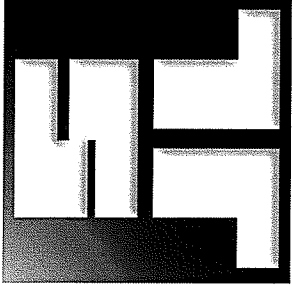

Boundary description of a **4.574** acre parcel

Job No. SM-2183

Situated in the Township of Madison, County of Richland, State of Ohio, being part of the Southeast Quarter of Section 23, T-21 N; R-18 W, also known as being the lands conveyed to Gene L. & Leanne S. Gompf as recorded in Official Record Volume 1889, Page 159 and further bound and described as follows:

**COMMENCING** at a MAG nail found in Stewart Road, (Township Road 267), and know as the southeast corner of the Southeast Quarter of Section 23, Madison Township,

Thence, N 00° 13' 59" E, 934.81 feet along the Section Line and with Stewart Road to a MAG nail found, witnessed by a 5/8 inch iron bar with ident cap "Blunk" found S 89° 29' 11" W, 29.92 feet and the True Place of Beginning,

THENCE WITH THE FOLLOWING FIVE (5) COURSES:

- 1) **S 89° 29' 11" W, 250.86** feet along the Grantors' south line and the north line of Earl K. Estep. (O.R. V-1252, P-593), to a 5/8 inch iron bar with ident cap "Blunk" found,
- 2) **N 01° 05' 46" E, 306.52** feet along the Grantor's west line and the east line of the lands of Earl K. Estep, (O.R. V-1057, P-425), to a 1 inch iron bar found,
- 3) **N 00° 14' 29" E, 383.65** feet along the Grantors' west line and the east line of the lands of R. Keith & Linda L. Bender, (O.R. V-409, P-936), to a point in Park Avenue East, (State Route 430), and witnessed by a 1 inch iron bar found 41.16 feet southwest on line,
- 4) **N 46° 26' 42" E, 341.00** feet along the Grantors' north line and with Park Avenue East to a 2 inch MAG nail set in the intersection of Park Avenue East and Stewart Road,
- 5) **S 00° 13' 59" W, 922.83** feet along the Grantors' east line and with Stewart Road to a MAG nail found and the true place of beginning and containing within said bounds **4.574** acres of land, more or less, and subject to all legal highways and easements of record.

Boundary description of a 4.574 acre parcel continued;

Basis of Bearings are relative to Survey W-192.

According to a survey made in June 2015 by Jason J. Lingenfelter, Ohio Professional Surveyor No. 8499.

All iron pins set are 5/8" diameter rod with plastic cap stamped "SJL, INC".

  
Jason J. Lingenfelter

Professional Surveyor No. 8499  
June 12, 2015

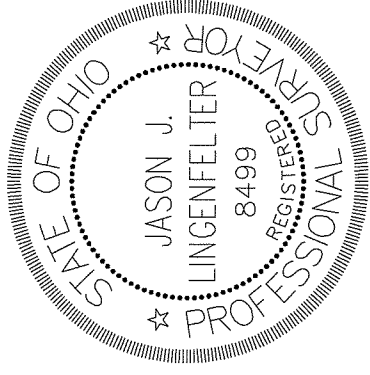

NEW SURVEY  
OF EXISTING PARCEL  
RICHLAND COUNTY  
TAX MAP OFFICE

EAK 6-16-15  
INITIAL DATE  
HH-136