

D-319

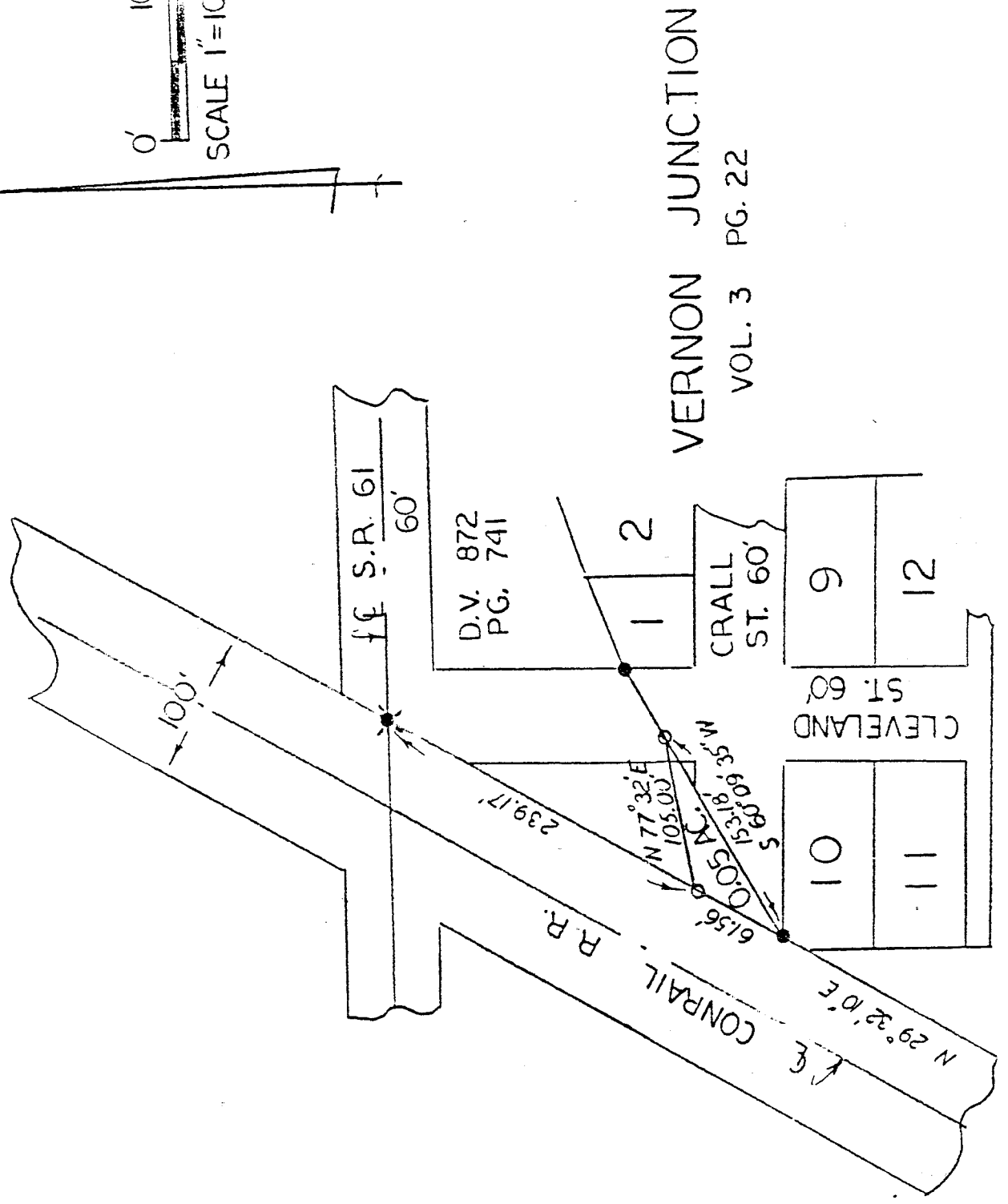
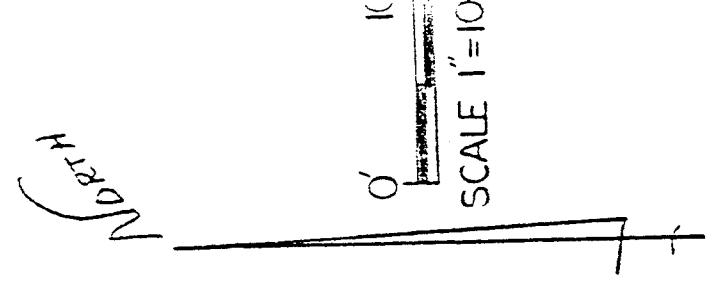

VERNON JUNCTION
VOL. 3 PG. 22

SOUTHEAST QUARTER
SECTION 24, TP. 21, RG. 20
SHARON TOWNSHIP
RICHLAND COUNTY, OHIO

LEGEND:

- - 5/8" rebar w/cap stamped "PS 7016" set
- - Existing iron pin
- ✱ - Existing survey nail

STEVEN H. RIEDEL

Steven H. Riedel
Ohio registered surveyor 7016
February 9, 1988

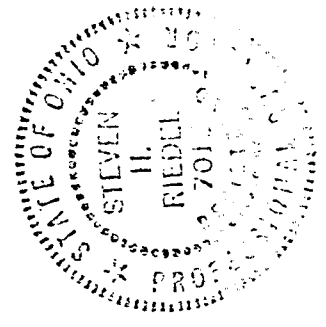

D-319