

PLAT OF BOUNDARY SURVEY

RUTH CLAYBAUGH

PART OF THE SOUTHEAST QUARTER, SECTION NINETEEN (19)  
TOWNSHIP TWENTY-TWO (22), RANGE NINETEEN (19)  
SHARON TOWNSHIP, RICHLAND COUNTY, OHIO

NEW SPLIT  
TAX MAP APPROVED

INITIAL EAIS DATE 10-20-94

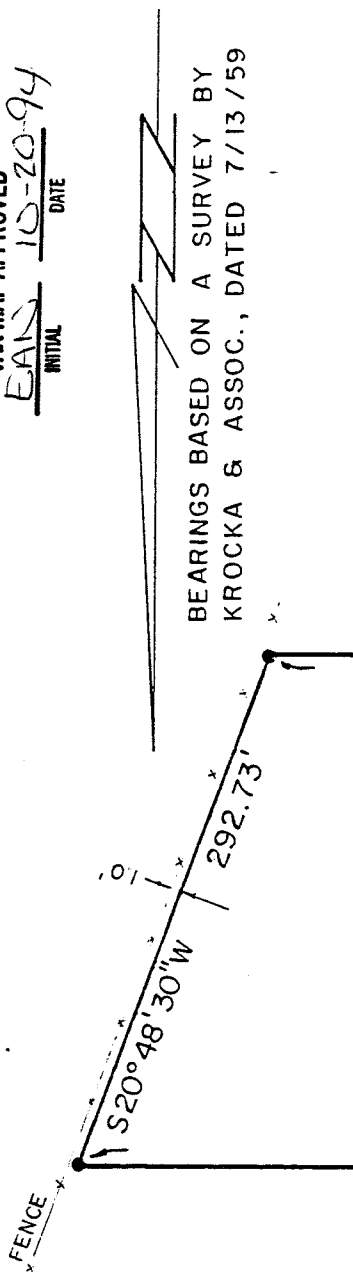

BEARINGS BASED ON A SURVEY BY  
KROCKA & ASSOC., DATED 7/13/59

SCALE : 1" = 100'  
100 75 50 25 0 50 100

NO PLAT REQUIRED

*B. Berdani*

BRUCE W. BERDANIER  
SHELBY CITY ENGINEER  
DATE: OCTOBER 18, 1994

5.170 ACRES

H.W. & R.M. CLAYBAUGH  
D. 472/107  
75.5 ACRES

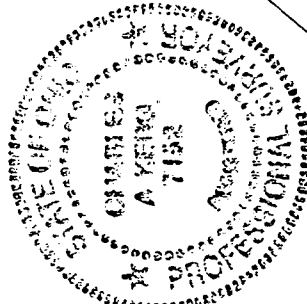

SHELBY-GALLON RD. (S.R. 61)  
N. LINE, SE 1/4, SEC. 19

SW COR. SEC 1/4, SEC 19

DUE NORTH 275.00'  
HUMMEL RD.  
(C.H. 171)

*Sharon Young*  
*Sharon Young*  
*Young*  
*Inspector*  
10/19/94

PREPARED BY

KERG SURVEYING

*Charles A. Kerg*  
CHARLES A. KERG

REGISTERED OHIO SURVEYOR NO. 7152  
DATE: OCTOBER 6, 1994

- IRON PIPE FOUND
- △ IRON PIN FOUND
- ✱ RAILROAD SPIKE SET
- 5/8" IRON PIN SET WITH CAP
- STAMPED "C. KERG, RLS 7152"

CHARLES A. KERG  
REGISTERED LAND SURVEYOR No. 7152  
102 West Main Street  
Shelby, Ohio 44875  
Phone: (419) 347-8799

NEW SPLIT  
TAX MAP APPROVED  
EAK 10-10-94  
INITIAL DATE

DESCRIPTION  
RUTH CLAYBAUGH  
PART OF THE SOUTHEAST QUARTER, SECTION NINETEEN (19)  
TOWNSHIP TWENTY-TWO (22), RANGE NINETEEN (19)  
SHARON TOWNSHIP, RICHLAND COUNTY, OHIO

DESCRIPTION: Being a part of the Southeast Quarter of Section Nineteen (19), Township Twenty-two (22), Range Nineteen (19), Sharon Township, Richland County, Ohio, and being more particularly described as follows:

Commencing for the same at an iron pipe found on the centerline of Hummel Road (County Highway 171) at the southwest corner of the Southeast Quarter of Section Nineteen (19); thence Due North a distance of 645.02 feet along said centerline and the west line of said quarter-section to an iron pipe found (0.24 foot west) on the northeasterly right-of-way line of the abandoned Pennsylvania Railroad at the southwest corner of 75.5 acres in the name of Herbert W. and Ruth M. Clabaugh per Deed Volume 472, Page 107, said pipe being the real point of beginning of the parcel herein described;

- 1) thence Due North a distance of 275.00 feet along said centerline and quarter-section line (west line of said 75.5 acres) to a railroad spike set;
- 2) thence S 89°15'00" E a distance of 871.00 feet to an iron pin set, and passing for reference an iron pin set at 22.00 feet;
- 3) thence S 20°48'30" W a distance of 292.73 feet to an iron pin set, and passing
- 4) thence N 89°15'00" W a distance of 767.00 feet to the real point of beginning of the parcel herein described, and passing for reference on line an iron pin

and containing 5.170 acres, more or less, but subject to all legal easements and public rights-of-way now on record. All iron pins set are 5/8" in diameter with caps stamped "C.KERG, RLS 7152". The bearing of Hummel Road is based on a survey by F. E. Krocka and Associates, dated July 13, 1959.

CERTIFICATION: I hereby certify that a boundary survey was made of the above property and that points were found or set as indicated.

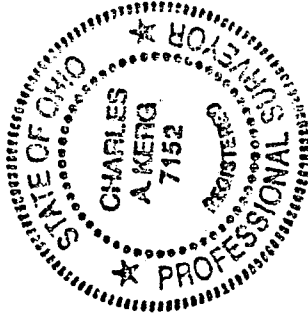

Prepared by  
KERG SURVEYING

*Charles A. Kerg*  
Charles A. Kerg  
Registered Ohio Surveyor No. 7152  
Date: October 6, 1994