

TRACY & MILLS SURVEYORS

DAVID R. MILLS, PS  
SURVEYOR # 7157

10 East Vine Street - P.O. Box 642  
Mount Vernon, Ohio 45050  
Tel.: 740-397-8324 Fax: 740-397-5910  
e-mail: tracyandmills@aol.com

THOMAS M. TRACY, PS  
1941-2002

SURVEY FOR:

Ronald E. & Rebecca A. Doup

LOCATION:

ORV 1209, Pg. 365  
Part of the Southwest Quarter of Section 32, Township 19,  
Range 18, Jefferson Township, Richland County, Ohio

Date: October 27, 2011  
Scale: 1" = 150'

○ - Iron Pin Set (5/8" x 30")  
▲ - Iron Pin Found  
△ - Rail Road Spike  
- P.K. Nail  
PARCEL # 014-34-001-14-000

R. & R. Doup  
4.994 Acres  
0143404610001  
8-2-04  
ORV 1417, P 634

Renie Road (Township Road 117)

N89°07'53"E 940.64'

17.840 ACRES

PARCEL # 014-34-001-14-000

S.E. Qtr. Section 31

S.W. Qtr. Section 32

S0°30'01"E 825.91'

C. Strater Etal 3  
38 acres  
0143404413000  
2-26-99  
ORV 684, P 864

S89°06'17"W 940.68'

C. Mlay  
2.21 acres  
0143402709003  
4-29-94  
ORV 302, P 481

NEW SURVEY  
OF EXISTING PARCEL  
RICHLAND COUNTY  
TAX MAP OFFICE

INITIAL DATE  
EAK 11-19-11  
CC-244

S.W. Cor.  
Section 32

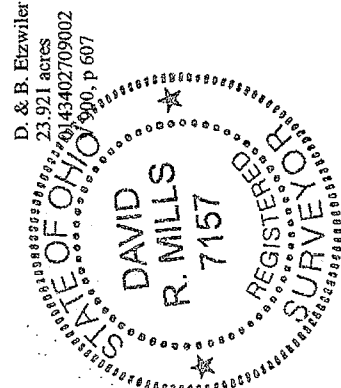

D. & B. Elzweiler  
23.921 acres  
0143402709002  
0143402709000, p 607

Survey T - 193

Richland County

Knox County

Leedy Road (Township Road 24)

CERTIFICATION: We hereby certify that the foregoing survey was prepared from actual field measurements, in accordance with Chapter 4733-37, Ohio Administration Code.

*(Signature)*  
David R. Mills, Surveyor 7157

# Tracy & Mills, Surveyors

Thomas M. Tracy, PS  
1941-2002

David R. Mills, PS

## LEGAL DESCRIPTION FOR:

Ronald & Rebecca Doup

17.840 ACRES

October 2011

The following real estate, situate in the Southwest Quarter of Section 32, Township 19, Range 18, Jefferson Township, Richland County, Ohio and being described as follows:

Commencing at an iron pin found on the Richland - Knox County Line at the southwest corner of the Southwest Quarter of Section 32 at the intersection of the centerlines of Leedy Road (Township Road 24 and Renie Road (Township Road 117); thence along the centerline of Renie Road North 0 deg. 29' 52" West 970.24 feet to the northwest corner of a 2.21 acre tract ( C. Mlay, ORV 302, Pg. 481, Parcel # 014-34-027-09-003) witnessed by an iron pin found at North 89 deg. 06' 17" East 28.08 feet and being the southwest corner and beginning point of the tract herein described; thence continuing along the centerline of Renie Road North 0 deg. 29' 52" West 826.35 feet to the southwest corner of a 4.994 acre tract ( R. & R. Doup, ORV 1417, Pg. 634, Parcel # 014-34-046-10-001); thence along the south line of said tract North 89 deg. 07' 53" East, passing through an iron pin found at 27.23 feet, a total of 940.64 feet to an iron pin found at the southeast corner of said 4.994 acres on the west line of a 38 acre tract ( C. Strater Etal 3, ORV 684, Pg. 864, Parcel # 014-34-044-13-000); thence along the west line of said 38 acres South 0 deg. 30' 01" East 825.91 feet to an iron pin found on the west line of a 23.921 acre tract (D. & B. Etzwiler, D.V. 900, Pg. 607, Parcel # 014-34-027-09-002); thence along a north line of said 23.921 acres and the north line of the aforesaid 2.21 acres South 89 deg. 06' 17" West, passing through an iron pin found at 912.60 feet, a total of 940.68 feet to the point of beginning, containing 17.840 acres, as surveyed in October 2011 by Tracy & Mills, Surveyors, 10 E. Vine Street, Mount Vernon, Ohio, David R. Mills, Surveyor #7157, Ohio. North based on Survey Record T-193.  
Note: Iron pins set are 5/8" x 30" rebar with plastic cap stamped Tracy and Mills.

Being Parcel # 014-34-001-14-000. O.R.V. 1209, Page 365.

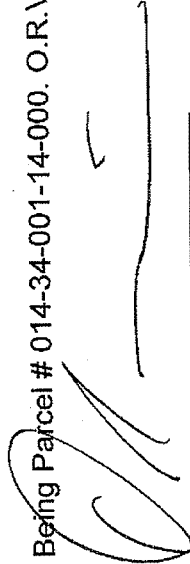

David R. Mills Surveyor # 7157

Date: October 28, 2011

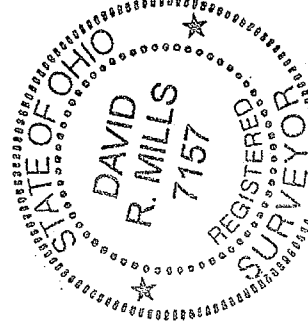

NEW SURVEY  
OF EXISTING PARCEL  
RICHLAND COUNTY  
TAX MAP. OFFICE

INITIAL DATE  
EAK 11-9-11  
CC-244