

K. BERNHARD
ORV 1843 P 449

5.90'00\"/>

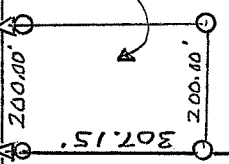

1.41 AC
M. & L. STUART
ORV 1489 P 246

STUART REAL
ESTATE LTD
ORV 1317 P 131

28.762 AC

12.371 AC
J & S STUART
ORV 1321 P 28

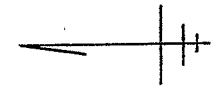

NORTH
SCALE - 1" = 300'

- △ RAILROAD SPIKE FOUND
- IRON PIN FOUND
- IRON PIN SET W/CAP
"MAWHORR 6690"



BEARINGS ASSUMED
BASED ON NORTH LINE SE 1/4 SEC 17
N 90° 00' 00" E

SOUTH LINE S.E. 1/4 SEC 17 200.00'
436.74'
S 89° 49' 00" E

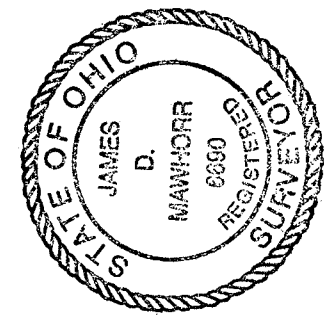

NEW SPLIT
RICHLAND COUNTY
TAX MAP OFFICE
EAK INITIAL DATE
7-10-11
CC-125

SURVEY PLAT 28.762 ACRES
S.E. 1/4 SEC 17 T25 R17
BUTLER TOWNSHIP
RICHLAND COUNTY, OHIO
FOR J. STUART
JUNE 25, 2011

James D. Mawhorr
JAMES D. MAWHORR
REG. SURVEYOR NO. 6690

Legal Description
28.762 Acres J. Stuart

Situated in the Township of Butler, County of Richland, State of Ohio, and known as being part of the Southeast Quarter of Section 17, Township 25, Range 17, and more particularly described as follows:

Commencing at an iron pin found at the northwest corner of the Southeast quarter of Section 17, thence North 90 deg. 00 min. 00 sec. East along the north line of said quarter section and the center of Crum Road (CH 83) a distance of 1511.63 feet to a railroad spike found which is the True Place of beginning and also the northeast corner of a 12.371 acre parcel as conveyed to J. & S. Stuart (OR V 1321 P 28);

Thence South 01 deg. 37 min. 00 sec. East along the east line of said 12.371 acre parcel, passing thru an iron pin found at 25.00 feet a total distance of 2643.45 feet to an iron pin found at the southeast corner of said 12.371 acre parcel and also the south line of the Southeast Quarter of Section 17;

Thence South 89 deg. 49 min. 00 sec. East along the south line of the Southeast Quarter of Section 17 a distance of 436.74 feet to an iron pin set;

Thence North 00 deg. 00 min. 00 sec. East passing thru iron pins found at 2336.65 feet and 2618.80 feet a total distance of 2643.80 feet to a railroad spike found at the northwest corner of a 1.41 acre parcel as conveyed to M & L Stuart (ORV 1489 P 246) and also being the north line of the Southeast Quarter of Section 17;

Thence South 90 deg. 00 min. 00 sec. West along the north line of said quarter section and the center of Crum Road (CH 83) a distance of 511.32 feet to the True Place of Beginning, containing 28.762 acres of land, more or less, but subject to all legal highways and easements of record.

Bearings assumed based on the north line of the Southeast Quarter of Section 17. Iron pins set with caps "Mawhorr 6690".

June 25, 2011

James D. Mawhorr
James D. Mawhorr
Reg. Surveyor No. 6690

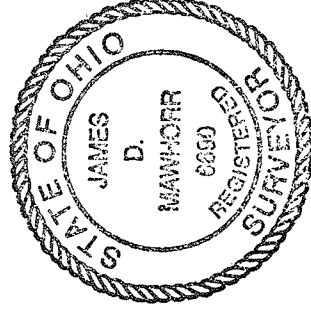

NEW SPLIT
RICHLAND COUNTY
TAX MAP OFFICE
EAY INITIAL 7-10-11
DATE CC-125