

⊙ = Iron Pin capped "LITTLE-5524"

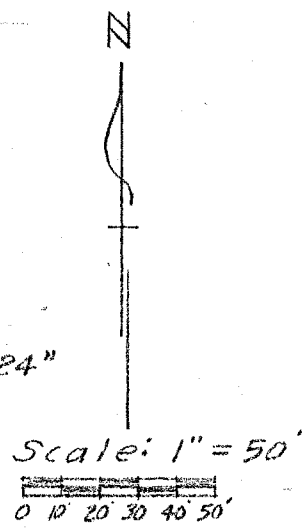

NEW SURVEY  
OF EXISTING PARCEL  
TAX MAP APPROVED  
E.A.N. 3-19-91  
INITIAL DATE

DRAWING OF SURVEY FOR WHATMAN REALTY  
PART OF LOT 122  
OF THE VILLAGE OF BELLVILLE  
RICHLAND COUNTY, OHIO

DRA 3-19-91  
INITIAL DATE  
TRANSFER APPROVED  
JACK REINER  
RICHLAND CO. AUDITOR

*Robert M. Little*  
Robert M. Little  
Registered Surveyor # Ohio 5524  
March 18, 1991

