

FENCE POST FOUND  
REF. = 32.06'  
M. & M. ARBITINA  
V-797 P-769

THE WEST LINE OF THE S.E. 1/4 SECTION 15

J. & D. REBMAN  
V-552 P-53

SURVEYED FOR TRANSFER  
7.00 AC.

J. STUDER  
V-882 P-638

THE S.W. CORNER OF THE S.E. 1/4 SECTION 15

THE PLACE OF BEGINNING

THE SOUTH LINE OF THE S.E. 1/4 SECTION 15

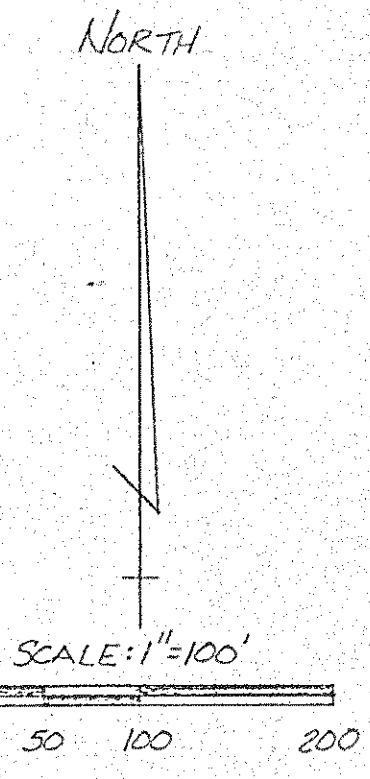

NOTE: BEARINGS ARE BASED ON AN ASSUMED MERIDIAN.

NOTE: ALL IRON PINS SET ARE 5/8" Ø REINFORCING BODS WITH I.D. CAPS "SEILER #6869.

*Douglas Seiler*  
SURVEY BY: DOUGLAS C. SEILER  
REG. SURVEYOR #6869  
52112 NORTH MAIN ST.  
MANSFIELD, OHIO  
(419) 525-3644



SURVEY PLAT FOR PROPERTY TRANSFER	
STUDER TO REBMAN	
PT. S.E. 1/4 SECTION 15, T-20, R-18 WASHINGTON TOWNSHIP RICHLAND COUNTY, OHIO	
DATE: JUNE 20, 1989	SCALE: 1"=100'
DRWG. NO.	DRWN. BY: JAA