

PT. OF SPRINGDALE ALLOTMENT
1 ACRE - S.W. $\frac{1}{4}$ - SECTION 13
WASHINGTON TOWNSHIP

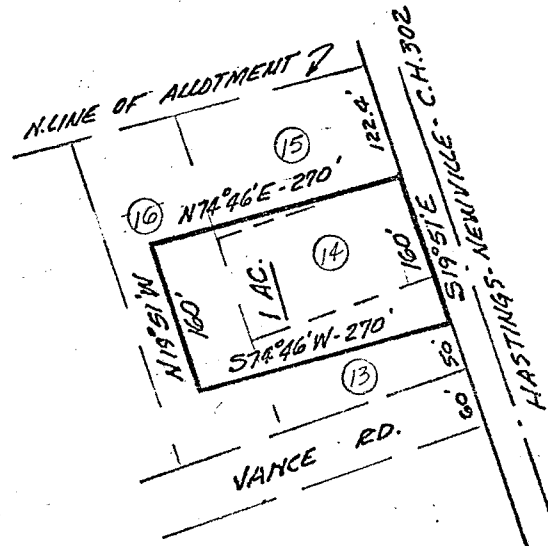

LEGAL DESCRIPTION: 1 ACRE

Situated in the Southwest quarter of Section 13, T.20, R.18 of Washington Township, Richland County, Ohio and being a part of lot nos. 13, 14, 15 and 16 of Springdale Allotment, recorded in plat volume 19, page 111 and being further described as follows.

Beginning at the Southeast corner of lot no. 15 of Springdale Allotment, said beginning point being S 19°51' E, 122.4 feet from the North line of the allotment as measured along the West right of way line of the Hastings - Newville Road, C.H. 302; thence S 19°51' E, along the West right of way line of the Hastings - Newville Road, 160 feet; thence S 74°46' W, parallel to the North line of the allotment, 270 feet; thence N 19°51' W, parallel to the West right of way line of the Hastings - Newville Road, 160 feet; thence N 74°46' E, parallel to the North line of the allotment, 270 feet to the place of beginning.

Containing 1 acre of land, more or less, and being subject to all easements and restrictions of record.....

Phillip Marcus

Phillip Marcus
Reg. Surveyor # 4518
May 4, 1977