

1450 Top of Bank
 Wooded Area 3'-6" Trees.

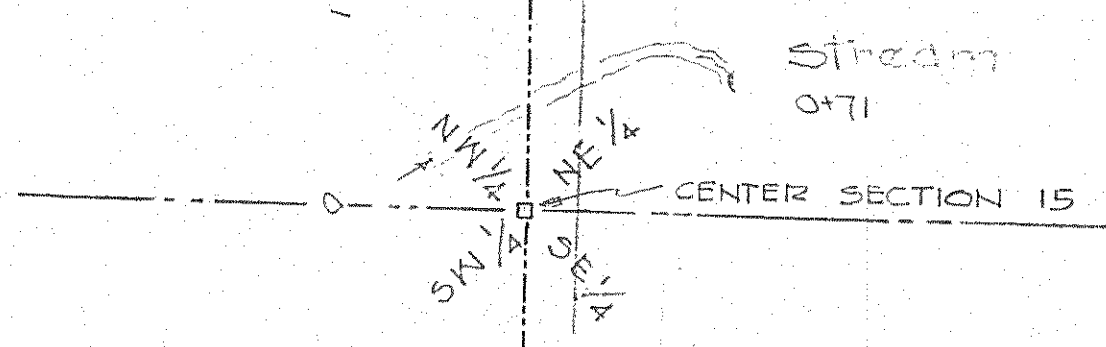

1+62
 Tree Line
 Pine Trees 2"-3"
 Wooded Area 24"-36" TREES

4+86.5
 LANE

W. COCKLEY 40 AC.
 Evergreens 8" to 10"
 "TRANSIT OFF-SET BASE LINE"

SECTION LINE

Scale: 1"=100'
 May 1962
 Ref: FB-27-62-286
 J.A. SELLER

8+22.4
 BEGIN RAIL FENCE
 Tree Line To East.

Wooded Area
 Trees 8-10"
 in Rows.

Tree Line

End Rail Fence 12+97.2
 PROPERTY LINE FENCE
 Pasture

STEVENS MANUFACTURING CO.
 160 AC +

O & A ECKERT
 100 AC.

Wooded Area
 24"-36" & Larger

18+13.6
 Begin Woods 24"-36"

19+84
 Top of Ravine
 24' Beech

Stream 21+49
 1/4 SECTION LINE

LEGEND
 ○ - INDICATES 1" IRON PIPE SET BY THIS SURVEY ON SECTION LINE AS PER AGREEMENT BETWEEN OWNERS, O & A ECKERT & K. STEVENS - 21 AUG. '62

24+91.5

25+99.5
 LEXINGTON-STEAMCORERS RD
 SOUTH LINE OF SECTION 15
 CH 53
 2100' 1047'

2627.60 to Spike on Centerline Texter Road
 2627.60 to J.J. Conning Survey Monument

Justin A. Sella
 Justin A. Sella
 Reg. Surveyor No. 4221
 4-15-62

SECTION LINE
 BETWEEN EAST & WEST HALF
 SECTION 15, TROY TWP
 RICHLAND COUNTY