

Wooded Area
3'-6" Trees.

1+50 Top of Bank

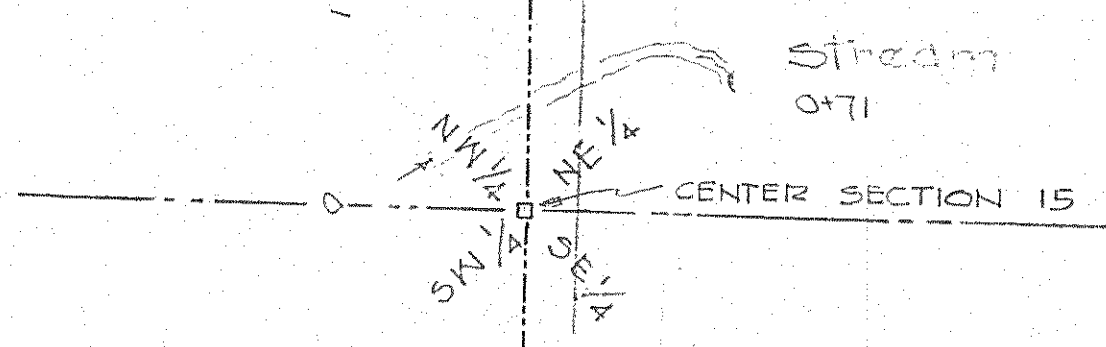

1+62

Tree Line

Wooded Area
24"-36" TREES

Pine Trees
2"-3"

4+86.5

LANE

NORTH

W. COCKLEY
40 AC.

"TRANSIT OFF-SET
BASE LINE"

Evergreens
8" to 10"

SECTION LINE

Scale: 1"=100'
May 1962
Ref: FB-27-62-286
JA Seller

8+22.4
BEGIN RAIL FENCE

Tree Line To East.

Wooded Area
Trees 8-10"
in Rows.

Tree Line

End Rail Fence
12+97.2
PROPERTY LINE FENCE

STEVENS MANUFACTURING CO.
160 AC +

Pasture

O & A ECKERT
100 AC.

Wooded Area
24"-36" & Larger

18+13.6

Begin Woods
24"-36"

24' Beech

19+84
Top of Ravine

Stream
21+49

1/4 SECTION LINE

LEGEND
● - INDICATES 1" IRON PIPE
SET BY THIS SURVEY ON
SECTION LINE AS PER
AGREEMENT BETWEEN
OWNERS, O & A ECKERT
& K. STEVENS - 21 AUG. '62

24+91.5

25+99.5

LEXINGTON-STEAMCORERS RD CH 53

SOUTH LINE OF SECTION 15

2100' 1047'

2627.60 to Spike on
Centerline Texter
Road

2627.60 to J.J. Conning
Survey Monument

Justin A. Seller
Reg. Surveyor No. 4221

SECTION LINE
BETWEEN EAST & WEST HALF
SECTION 15, TROY TWP
RICHLAND COUNTY

Rev. B-30-62