

1+50 Top of Bank
 Wooded Area 3'-6" Trees.

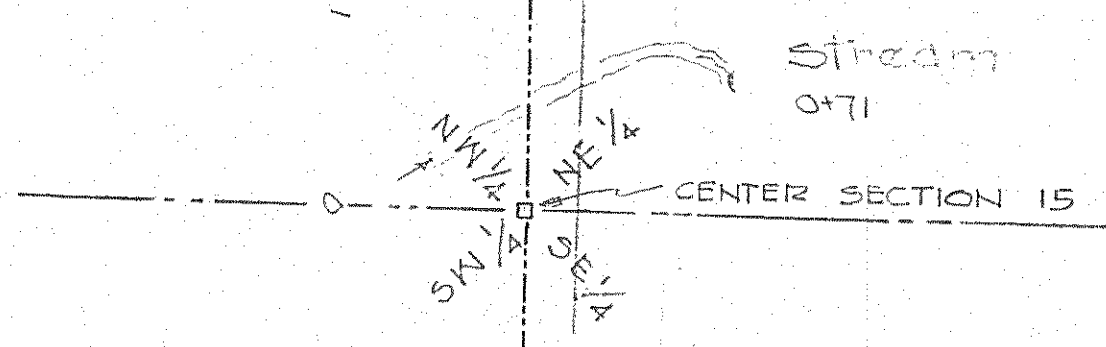

1+62
 Tree Line
 Pine Trees 2"-3"
 Wooded Area 24"-36" TREES

4+86.5
 LANE

W. COCKLEY 40 AC.
 Evergreens 8" to 10"
 "TRANSIT OFF-SET BASE LINE"

SECTION LINE

Scale: 1"=100'
 May 1962
 Ref: FB-27-62-286
 J.A. SELLER

8+22.4
 BEGIN RAIL FENCE
 Tree Line To East.

Wooded Area
 Trees 8-10"
 in Rows.

Tree Line

End Rail Fence 12+97.2
 PROPERTY LINE FENCE
 Pasture

STEVENS MANUFACTURING CO.
 160 AC +

O & A ECKERT
 100 AC.

Wooded Area
 24"-36" & Larger

18+13.6

19+00
 Begin Woods
 24"-36"

19+84
 Top of Ravine

24' Beech

Stream 21+49

1/4 SECTION LINE

LEGEND
 ○ - INDICATES 1" IRON PIPE SET BY THIS SURVEY ON SECTION LINE AS PER AGREEMENT BETWEEN OWNERS, O & A ECKERT & N. STEVENS - 21 AUG. '62

24+91.5

25+99.5

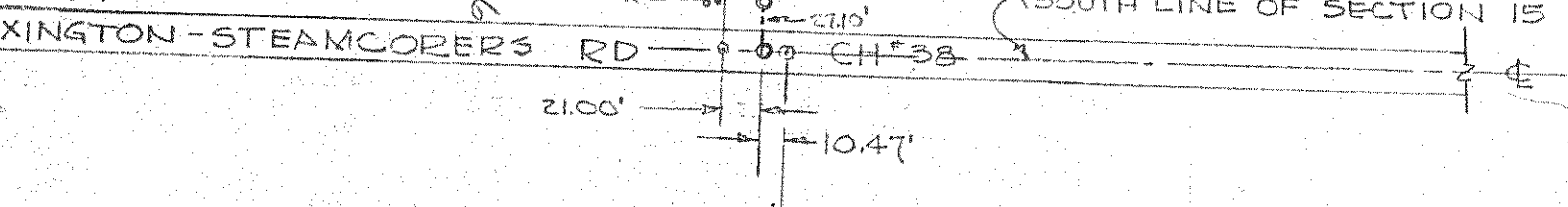

2627.60 to Spike on Centerline Texter Road

2627.60 to J.J. Conning Survey Monument

SECTION LINE BETWEEN EAST & WEST HALF SECTION 15, TROY TWP. RICHLAND COUNTY

Justin A. Sella
 Justin A. Sella
 Reg. Surveyor No. 4221
 4-15-62

Rev. B-30-62