

N.W. COR.
S.W. 1/4 SEC. 25

MILLSBORO RD. CH. 48
N. Line S.W. 1/4 SEC. 25

LEXINGTON-SPRINGMILL RD. CH. 133

1053.71 W. Line S.W. 1/4 SEC. 25

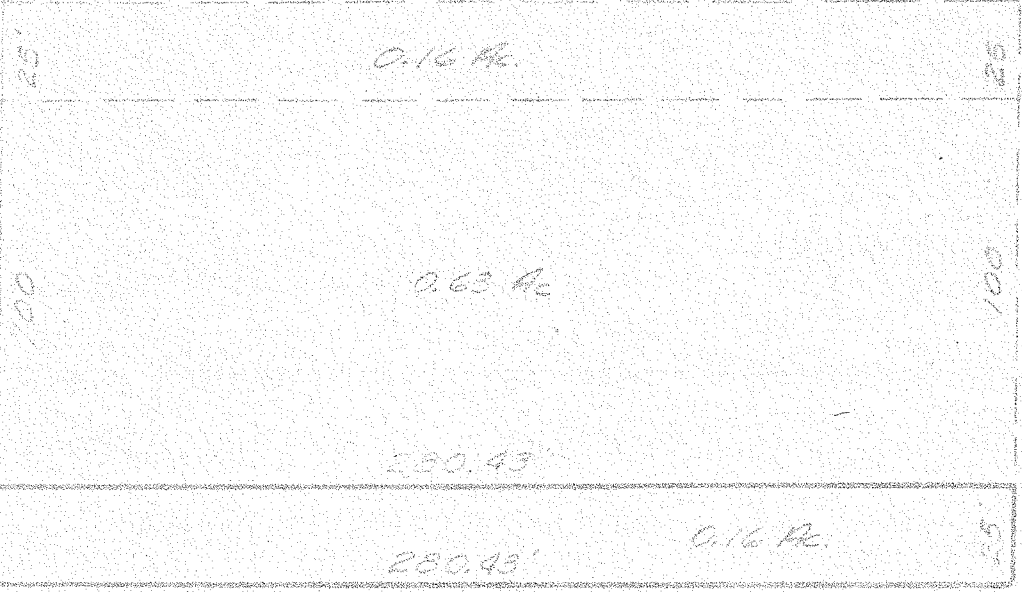

By: C.F. Rollins
C.F. Rollins
Surveyor # 4485

P L A T FOR

ROBERT J. BROOKER
Part of the S.W. 1/4 Sec. 25
Twp. 21 Ra. 19
Springfield Township
Richland County