

SHEET 2 OF 2
GENERAL INFORMATION FROM TAX MAPS AND CONSTRUCTION PLANS
 (To be Read in Conjunction with Right of Way Plan)

On S.R. 30 Sec. 3.92 Richland Co., O. Par. No. 89-WL, 89-WD, 89-T
 Prepared by Young August 19 70 On Property of Walter W. Willis & Lee C. Henry, Trustees
 (All statements below are from the plans as presently drawn within limits of captioned parcels)

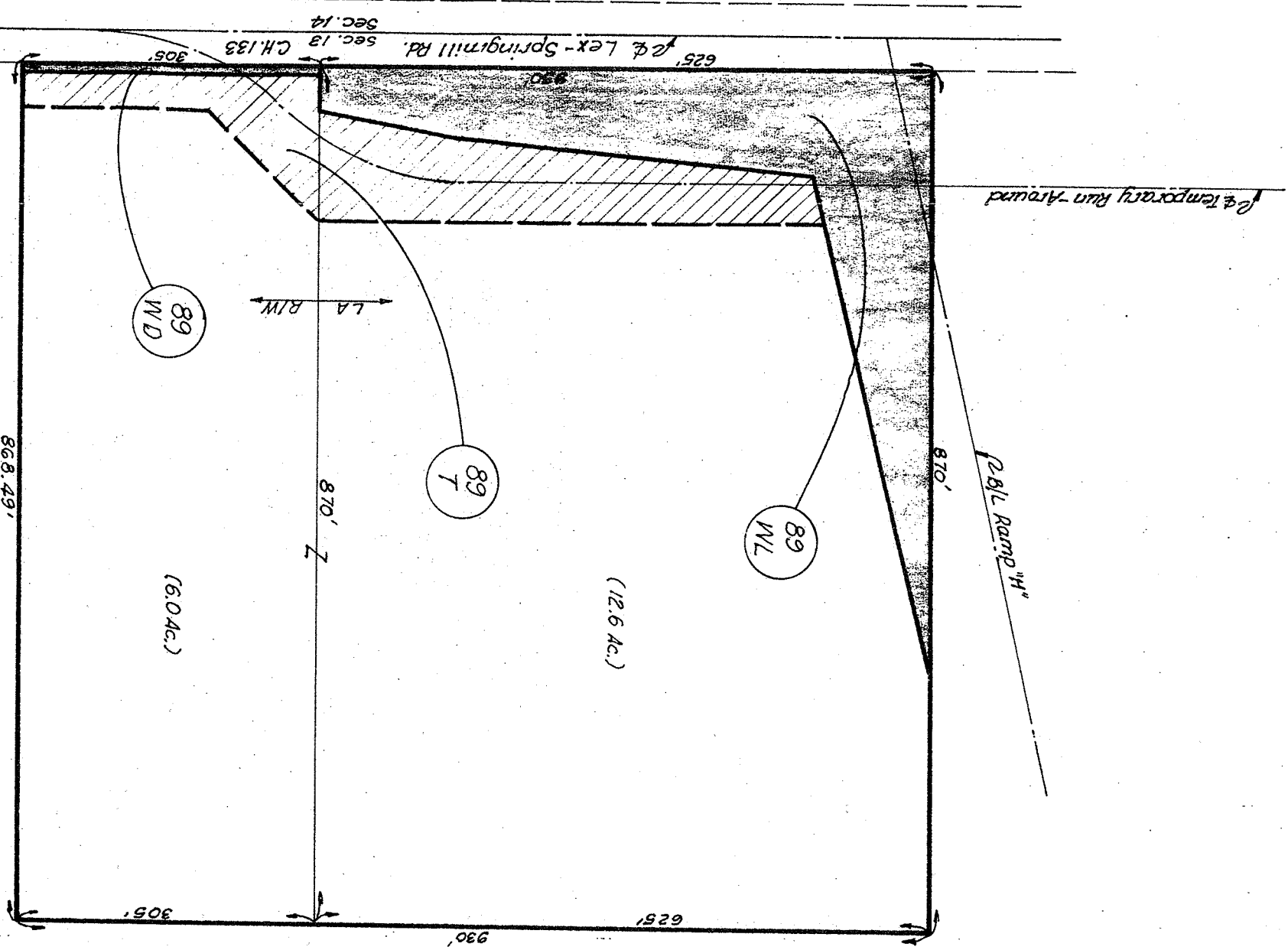

WHOLE PROPERTY 18.60 Ac.
 EXISTING R OF W -0-
 NET USABLE 18.60 Ac.

REMAINING NET
 16.54 Ac.

NONE

Par. No.	TAKE
89-WL	
89-WD	
89-T	

Area	
2.01 Ac.	
0.05 Ac.	
1.94 Ac.	<u>2.06</u>
(84,720 S.F.)	

DIVIDED