

I hereby certify that the above property has been surveyed by the engineers as recorded in the following Richland County Recorder's Records:

Volume 304, Page 204
 Volume 341, Page 118
 Volume 651, Page 224

I hereby certify that the easements and other as stated in Volume 702, Page 368 will not be pertinent when the BIZ Oil properties and the First National Bank properties are merged.

Robert A. Cuning, Reg. Surveyor No. 4939
 Date: 16 Jan 1992

WILCIUS A. PATTON AND RUTH PATTON, HUSBAND AND WIFE
 ONTARIO, OHIO

FIRST NATIONAL BANK OF MANSFIELD, PLYMOUTH, OHIO
 VOL. 797 P. 368
 14.0 Ac.

DESCRIPTION OF BRITISH PETROLEUM PROPERTY
 ONTARIO, OHIO

DESCRIPTION OF FIRST NATIONAL BANK PROPERTY
 ONTARIO, OHIO

PARCEL #1: Located in the Village of Ontario, County of Richland, State of Ohio, being part of the Northwest Quarter of Section 13, Township 21, Range 19, and more particularly described as follows:

Commencing at the Northwest corner of the Northwest Quarter of Section 13, thence South 07° 56' 41" West along the West line of said Quarter Section, being the centerline of Lexington-Springmill Road (County Highway #133) a distance of 1179.40 feet to a P.K. nail; thence South 89° 37' 19" East passing through a survey marker set at 400.0 feet to a P.K. nail; thence South 89° 37' 19" East passing through a survey marker set at 400.0 feet to a total distance of 868.04 feet to an iron pipe found; thence North 89° 37' 19" West passing through a survey marker set at 120.0 feet, a survey marker set at 198.00 feet and a survey marker set at 828.15 feet, a total distance of 1500.0 feet to a P.K. nail set at 828.15 feet, a total distance of 868.16 feet to the True Point of Beginning, containing 2.989 Acres or less, or which 0.138 Acres are within the street right of way.

PARCEL #2: Located in the Village of Ontario, County of Richland, State of Ohio, being part of the Northwest Quarter of Section 13, Township 21, Range 19, and more particularly described as follows:

Commencing at the Northwest corner of the Northwest Quarter of Section 13, thence South 07° 56' 41" West along the West line of said Quarter Section, being the centerline of Lexington-Springmill Road (County Highway #133) a distance of 1179.40 feet to a P.K. nail; thence South 89° 37' 19" East passing through a survey marker set at 400.0 feet to a P.K. nail; thence South 89° 37' 19" East passing through a survey marker set at 400.0 feet to a total distance of 868.04 feet to an iron pipe found; thence North 89° 37' 19" West passing through a survey marker set at 120.0 feet, a survey marker set at 198.00 feet and a survey marker set at 828.15 feet, a total distance of 1500.0 feet to a P.K. nail set at 828.15 feet, a total distance of 868.16 feet to the True Point of Beginning, containing 2.989 Acres or less, or which 0.138 Acres are within the street right of way.

PARCEL #3: Located in the Village of Ontario, County of Richland, State of Ohio, being part of the Northwest Quarter of Section 13, Township 21, Range 19, and more particularly described as follows:

Commencing at the Northwest corner of the Northwest Quarter of Section 13, thence South 07° 56' 41" West along the West line of said Quarter Section, being the centerline of Lexington-Springmill Road (County Highway #133) a distance of 1179.40 feet to a P.K. nail; thence South 89° 37' 19" East passing through a survey marker set at 400.0 feet to a P.K. nail; thence South 89° 37' 19" East passing through a survey marker set at 400.0 feet to a total distance of 868.04 feet to an iron pipe found; thence North 89° 37' 19" West passing through a survey marker set at 120.0 feet, a survey marker set at 198.00 feet and a survey marker set at 828.15 feet, a total distance of 1500.0 feet to a P.K. nail set at 828.15 feet, a total distance of 868.16 feet to the True Point of Beginning, containing 2.989 Acres or less, or which 0.138 Acres are within the street right of way.

PARCEL #4: Located in the Village of Ontario, County of Richland, State of Ohio, being part of the Northwest Quarter of Section 13, Township 21, Range 19, and more particularly described as follows:

Commencing at the Northwest corner of the Northwest Quarter of Section 13, thence South 07° 56' 41" West along the West line of said Quarter Section, being the centerline of Lexington-Springmill Road (County Highway #133) a distance of 1179.40 feet to a P.K. nail; thence South 89° 37' 19" East passing through a survey marker set at 400.0 feet to a P.K. nail; thence South 89° 37' 19" East passing through a survey marker set at 400.0 feet to a total distance of 868.04 feet to an iron pipe found; thence North 89° 37' 19" West passing through a survey marker set at 120.0 feet, a survey marker set at 198.00 feet and a survey marker set at 828.15 feet, a total distance of 1500.0 feet to a P.K. nail set at 828.15 feet, a total distance of 868.16 feet to the True Point of Beginning, containing 2.989 Acres or less, or which 0.138 Acres are within the street right of way.

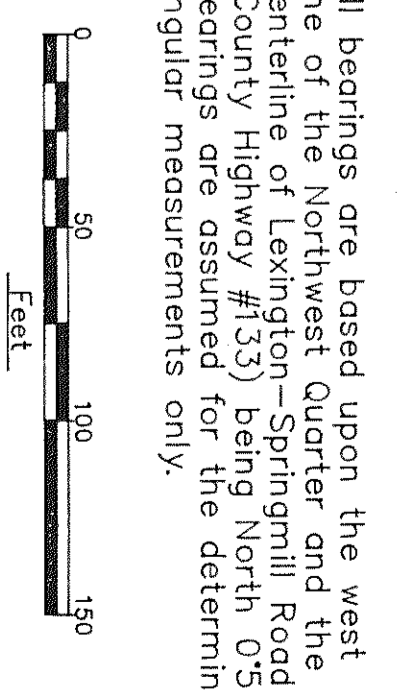
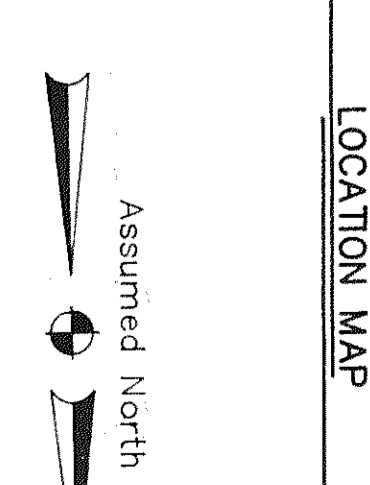
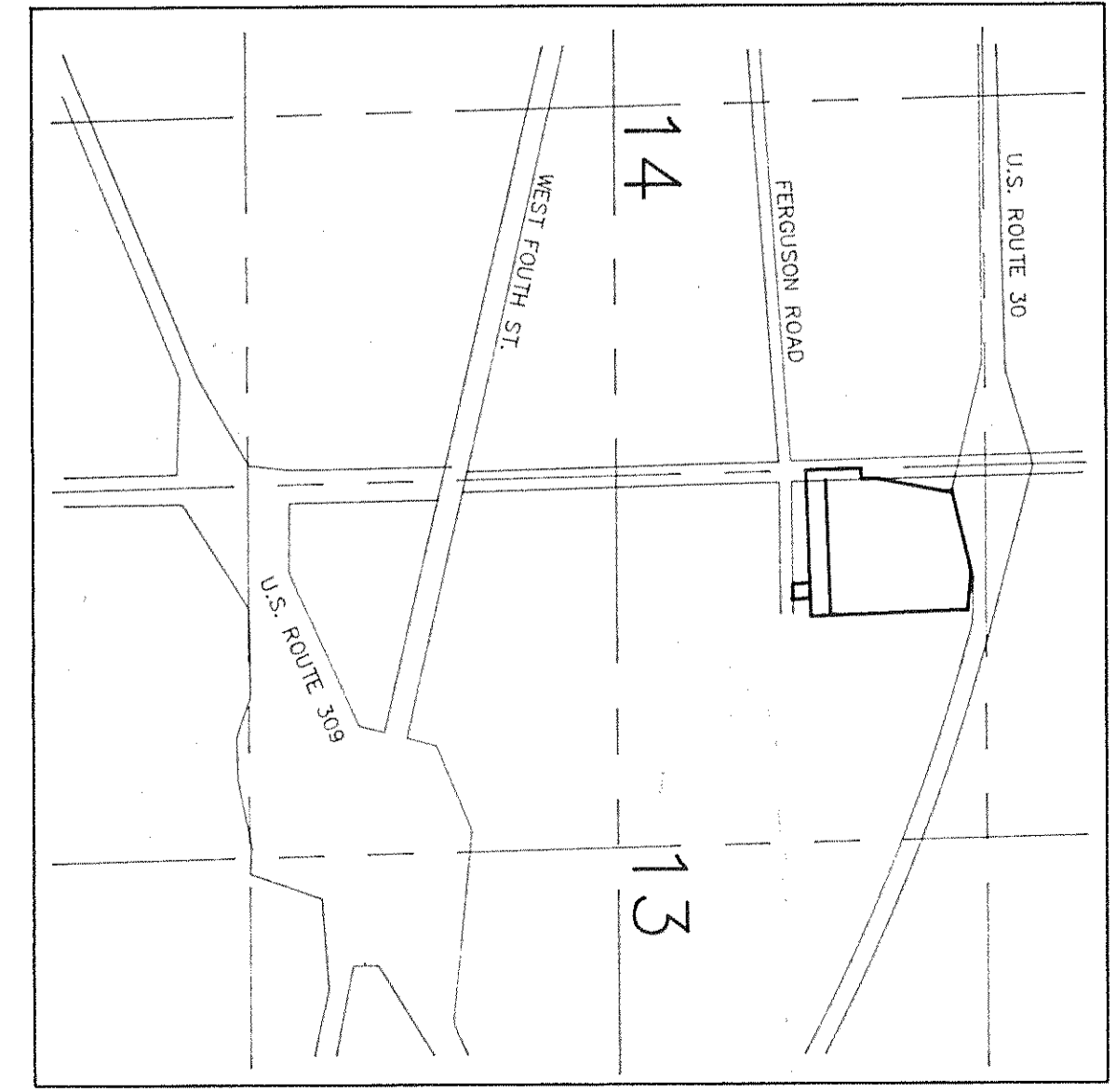

All bearings are based upon the west line of the Northwest Quarter and the centerline of Lexington-Springmill Road (County Highway #133) being North 0°56'41" East. Bearings are assumed for the determination of angular measurements only.

Robert A. Cuning, Reg. Surveyor No. 4939
 Date: 16 Jan 1992

RICHLAND ENGINEERING LIMITED
 MANSFIELD, OHIO

Property Survey
 for
SOUTH & ASSOCIATES, INC.
 Being Part of N.W. 1/4, Sec. 13
 Twp. 21, R. 19, Springfield Twp., Village
 of Ontario, Richland County, Ohio

DESIGNED: [Signature] CHECKED: [Signature] DATE: [Signature]
 DRAWN: [Signature] REVISIONS: [Signature]



951.18' D.
 S 00°53'52" W

S.C. Scott
 VOL. 880 P. 345

PRINTED
 JAN 16 1992

NEW SURVEY
 OF EXISTING PARCEL
 TAX MAP APPROVED
 DATE: 1/16/92

MON. FND
 Plan Sta. 387+79.00

Northwest Corner,
 Northwest Quarter,
 Section 13

U.S. ROUTE 30
 FERGUSON ROAD
 WEST FOURTH ST.
 U.S. ROUTE 308

969.40'
 N 00°56'41" E 244.72'
 0.280 Ac.
 N 09°56'41" E 304.72' D.
 0.138 Ac.
 40.01'
 260.00'
 220.00'
 260.00'
 160.00'
 60.00'
 40.01'
 80.01'
 N 89°52'41" E
 100.42'
 40.00'
 60.53'
 S 01°20'17" W
 20.41'

1119.40'
 150.00'
 0.138 Ac.
 40.01'
 119.40'

MON. FND
 Plan Sta. 374+58.47
 Plan Sta. 374+58.17

VILLAGE OF ONTARIO
 HIGHWAY EASEMENT
 VOL. 651, P. 210

T. & A. EVANS
 VOL. 533 P. 615

A.E. SHUAKER
 VOL. 660 P. 87

M. & T. BOND
 O.R. VOL. 70 P. 709

R. & H. HOSKEY
 VOL. 741 P. 563

W.A. & R. PATTON
 VOL. 744 P. 549
 2.989 Ac.

W.A. & R. PATTON
 VOL. 803 P. 651
 0.267 Ac.

C. & N. FLOWERS
 VOL. 357 P. 560

120'
 75.00'
 N 89°37'19" W
 150.00'

181'
 100'
 100'
 132'

FERGUSON ROAD
 T.H. 202 (50')

NORTH RIGHT OF WAY LINE OF FERGUSON RD.

R/W