

DESCRIPTION  
FOR  
CLIFF HARVEY

Located in the Township of Monroe, County of Richland, State of Ohio and being a part of the Southwest Quarter of Section 28, Township 22, Range 17 and more particularly described as follows:

Beginning at a railroad spike set in the Northwest Corner of the Southwest Quarter of Section 28.

Thence S 87° 57' 21" E along the north line of the Southwest Quarter of Section 28 a distance of 435.69 feet to a fence post found.

Thence S 20° 06' 49" E a distance of 389.1 feet.

Thence S 50° 11' 49" E a distance of 324.02 feet.

Thence S 9° 04' 42" W a distance of 606.75 feet to an iron pin set.

Thence S 41° 53' 40" E a distance of 214.06 feet to an iron pin set.

Thence S 24° 10' 28" W a distance of 598.20 feet to an iron pin set.

Thence S 00° 16' 05" E a distance of 545.0 feet to an iron pin set.

Thence <sup>V.D.E.</sup> West a distance of 622.87 feet to an iron pin set on the west line of the Southwest Quarter of Section 28.

Thence N 00° 00' 05" W along the west line of said quarter a distance of 1194.56 feet to an iron pin found.

Thence N 89° 59' 55" E a distance of 200.0 feet to an iron pin found.

Thence N 00° 00' 05" W a distance of 225.0 feet to an iron pin found.

Thence S 89° 59' 55" W a distance of 125.0 feet to an iron pin found.

Thence N 06° 53' 06" W a distance of 71.52 feet.

Thence S 63° 38' 05" E a distance of 665.6 feet.

Thence N 11° 36' 40" E a distance of 370.28 feet.

Thence N 46° 17' 35" W a distance of 637.5 feet.

Thence N 82° 30' 05" W a distance of 278.89 feet to a point on the west line of the Southwest Quarter of Section 28.

Thence N 00° 00' 05" W along the west line of said quarter a distance of 403.0 feet to the place of beginning and containing 28.431 acres more or less but subject to all legal highways also all easements of record.

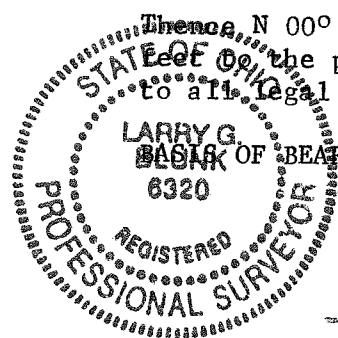

BEARINGS: Survey by John Napier, dated 2-25-78

APPROVED  
TAX MAP OFFICE  
E.A.N. 10-16-90  
INITIAL DATE

*Larry G. Blunk*  
Larry G. Blunk, Registered Surveyor #6320  
March 20, 1989

EASEMENT FOR GAS LINE  
FOR  
CLIFF HARVEY

LOCATED IN THE TOWNSHIP OF MONROE, COUNTY OF RICHLAND, STATE OF OHIO AND BEING A PART OF THE SOUTHWEST QUARTER OF SECTION 28, TOWNSHIP 22, RANGE 17 AND MORE PARTICULARLY DESCRIBED AS FOLLOWS:

BEGINNING AT A RAILROAD SPIKE SET IN THE NORTHWEST CORNER OF THE SOUTHWEST QUARTER OF SECTION 28.

THENCE S 87° 57' 21" E ALONG THE NORTH LINE OF THE SOUTHWEST QUARTER OF SECTION 28 A DISTANCE OF 435.69 FEET TO A FENCE POST FOUND.

THENCE S 20° 06' 49" E A DISTANCE OF 389.1 FEET.

THENCE S 50° 11' 49" E A DISTANCE OF 324.02 FEET.

THENCE S 09° 04' 42" W A DISTANCE OF 596.55 FEET TO THE TRUE PLACE OF BEGINNING.

THENCE S 69° 27' 40" E A DISTANCE OF 547.03 FEET.

THENCE S 20° 32' 20" W A DISTANCE OF 20.0 FEET.

THENCE N 69° 27' 40" W A DISTANCE OF 525.84 FEET.

THENCE N 41° 53' 40" W A DISTANCE OF 21.61 FEET.

THENCE N 09° 04' 42" E A DISTANCE OF 10.2 FEET TO THE TRUE PLACE OF BEGINNING.

BASIS OF BEARINGS: SURVEY BY JOHN NAPIER, DATED 2-25-78.

  
LARRY G. BLUNK, REGISTERED SURVEYOR #6320  
MARCH 20, 1989

