

SHAFFER, JOHNSTON, LICHTENWALTER & ASSOCIATES

SURVEYORS

K.D. BLINNERS

NE 1/4 Sec 20
T43N R26E

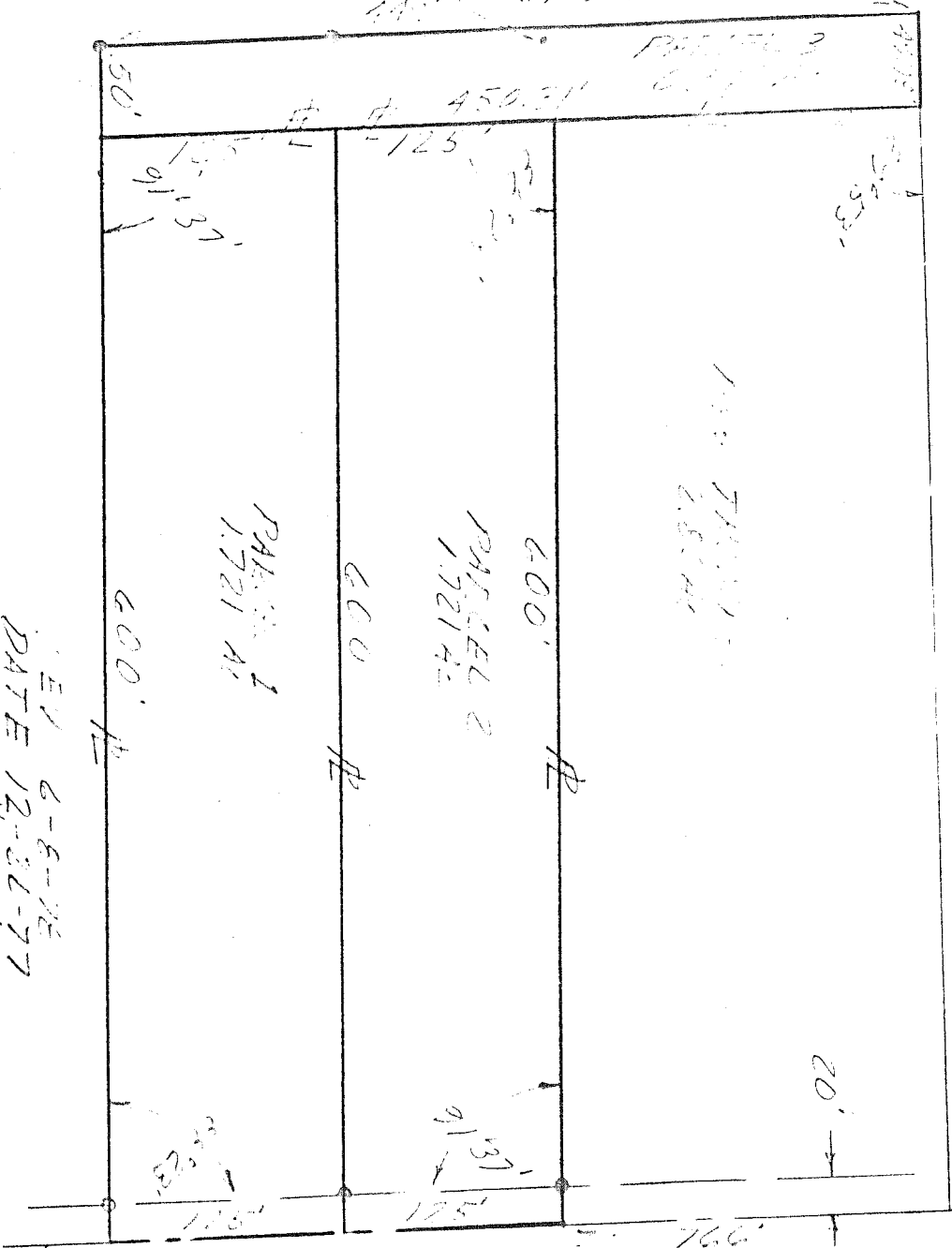

BEING PT NW 1/4 SEC 20
T43N R26E

E.V. 6-8-76
DATE 12-30-77
IRON PIN SET
0-IRON PIN FOUND

[Signature]
LYLE V BAKER
REG SURVEYOR #56116
SM. 374

6701 COLUMBIAN AVE. CLEVELAND, OHIO 44103
216-348-1374

2585 CLEVELAND ROAD, WOOSTER, OHIO 44691
216-348-0377