

CURVE DATA
 P.I. Sta. 5+40.64
 Δ = 28° 06' L
 D = 6' 00"
 P = 924.95'
 L = 468.33'
 T = 238.98'

Scale: 1"=50'
 Date: Jan 58

I, Justin A. Sailer, hereby certify that I surveyed the property shown hereon on Nov 23rd, 1957, and that the plat is a true representation thereof.

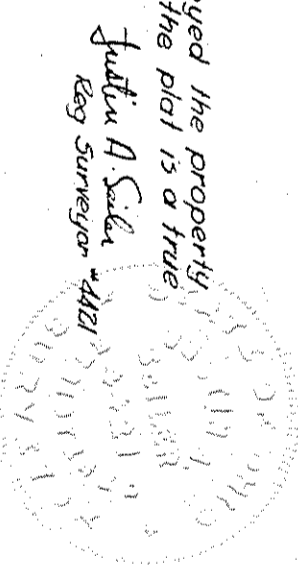

W & D
 WRIGHT