

N.E. CORNER  
N.W. 1/4 SEC. 8

1425.12'

N89°20'W

GARRETT  
VOL 550 P167

120.2'  
S02°03'E

I.P. SET

I.P. FD. 113.9'

S66°22'E 118.04'

N65°49'15"W

I.P. FD. 20'

I.P. FD.

0.61 AC.

V 498 P 308  
RECORDED AS 0.552 AC

W.L. MELIGAN  
VOL 808 P 448

I.P. SET

N76°32'W  
11.03'

P.K. NAILS  
SET &  
T.H. 270

N55°27'W 95.0'

I.P. FD.

FLEMMING FALLS RD  
T.H. 270

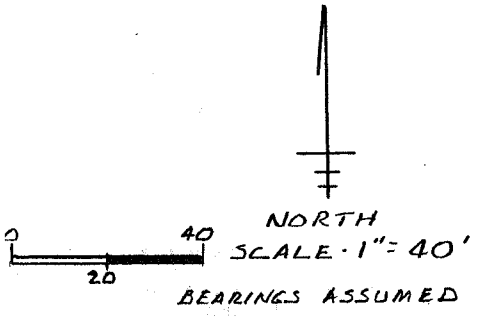

I.P. FD. = IRON PIPE FOUND  
I.P. SET = IRON PIN SET

SURVEY PLAT OF 0.61 AC.  
PART OF N.W. 1/4 SEC 8 T23 R18  
MIFFLIN TOWNSHIP  
RICHLAND CO. OHIO

SURVEY FOR E. HOAGLAND  
BY  
JAMES D. MAWHORR  
REG. SURVEYOR NO. 6690

BEING SAME PARCEL AS  
RECORDED VOL 498 P 308