



RANGE 5 W. T. SEC. 25

1220.45'
S 32° 22' E

PL. CURVE PT.

CURVE
D = 57° 30'
R = 5789.58

By James B. Roberts
Surveyor # 4279

N 51° 38' E
1229.15'

O.C.C.A.C.

629.15' W
S 55° 50' E

1000.0'
N 32° 22' W

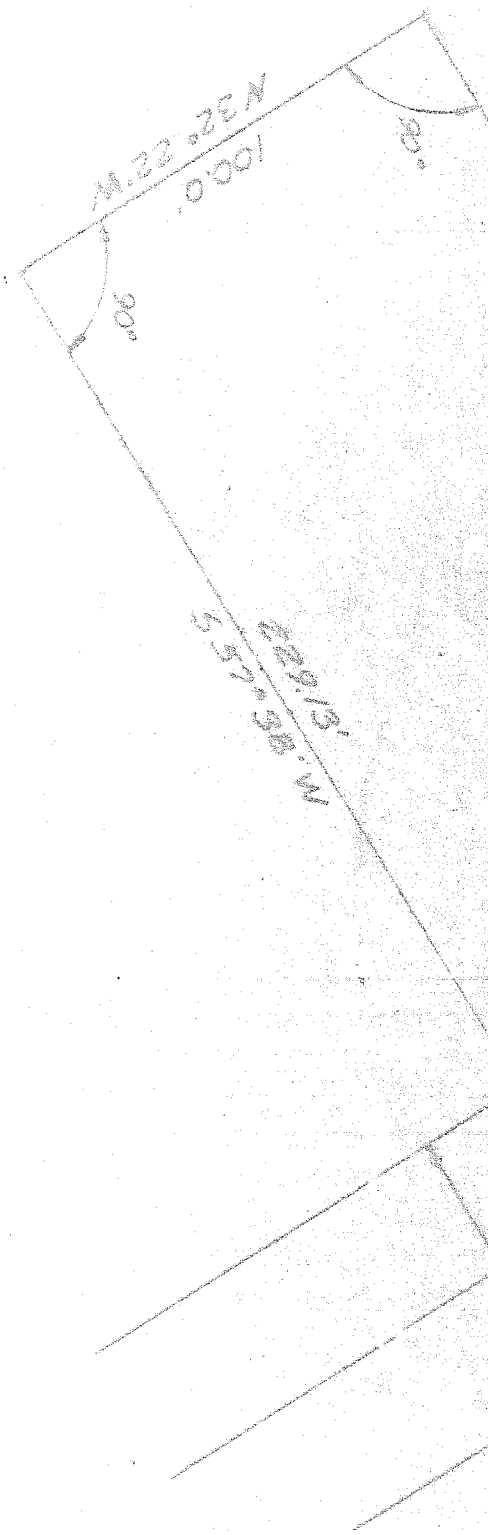

P L A T O R S U R V E Y
for

W. WARNER
part of the S.W. 1/4 section 25
Twp. 21 N., R. 18 W.,
Michigan County