

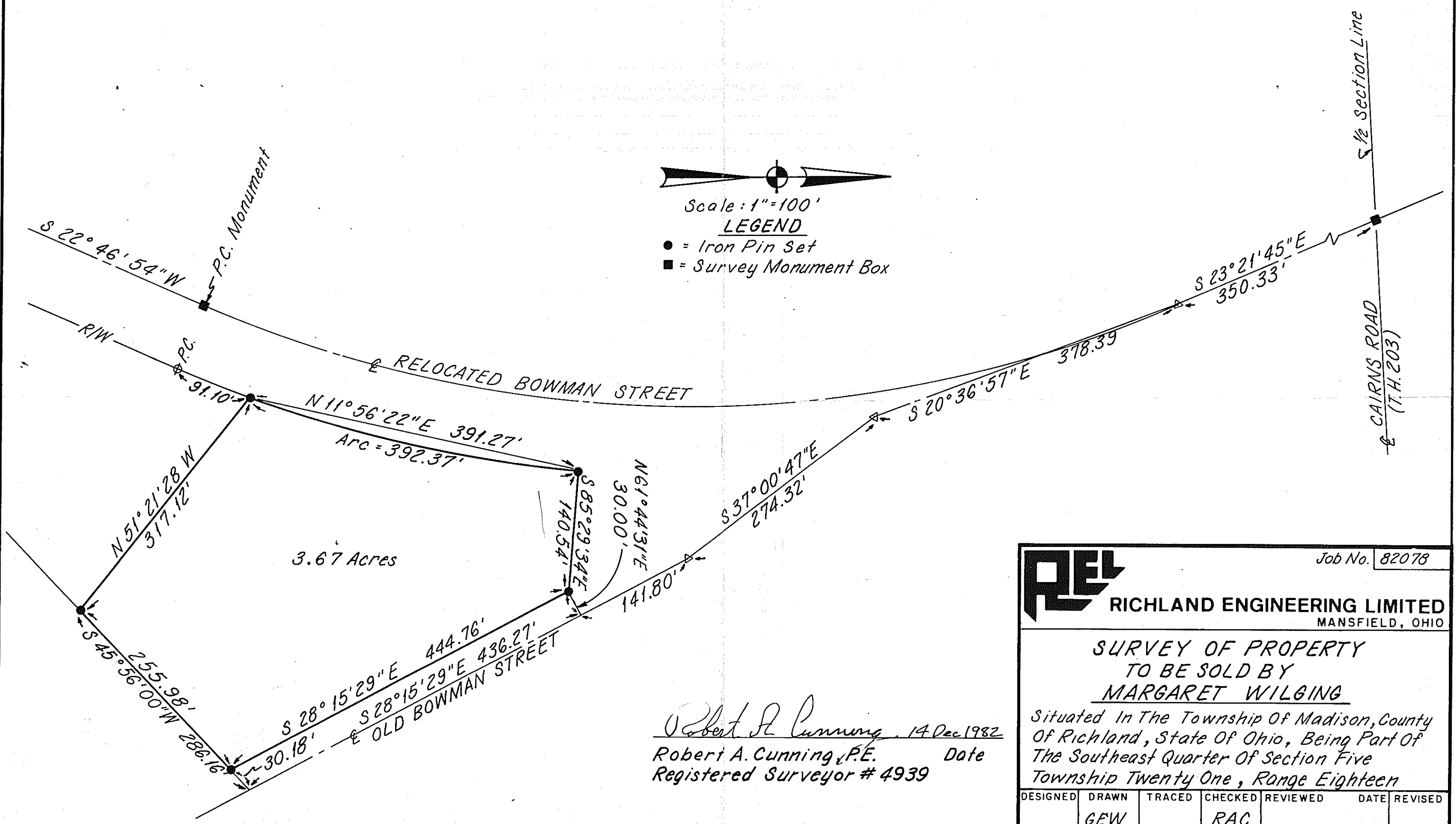

Scale: 1"=100'

LEGEND

- = Iron Pin Set
- = Survey Monument Box



3.67 Acres

Robert A. Cunningham 14 Dec 1982
 Robert A. Cunningham, P.E. Date
 Registered Surveyor # 4939

RE		Job No. 82078	
		RICHLAND ENGINEERING LIMITED MANSFIELD, OHIO	
SURVEY OF PROPERTY TO BE SOLD BY MARGARET WILGING			
Situating In The Township Of Madison, County Of Richland, State Of Ohio, Being Part Of The Southeast Quarter Of Section Five Township Twenty One, Range Eighteen			
DESIGNED	DRAWN	TRACED	CHECKED
	GEW		RAC
REVIEWED	DATE	REVISED	