

# **PLAT OF SURVEY FOR** **JAMES T. & LADONNA LOTZ**

SOUTHWEST QUARTER OF SECTION 32  
JEFFERSON TWP., RICHLAND CO. OHIO

## **LEGEND**

○ IRONPIN FND.  
● IRONPIN SET

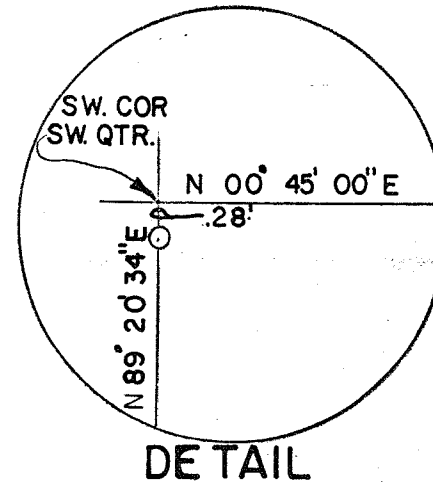
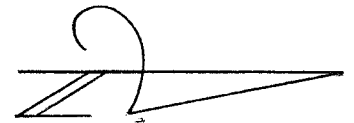

**SCALE 1"=200'**

## **SURVEYOR'S CERTIFICATION**

I hereby certify this description was prepared from a survey made by the office of Raiké Associates, Inc., Architects, Engineers, Surveyors and Donald S. Vermilya, Registered Surveyor No. 5695, and is a true and accurate representation thereof.

*Donald S. Vermilya*  
Donald S. Vermilya  
Registered Surveyor No. 5695