

PLAT OF BOUNDARY SURVEY

CAROL ENGEL

PART OF THE SOUTHEAST QUARTER, SECTION THIRTY-FIVE (35)  
TOWNSHIP TWENTY-TWO (22), RANGE NINETEEN (19), JACKSON TWP. &  
PART OF THE NORTHEAST QUARTER, SECTION TWO (2)  
TOWNSHIP TWENTY-ONE (21), RANGE NINETEEN (19), SPRINGFIELD TOWNSHIP  
RICHLAND COUNTY, OHIO

REVIEW 12/31/96  
Approved Parcel + Pa.

Greg A. Jan  
Zoning Inspector 12/19/96

APPROVED BY THE MANHFIELD CITY PLANNING COMMISSION;  
PLAT REQUIRED.  
SIGNED: [Signature]  
SECRETARY, CITY PLANNING COMMISSION;  
DATE: 1-17-97

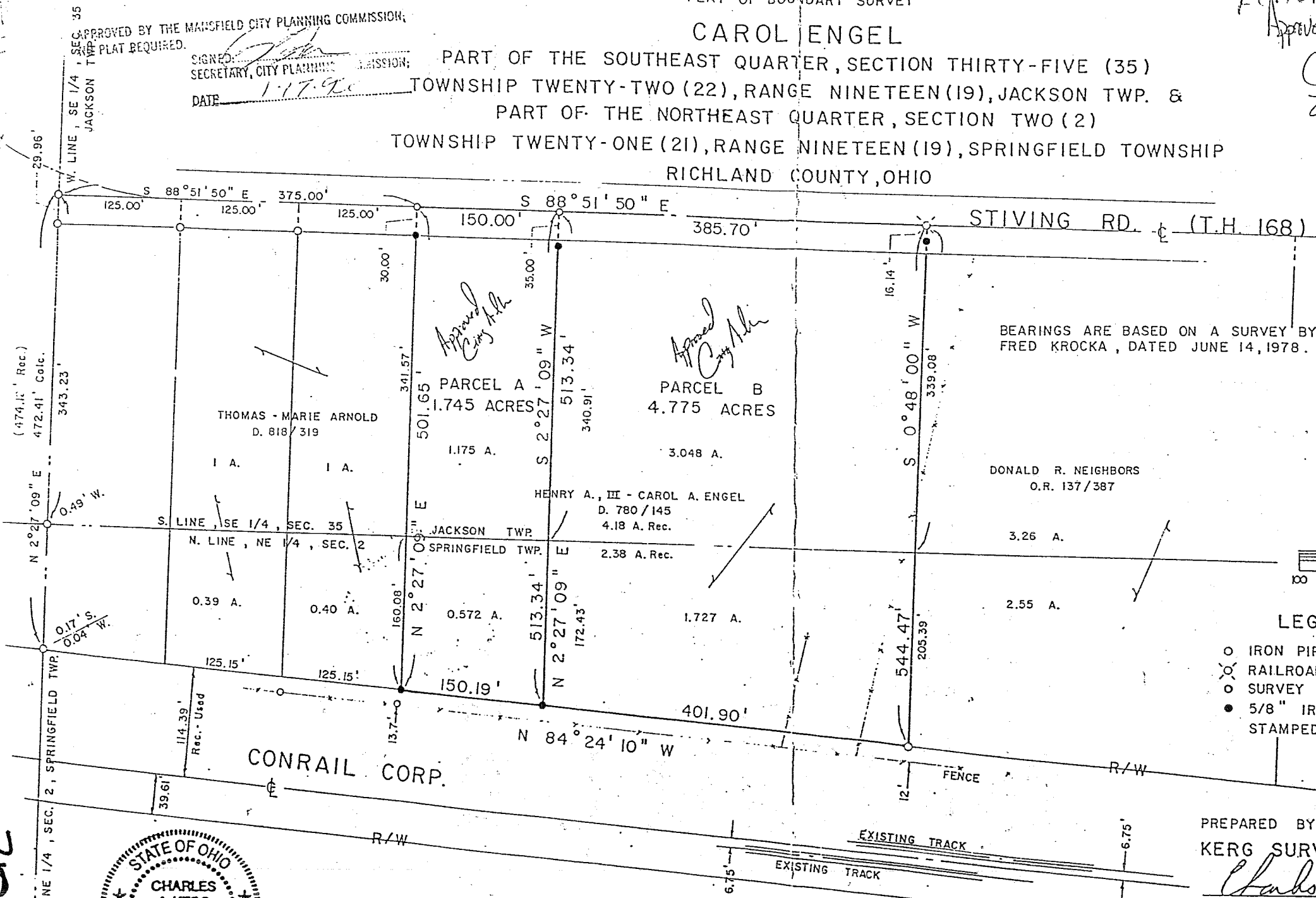

BEARINGS ARE BASED ON A SURVEY BY  
FRED KROCKA, DATED JUNE 14, 1978.

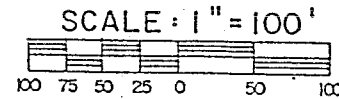

LEGEND

- IRON PIPE FOUND
- ⊗ RAILROAD SPIKE FOUND
- SURVEY SPIKE SET
- 5/8" IRON PIN SET WITH CAP STAMPED "C. KERG, RLS 7152"

PREPARED BY  
KERG SURVEYING

[Signature]  
CHARLES A. KERG  
REGISTERED OHIO SURVEYOR NO. 7152  
DATE: AUGUST 16, 1994



"The grantor, grantee and all subsequent owners  
or assignees taking title from, under or through the  
grantor or grantee agrees that any use or improve-  
ment made on this land shall be in conformity with  
the zoning ordinance of the City of Mansfield, Ohio."

NEW SPLIT  
TAX MAP APPROVED  
1-17-97

NEW SURVEY  
OF EXISTING PARCEL  
TAX MAP APPROVED

H-312

4312