

PLAT OF PROPERTY SURVEY

LEWIS T. & ELSIE MARSHALL

PART OF THE SOUTHWEST QUARTER OF SECTION TWENTY-TWO (22)
 TOWNSHIP TWENTY-TWO (22), RANGE NINETEEN (19)
 JACKSON TOWNSHIP, RICHLAND COUNTY, OHIO

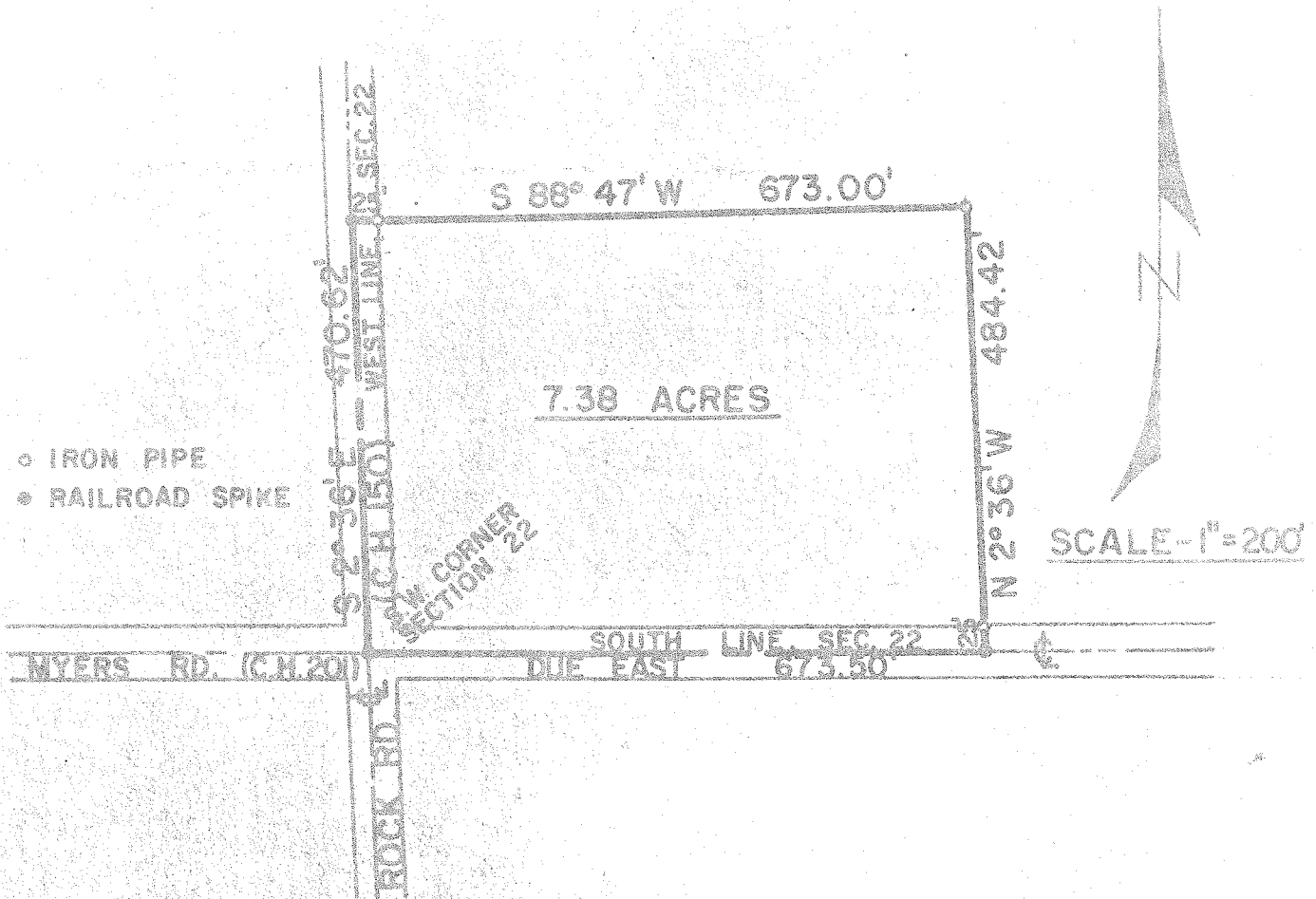

DESCRIPTION: Being part of the Southwest Quarter of Section Twenty-two (22), Township Twenty-two (22), Range Nineteen (19), Jackson Township, Richland County, Ohio and being more particularly described as follows:

Beginning for the same at a railroad spike in the intersection of Rock Road (County Highway No. 150) and Myers Road (County Highway No. 201) which intersection is the southwest corner of the Southwest Quarter of Section Twenty-two (22) thence due east along the centerline of Myers Road a distance of 673.50 feet to a railroad spike; thence N 2°36' W on a line parallel to the centerline of Rock Road (west line Section Twenty-two) a distance of 484.42 feet to an iron pipe; thence S 88°47' W a distance of 673.00 feet to a railroad spike in the centerline of Rock Road; thence S 2°36' E along the centerline of Rock Road a distance of 470.62 feet to a railroad spike which is the real point of beginning and containing 7.38 acres, more or less, but subject to all legal easements and public right-of-ways now on record.