

9 87° E 400.1'

239.5'

2.33 ACRES.

268.8'

NORTH

N 3° E 305'

S 82° 40' E 401.2'

GRANTOR: RUSSELL E BRICKER
GRANTEE: D. RENZ
2.67 ACRES.

N 87° W 400.1'
345.4'

268.8
268.8
544.5

SCALE: 1" = 100'
REF. NO: FB-65-64
DRAWN BY: JAS.

JACKSON TWP
FRANKLIN TWP.

12' EASEMENT
DRIVEWAY

EXISTING GRAVELED
LANE

12' EASEMENT
DRIVEWAY

THE SE CORNER
OF THE NE 1/4
SECTION 1

THE PLACE OF
BEGINNING

TOWNSHIP LINE

THE SOUTH LINE OF THE NE 1/4 SEC. 12

LEGEND
INDICATES IRON PINS
SET BY THIS SURVEY
ON THE CORNERS OF
THIS SURVEY

THIS SURVEY WAS MADE FOR AND AT
THE REQUEST OF R.E. BRICKER.

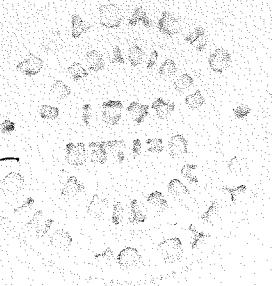
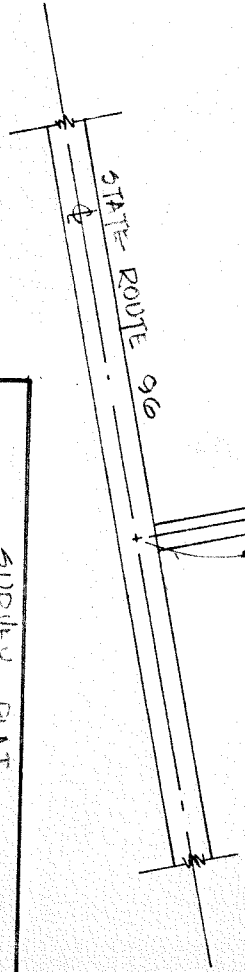

SURVEY BY: *Justin A. Skiller*
JUSTIN A. SKILLER - DATE 2-27-65
REG. SURVEYOR # 4421

SURVEY PLAT
FOR TRANSFER OF PROPERTY
GRANTOR: RUSSELL E. BRICKER
GRANTEE: D. RENZ
PART NE 1/4 SECTION 1
JACKSON TOWNSHIP
RICHLAND COUNTY, OHIO
DATE: FEB. 27, 1965 DDANN01 6643