

SURVEY FOR

**KENNETH BAKER**

PT. N.W. 1/4 SEC. 33

CASS TWP.

RICHLAND CO.

OHIO

SEC. 29

SEC. 28

WEST  
489'

BISTLINE RD

T.H. 186

SEC. 32 S 1° 38-1/4' E  
SEC. 33 442.08'

5.44 A.

488.65'  
N 7° 14' W

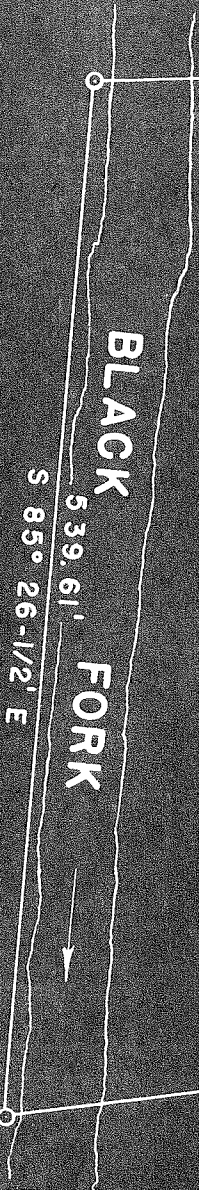

IRON PIPES MARK ALL  
CORNERS INDICATED BY "o"

*Charles P. Blower*  
REG. SURVEYOR # 3485  
May 12, 1948 DATE