

Part of the N.E. 1/4, S. W. 1/4 of Section 13, T. 23N., R. 19W. in Cass Township, Richland County, Ohio. Said part being further described as follows:

Commencing at a stone at the center of said Section 13; thence S.1°23' W. along the east line of the S.W. 1/4 of said Section, 245.2 feet to a stone; thence N. 88°30' W. 827.10 feet to a "PK" nail in the centerline of County Highway #207, being the point of beginning; thence S.4°12'30" E. along said centerline, 116.50 feet to a "PK" nail; thence S.85°47'30" W. at right angles to said centerline, 30.0 feet to a 3/4" pipe on the west right of way line of County Highway #207; thence continuing S.85°47'30" W. 100.00 feet to a 3/4" pipe; thence N. 4°12'30" W. parallel to the aforesaid centerline, 129.47 feet to a 3/4" pipe; thence S. 88°30' E. 100.50 feet to a 3/4" pipe, with a cap, on the west right of way line of said County Highway #207; thence continuing S. 88°30' E. 30.15 feet to the point of beginning, containing 0.29 acres, more or less, exclusive of the east 30 feet of the above-described land now used for roadway purposes.

Bearings used in above description are magnetic.

I Herely Certify that the accompanying plat correctly represents the results of a land survey made under my direction.

Checked for location of *Armed P. Muehlberg* Registered Ohio Land Surveyor #5104

Site - *AKA* Initials *AKA* Date *6/18/65*  
 Cable - Initials *AKA* Date *6/18/65*

*Armed P. Muehlberg*  
 Registered Ohio Land Surveyor #5104  
 Date *June 15, 1965*

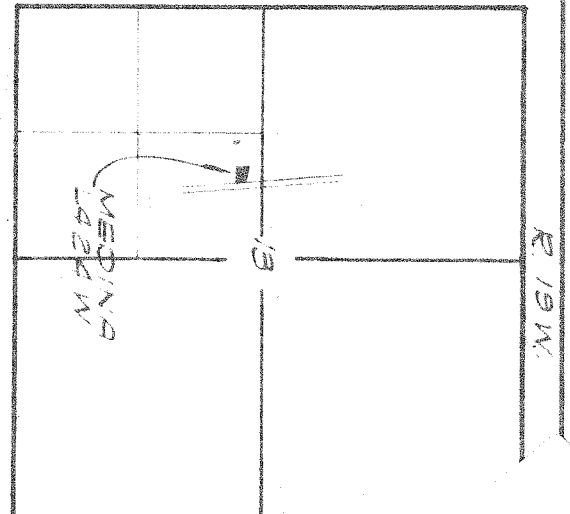

LOCATION MAP  
 SCALE 1" = 2000'

AT & T CO LONG LINES DEPT.  
 SURVEY PLAT  
 MEDINA L424W SITE  
 SEC. 13, T.23N. R.19W.  
 CASS TWP.  
 RICHLAND COUNTY, OHIO

Chawford, Murphy & Tilly Consulting Engineers Springfield, Illinois	SCALE 1" = 50'	TOS NO. 6415-10
---	-------------------	--------------------