

# Assessment of Lots in the Town of Shiloh

*Shiloh*

LOT

SCALE: Forty Feet to an Inch or Ten Feet to One-Quarter Inch.

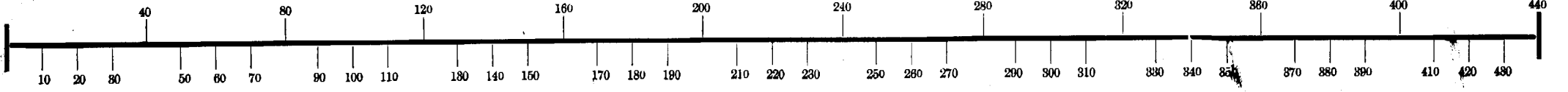

PART OF WEST ADDITION BY PETTIT TO SHILOH &  
PART OF THE ORIGINAL

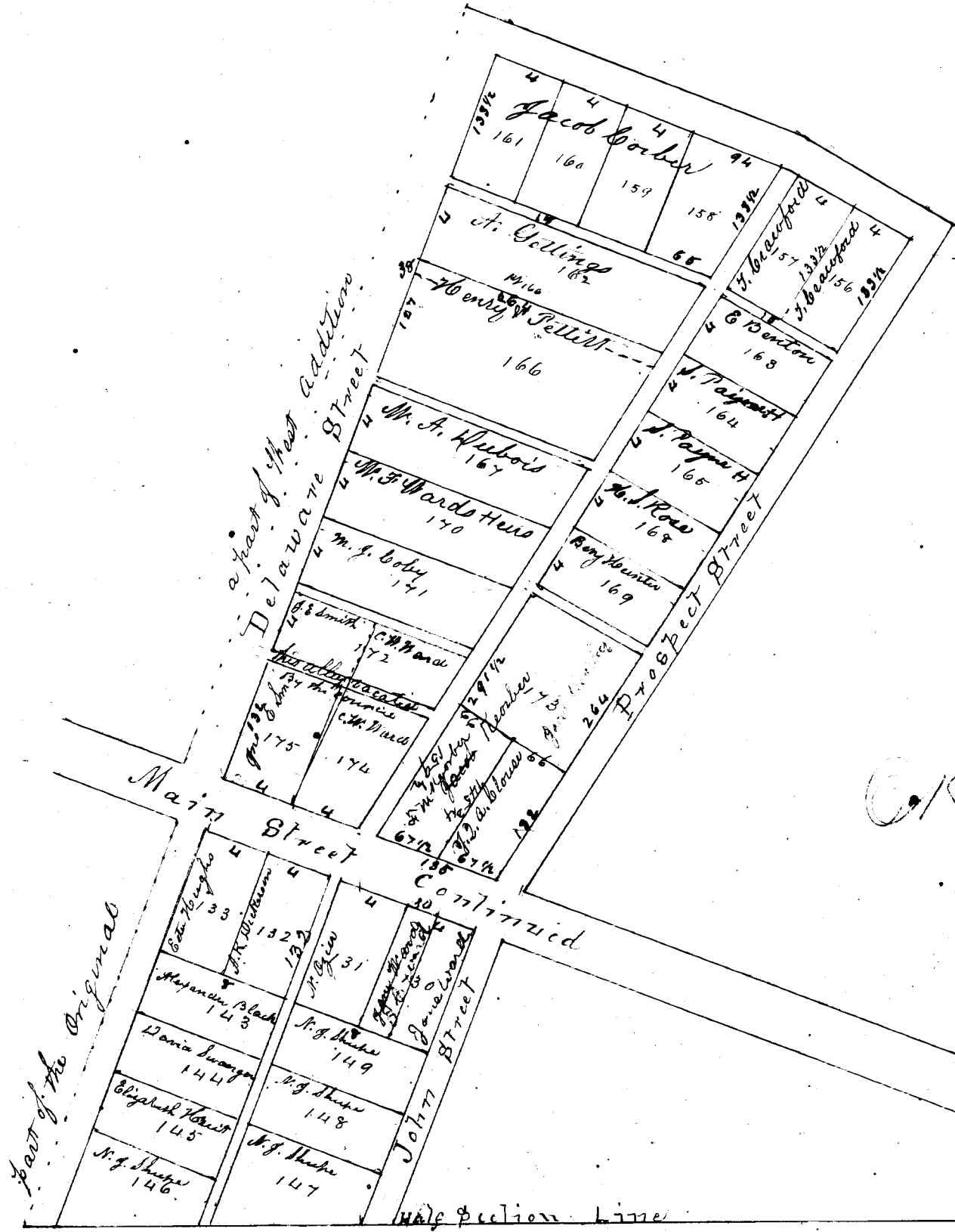
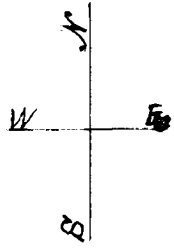

*Grant Henry*

*will let the same*

*OK*