

IN WHOSE NAME ASSESSED.

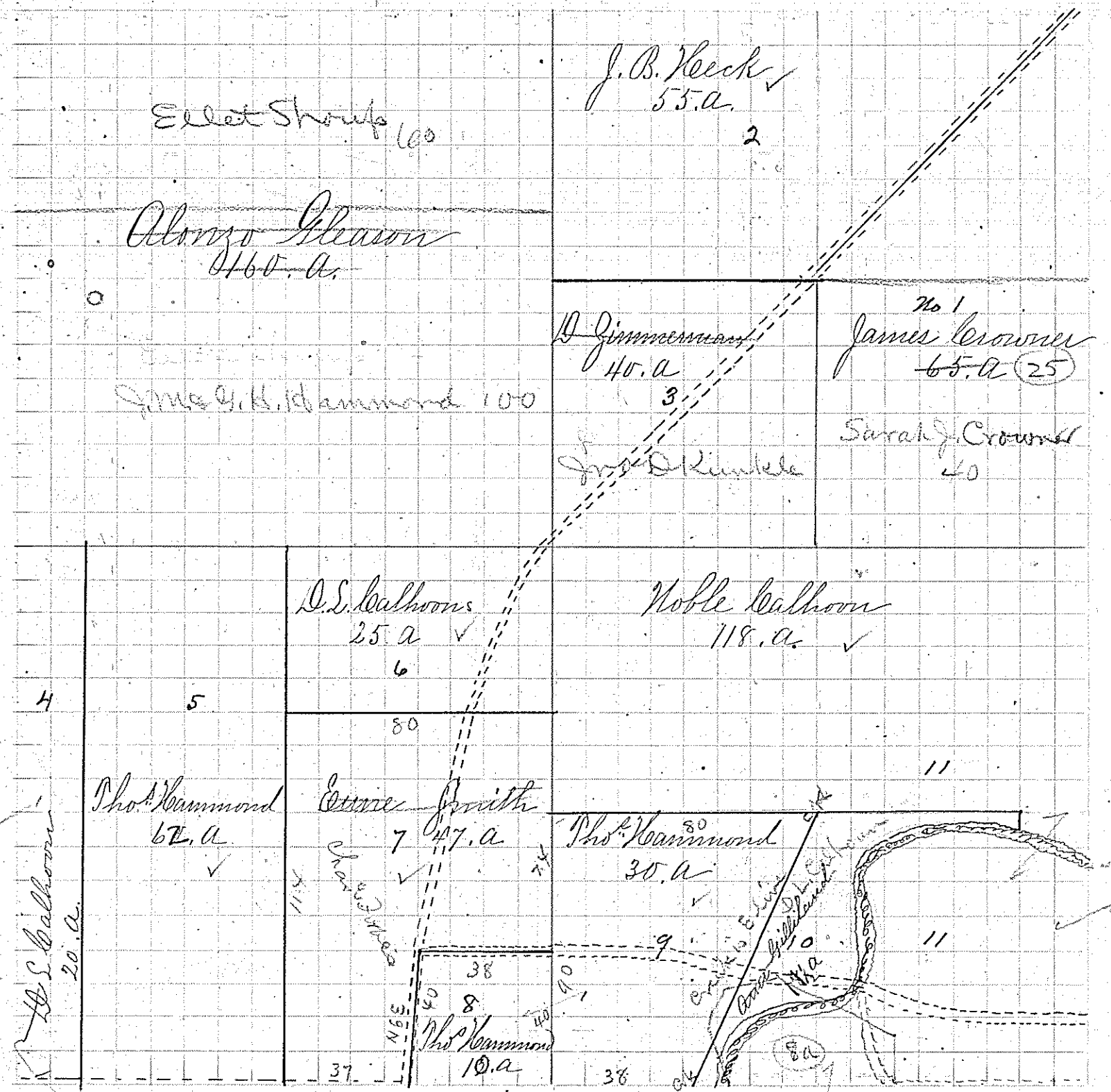

- Balhoun D. S.*
- Same*
- Balhoun Noble*
- Crowder James*
- Gleason Alongo*
- Hilliland Ann*
- Hammond Tho.*
- Same*
- Same*
- Keck J. B.*
- Smith Eun*
- Zimmerman D.*

*Section No. 10*

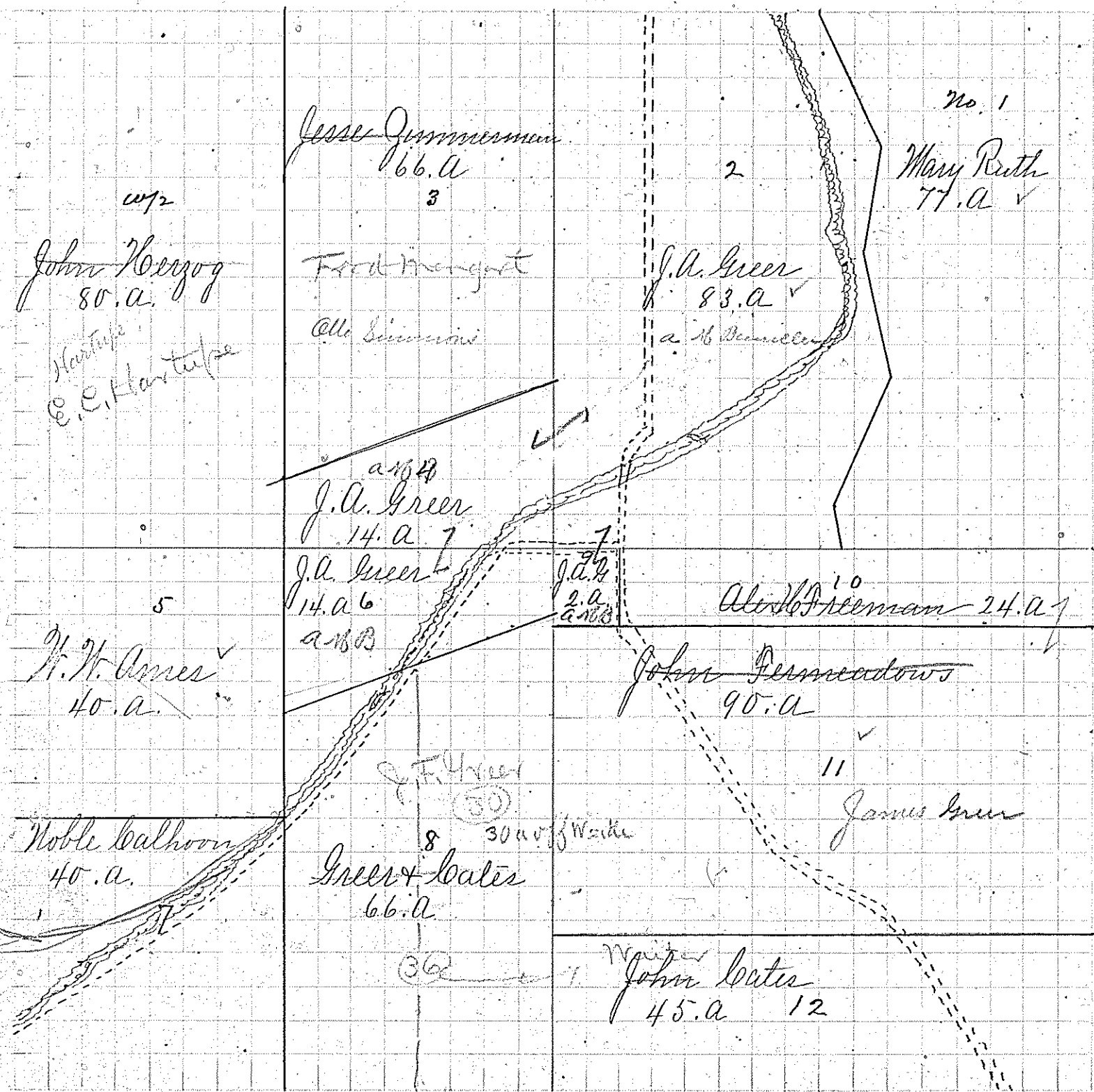

- Agnes W. W.*
- Bates John*
- Balhoun Noble*
- Freeman Alex. H.*
- Permadows John*
- Greer and Bates*
- Greer James A*
- Same*
- Same*
- Same*
- Herzog John*
- Ruth Mary*
- Zimmerman Jesse*