

Section No. 8

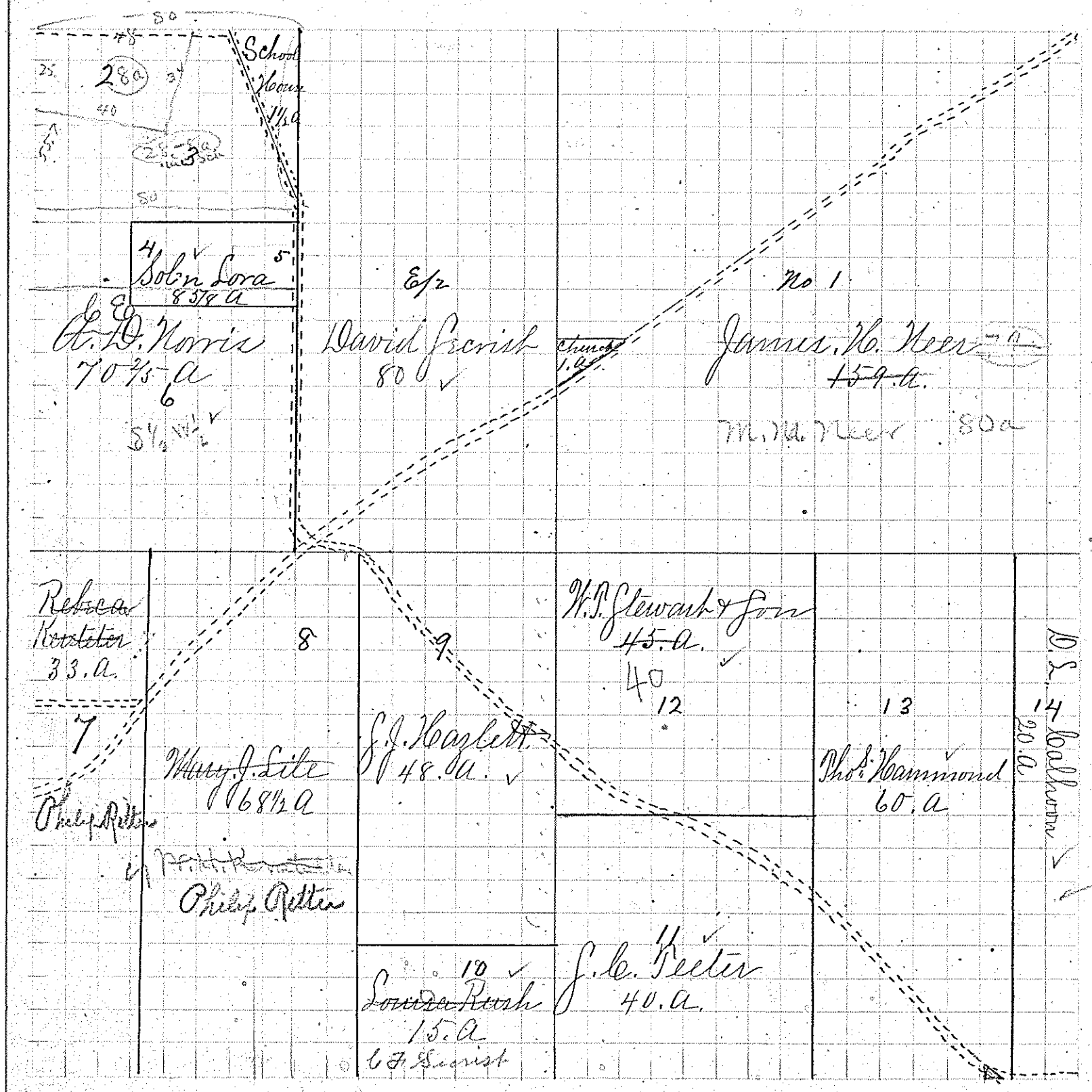

IN WHOSE NAME ASSESSED.

- Kanaga J. H.
- Lafferty Uriah
- Scooper Sarah M.
- McBride Susan
- McBride Sarah A.
- Scovill Henry J.
- Scovill Jacob
- Snyder Daniel
- Swihart George
- Peter Philip
- Peter John
- Hard Charles
- Calhorn D. S.
- Hammond Thos.
- Hazlett J. J.
- Kersteter Rebecca
- Lisle Mary J.
- Lora Soloman
- Neer James W.
- Norris Ann W. D.
- Rush Louisa
- Stewart W. B. & Son
- Scovill David
- Peter Samuel L.