

For Covenants & Restrictions see ORV 511 P 510

Vol. 26 page 187

SEE N.W. QRT. SEC 27

ROLLING MEADOWS ESTATES

PART OF THE NW. 1/4 OF SEC. 27, T-20, R-19, TROY TWP. RICHLAND CO., OHIO

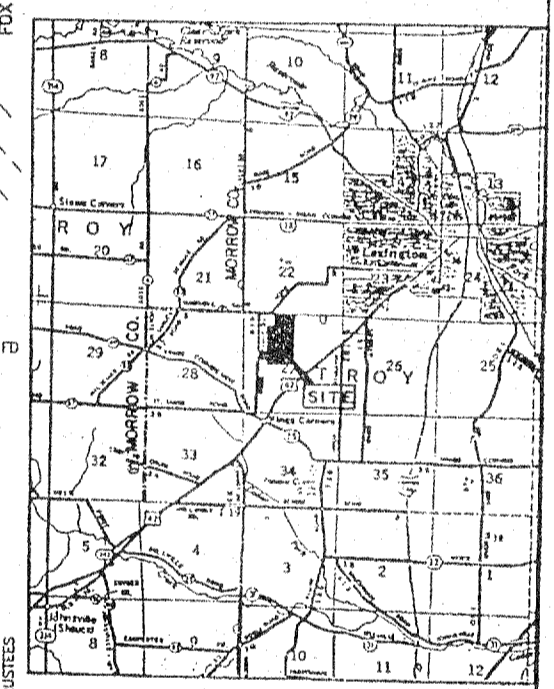
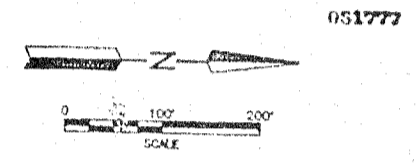

VICINITY MAP

Richland Co. 3-8-97

- LEGEND
- ▽ P.K. NAIL FOUND
  - RAILROAD SPIKE FOUND
  - IRON PIN FOUND
  - RAILROAD SPIKE SET
  - IRON PIN SET - 5/8" DIA. ROD WITH PLASTIC CAP - STAMPED S.J.L. INC.

85.699 AC. TOTAL  
37 LOTS (2.111 AC. AVERAGE)  
7.603 ACRES ROADS

ZONING: "A-1"  
WATER SUPPLY: WELLS  
SEWAGE DISPOSAL: SEPTIC TANKS  
PUBLIC ROADS

SHEET 1 OF 2  
SM-1260  
SHAW, ROBERT, JOHNSTON, LICHTENWALTER & ASSOCIATES, INC.  
CONSULTING ENGINEERS - SURVEYORS

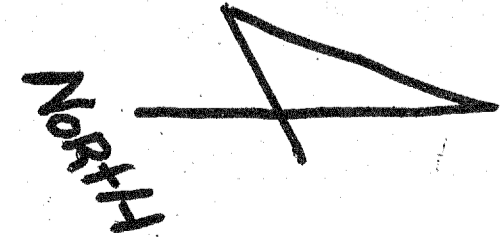

May 47

2-10-96  
ORV. 1613 P. 583

