

L.D. Porter

BEAM C.H. 51

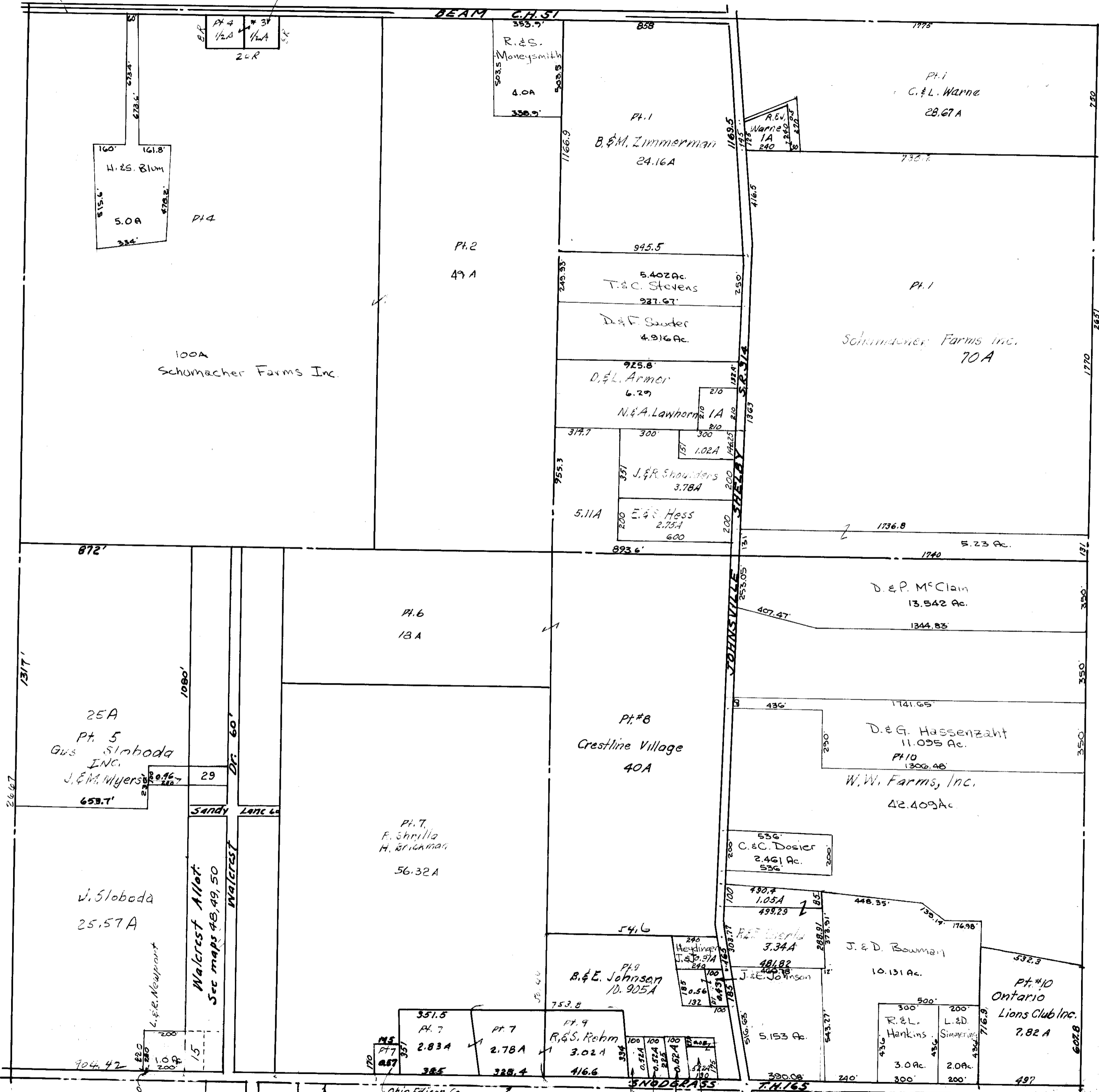

Twp. 21-R. 19

SPRINGFIELD TWP. SEC. 8

Sect. Line

SANDY LANE

T.H. 165

AS.T.  
SANDY LANE  
WALCREST  
MAYSON  
WALCREST  
E.S.P.  
WALCREST  
M.H.F.  
STRAUB

Ohio Edison Co.

634.42

704.42

25.57A

25A  
Pt. 5  
Gus Sloboda  
INC.  
J. & M. Myers

Pt. 7  
351.5  
2.83A  
38.5

Pt. 7  
2.78A  
328.4

Pt. 9  
R. & S. Rehm  
3.02A  
416.6

Pt. 9  
R. & E. Johnson  
10.905A

R. & L. Hankins  
3.0 Ac.

L. & D. Simmering  
2.0 Ac.

Pt. #10  
Ontario  
Lions Club Inc.  
2.82 A

D. & G. Hassenzant  
11.095 Ac.  
Pt. 10  
1300.48  
W. W. Farms, Inc.  
42.409 Ac.

Pt. #8  
Crestline Village  
40A

D. & P. McClain  
13.542 Ac.  
1344.83

Pt. 6  
18A

5.11A  
E. & S. Hess  
2.75-A  
600

J. & R. Shoulders  
3.78A

N. & A. Lawhorn  
1A

D. & L. Armer  
6.29

D. & F. Sander  
4.916 Ac.

T. & C. Stevens  
5.402 Ac.  
927.67

Schumacher Farms Inc.  
70A

Pt. 1  
B. & M. Zimmerman  
24.16A

Pt. 1  
C. & L. Warner  
28.67A

100A  
Schumacher Farms Inc.

H. & S. Blum  
5.0A

R. & S. Moneysmith  
4.0A

Pt. 4  
1/2A  
24R

R. E. Warner  
1A  
240