

Section No. 23. T²19. R¹⁹

SCALE: Forty ^{Feet} to an Inch or Ten Feet to One-Quarter Inch.

Assessment of Real

IN WHOSE NAME ASSESSED.

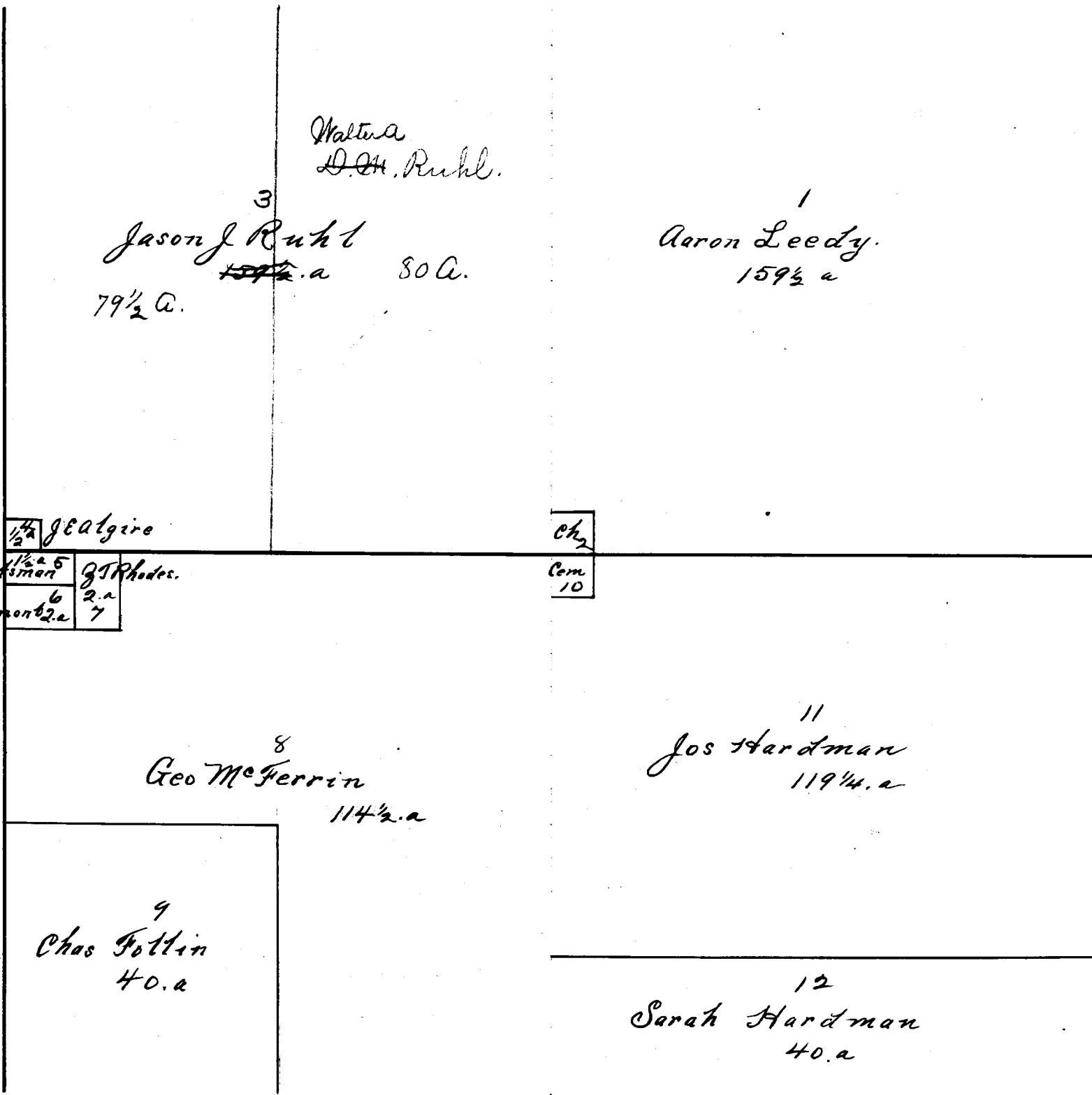

Allgire, J. E.
 Bermont, M. E.
 Huntsman, A.
 Hardman, Jos.
 Hardman, Sarah.
 Leedy, Aaron.
 Mc Ferrin, Geo.
 Rhodes, J. T.
 Ruhl, Jason J.
 Follin, Chas.

Section 24.

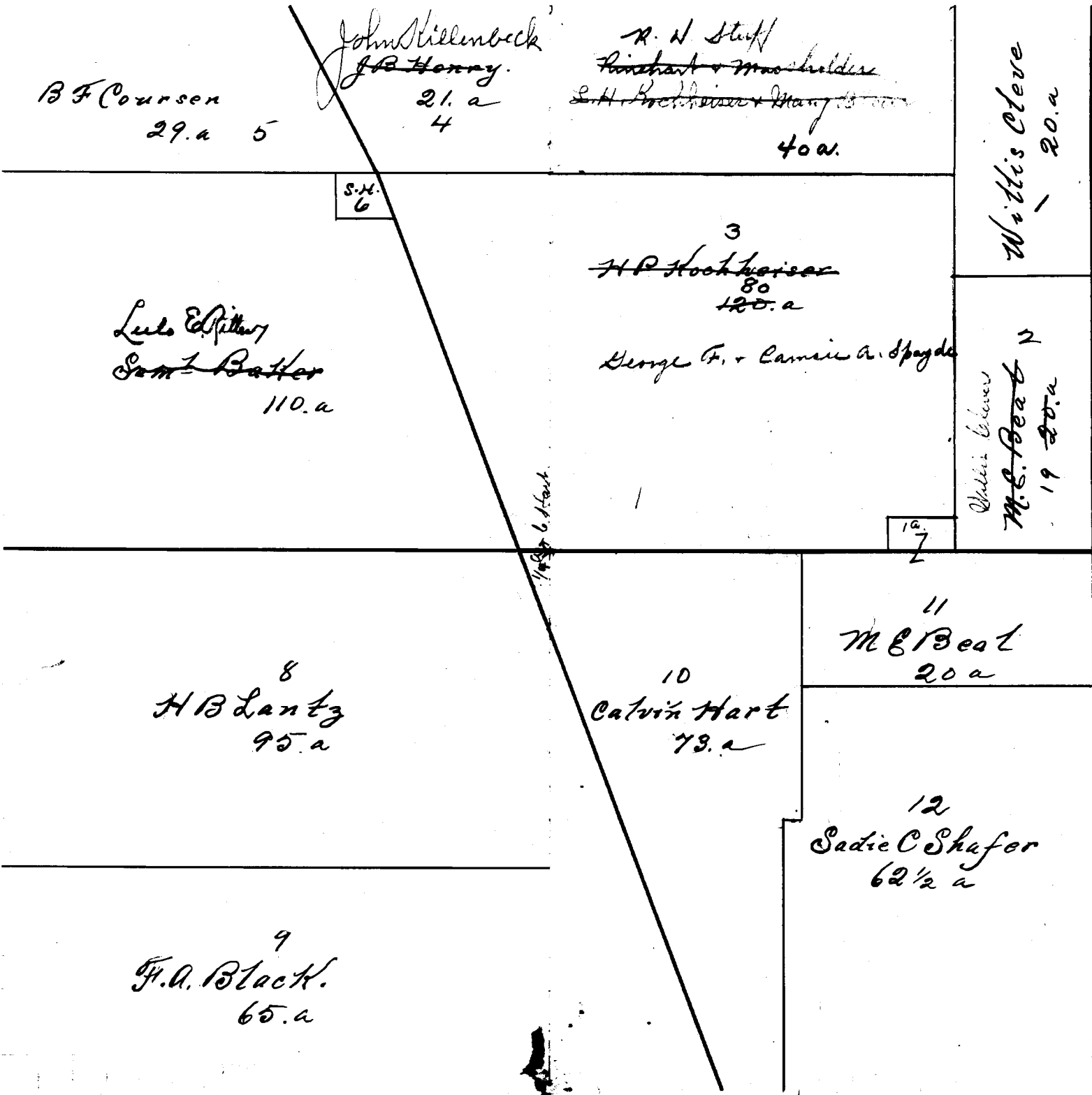

Baker, Saml
 Black, F. A.
 Beal, M. E.
 Beal, M. E.
 Clever, Willis.
 Coursen, B. F.
 Hart, Calvin.
 Henry, J. B.
 Kochhiser, H. P.
 Lantz, H. B.
 Shafer, Sadie, C.