

PARK AVE. WEST

N 85° 16' W

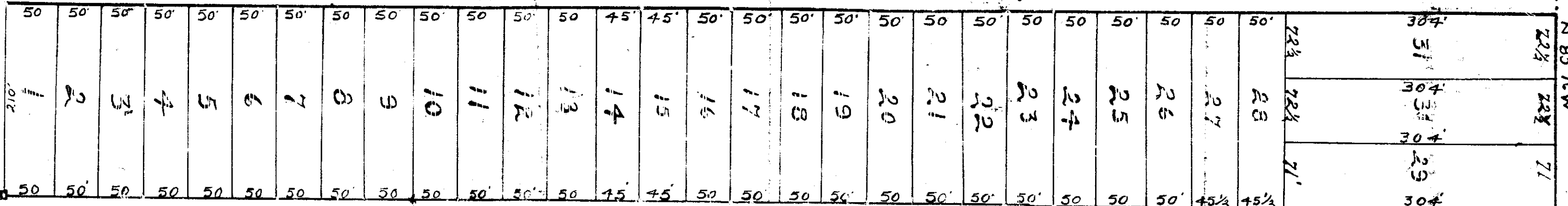

PUBLIC HIGHWAY S. 3° W

### M.C. GATES ALLOTMENT

OF PART OF THE S.E. 1/4 OF SEC. 19 T.P. 21. R. 18

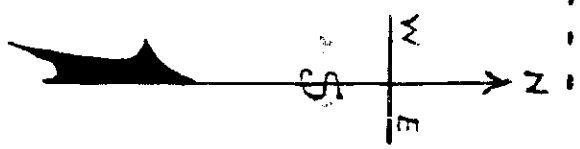

I hereby Certify that the above  
 Plat and notes are correct.  
 J.T. Fairchild, C.E.  
 RESTAKED BY J.T.F.