

2

658.576 E SH #30
E Madison Road 50'

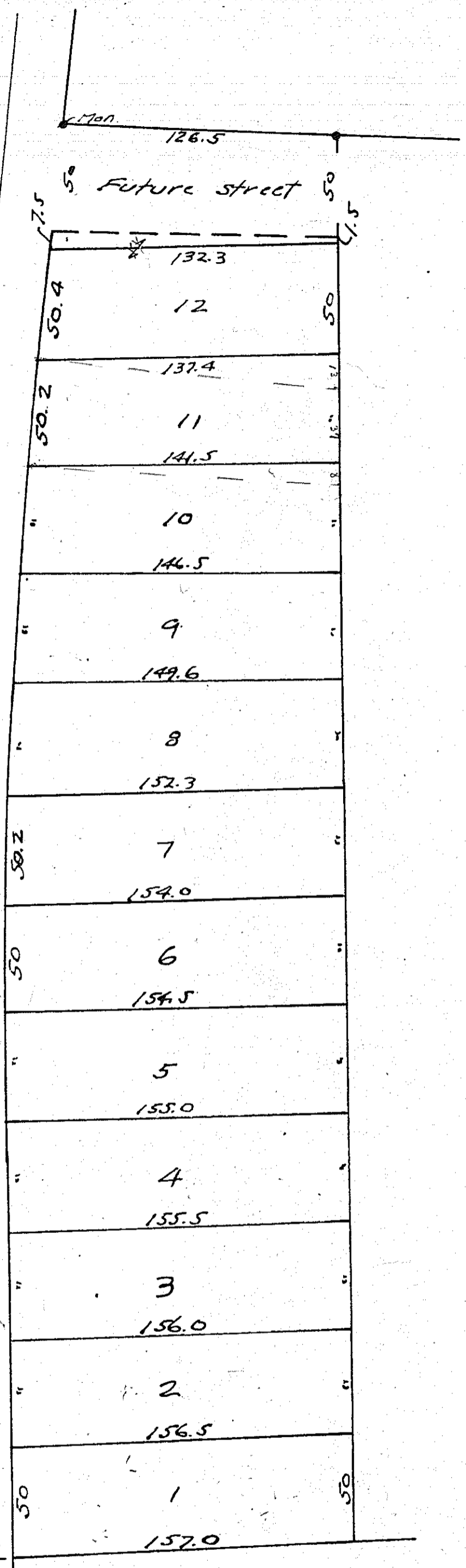

170.0 126.5

50 Future street 50

132.3

137.4

141.5

146.5

149.6

152.3

154.0

154.5

155.0

155.5

156.0

156.5

157.0



John Barth Jr. Addition
 SW 1/4, Sec. 23, Twp. 21, R. 18, Madison Twp.
 Sec Plat Book 16 Page 32