

IN WHOSE NAME PROPERTY ASSESSED

Browneller Jno.  
 " Sam  
 Burchard J  
 Kendal Rich  
 Moore Robert  
 Ritchie + Mosey  
 Roush Jacob  
 Shade Jer.  
 Taylor, D.  
 Trustees of G. B. Church

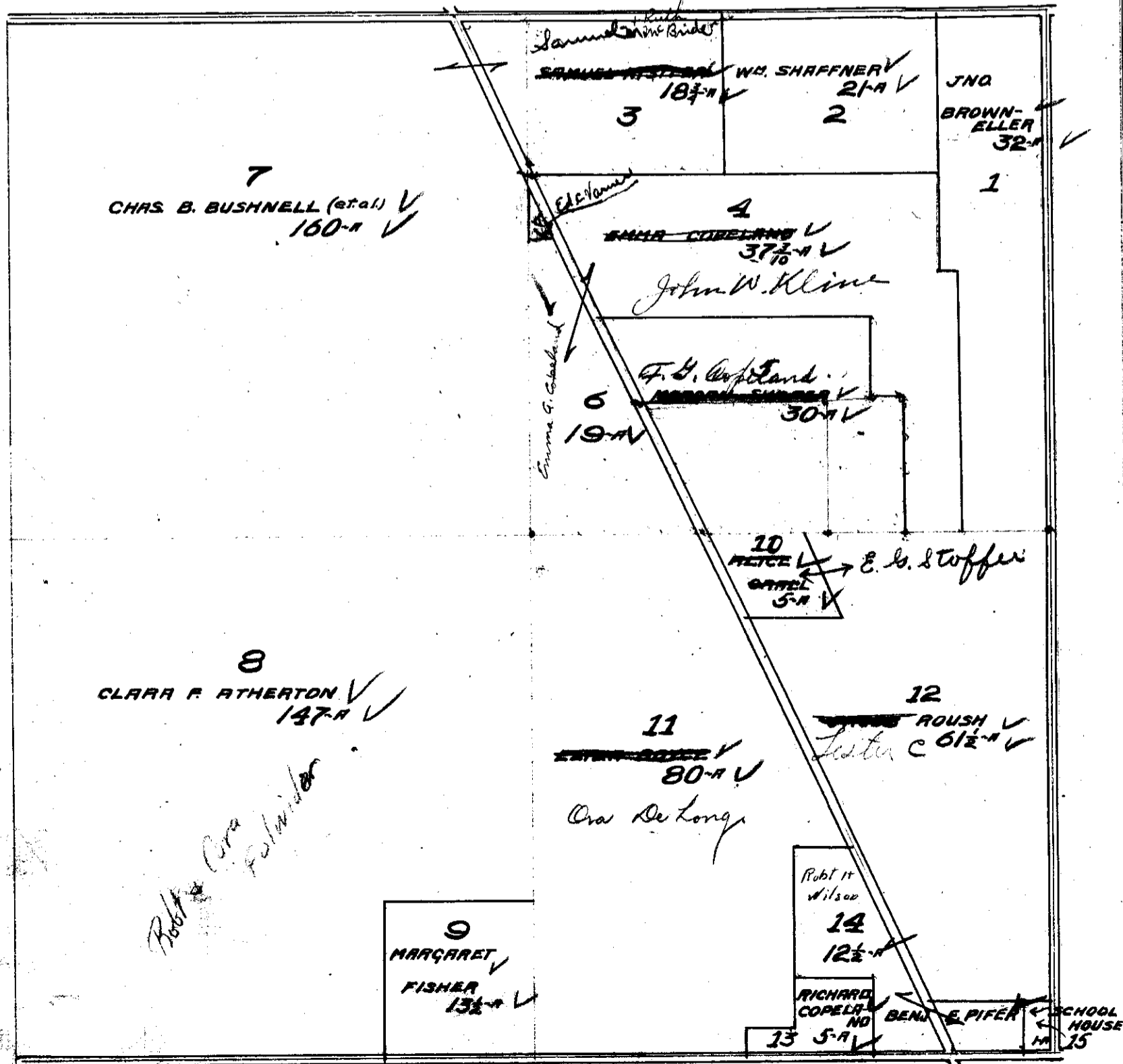

Atherton Clara  
 Brushnell Chas.  
 Boyce Eliza  
 Browneller Jno.  
 Copeland Rich  
 " Emma  
 " " Alice  
 Fisher Margaret  
 Kistler Sam  
 Pifer Ben  
 Roush Jacob  
 Shaffner Wm.  
 Shaver Morgan