

Section No. 19 Tp 22R18

SCALE: Forty Feet to an Inch or Ten Feet to One-Quarter Inch.

Assessment of Real Estate

IN WHOSE NAME ASSESSED

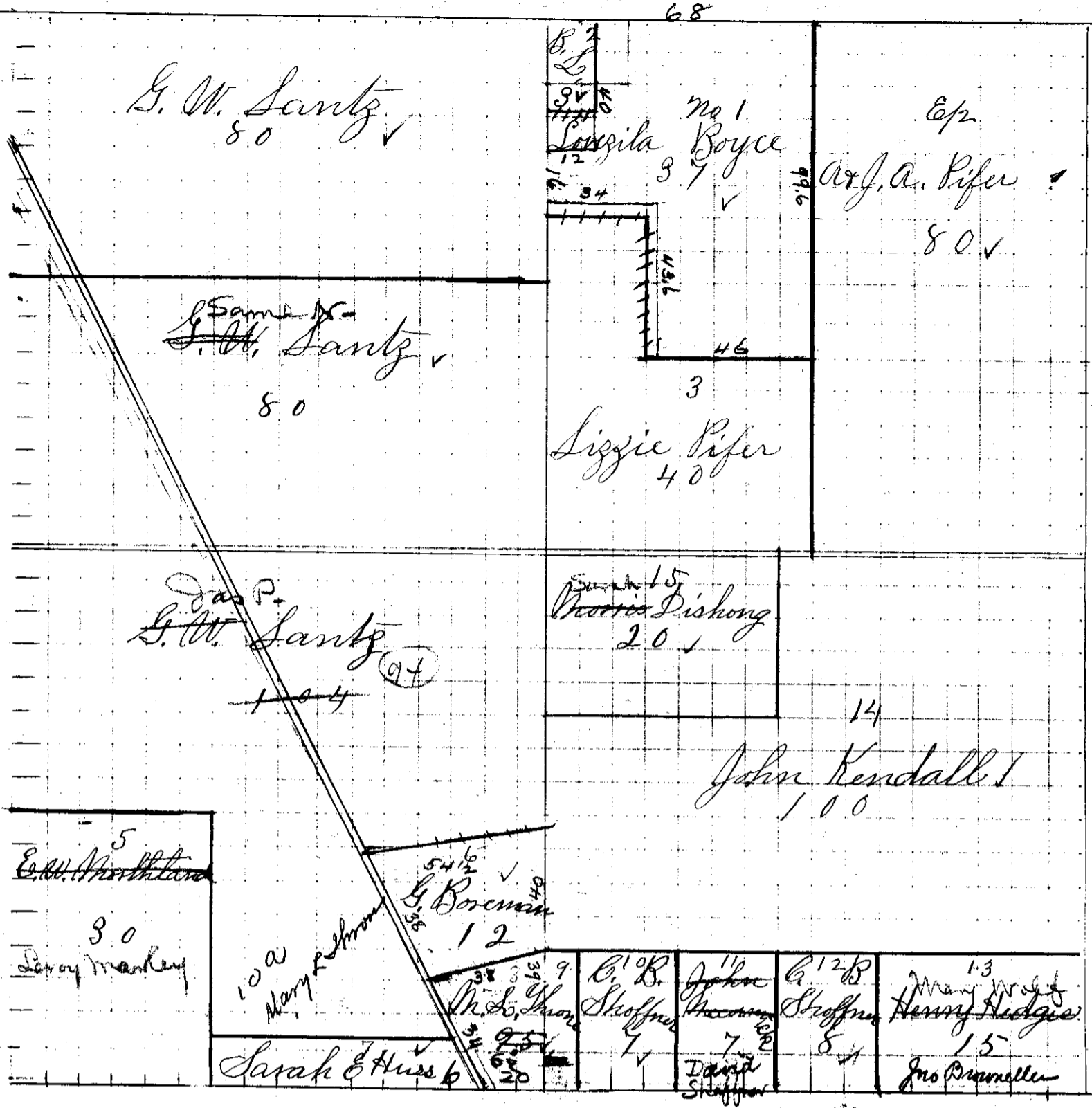

- Boyce Louzila
- Boreman George
- Dishong Morris
- Hedges Henry
- Huss Sarah E.
- Santz G.W.
- " " "
- " " "
- Lehman Benj.
- Kendall John
- Northland E. W.
- McCormick Jos
- Rifer A. J. A.
- " Lizzie
- Shoffner C. B.
- " " "
- Throne Mary
- " " "

Section 20 Tp 22R18

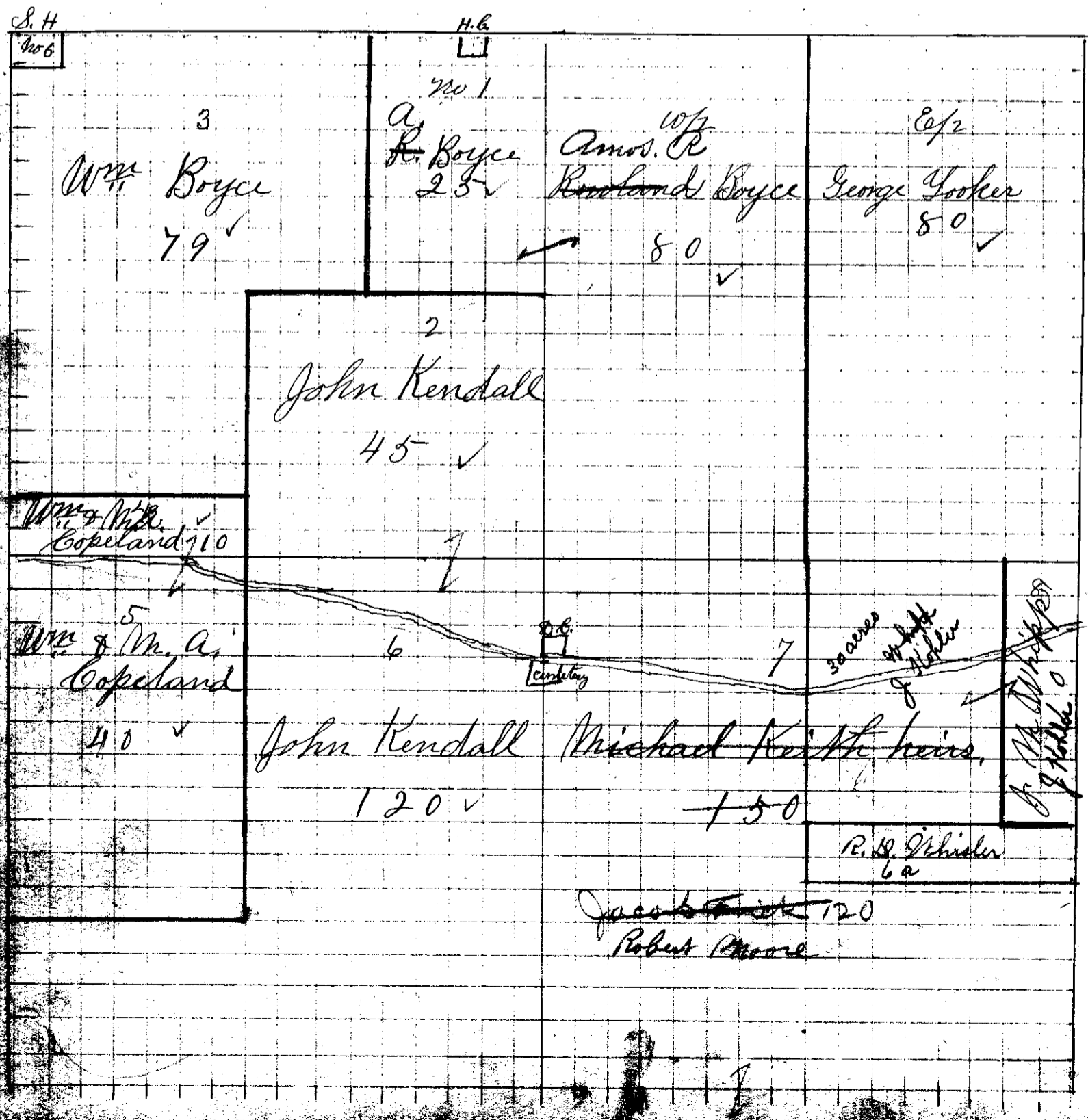

- Boyce Rowland
- " "
- " Wm
- Copeland Wm
- " "
- Kendall John
- " "
- Keith Michael
- Looker George
- Whipp J. M.