

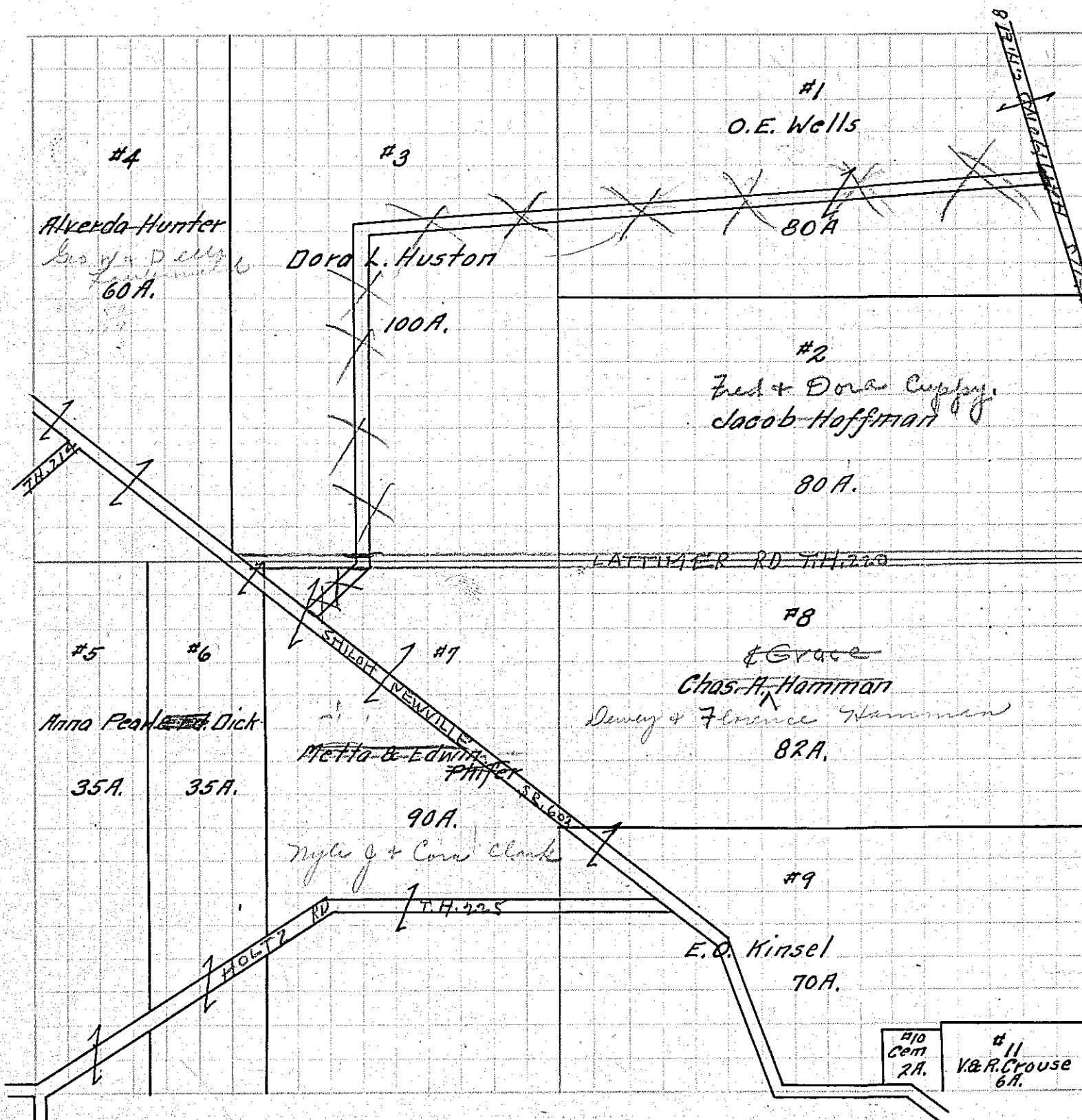

IN WHOSE NAME PROPERTY ASSESSED

- ✓ Lautermilch, Geo. W. + Della 2nd
- ✓ Hunter, Alverda
- ✓ Chen, Verda
- ✓ Willett, Peter L. Beatty Chester
- ✓ Arnold, Joe
- ✓ Baker, Mary Dell
- ✓ Sibbett, Llewallyn B.
- ✓ Daup, Edward F.
- ✓ Dick, Edward + Anna Pearl
- ✓ McDowell, Frank
- ✓ McDowell, Frank
- ✓ Brown, Jeanette F. Frazee ^{Blanche} Geo. A. +
- ✓ Dick, Anna P. + Edward



- ✓ Wells, O. E.
- ✓ Cuppy, Fred + Dora
- ✓ Hoffman, Jacob
- ✓ Huston, Dora L.
- ✓ Lautermilch, Geo. W. + Della
- ✓ Hunter, Alverda
- ✓ Dick, Anna Pearl + Ed.
- ✓ Dick, Ed. + Anna Pearl
- ✓ Clark, Meta + Edw. + Cora E.
- ✓ Hamman, Dewey + Florence
- ✓ Hamman, Chas. A. + Grace
- ✓ Kinsel, E. O.
- ✓ Crouse, Vaughn + Rosa E.