

IN WHOSE NAME PROPERTY ASSESSED

*Melissa Maggie & Ch. H.*  
*same*  
*Latimer Norris J.*  
*Starky Jas. & A.*  
*" of Jas.*  
*Gilger Joseph*  
*Hammon C. D.*  
*Sloan Clarissa A.*  
*" Jas. R.*  
*Grabill Samuel*

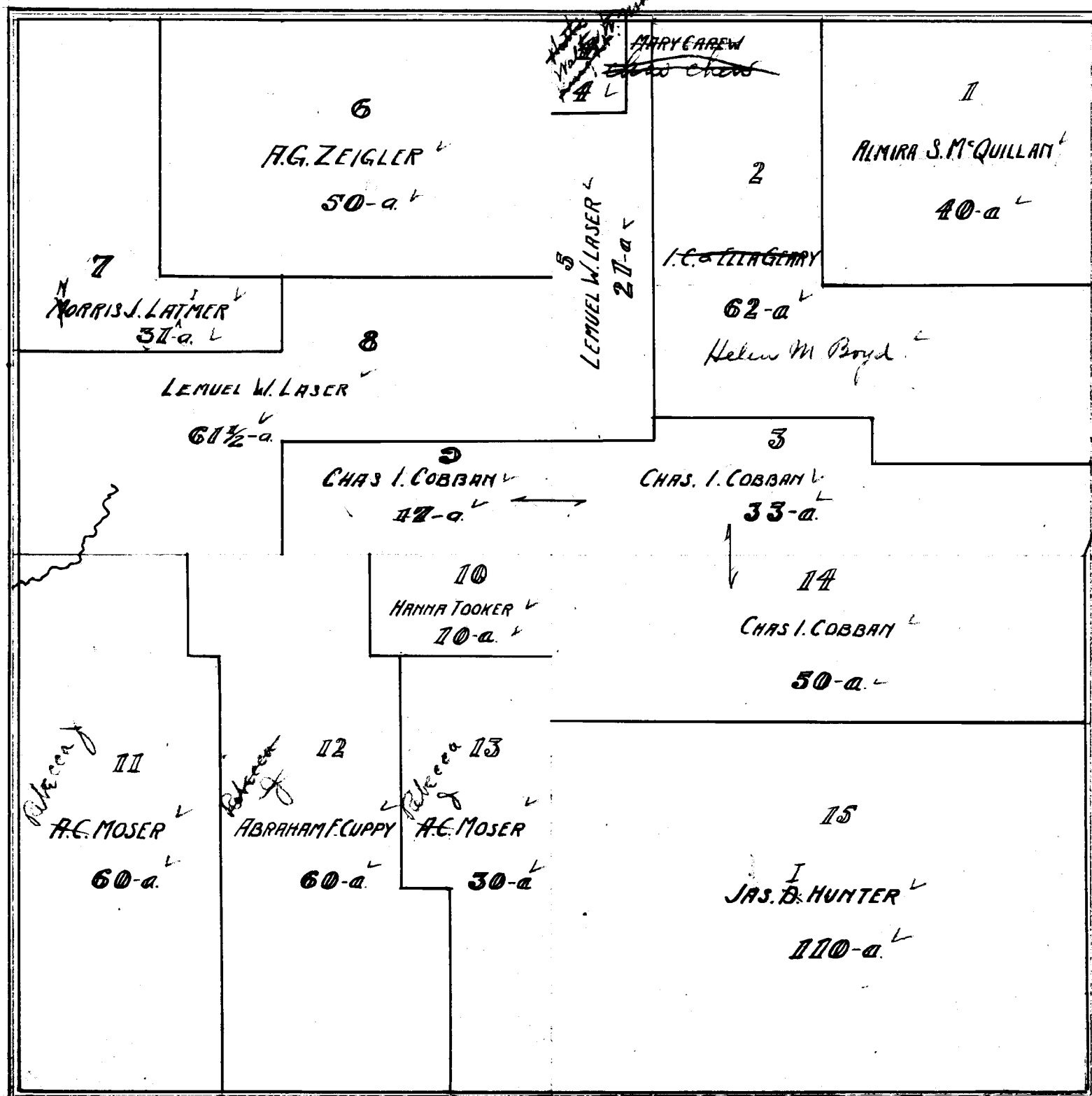

*McQuillan Almira S.*  
*Geary J. C. & Ella*  
*Cobban Chas. I.*  
*Carew Mary*  
*Laser Lemuel W.*  
*Zeigler A. G.*  
*Latimer Norris J.*  
*Laser Lemuel W.*  
*Cobban Chas. I.*  
*same*  
*Tooker Hannah*  
*Moser A. C.*  
*same*  
*Cuppy Abraham F.*  
*Hunter Jas. B.*